

MULTIMODAL ACCESS CLOSURE EXCEPTION APPLICATION FORM AND CHECKLIST

Submittal Date: 7/3/2024 New Submittal Re-Submittal No: _____

Related Building Permit No: 2022067923

Project Name: EQ East Townhomes

Street Name Location: 201 North 11th St.

Between: 201 North 11th St. And: 1103 Forest Ave.

Applicant Name: Glyn Baggett

Address: 256 Seaboard Ln. Suite G102 Franklin, TN 37067

Phone: 615-337-8370 Fax: NA Contact: NA

Email: glyn@rionwells.com

Project Description: 6 Unit Townhouse New Construction

Start Date: 8/7/2023 End Date: 9/13/2024 Project Length: 403 days

Describe Type of Closure: Sidewalk closure to install sewer and water service to the building from the main lines on Forest Ave.

Provide Reasons why Project cannot be completed without closures and what other options were considered (attach documents as needed): Due to this project having 6 individual sewer and water lines exiting the Forest Ave. side of each unit and with the amount of solid rock that is under the entire property, street and sidewalk, hammering rock and digging without significantly damaging the sidewalk is not possible.

PROJECT INFORMATION CHECKLIST:

Included Not Applicable

- Project Vicinity Map with Project Area shown, street names, property information, existing pavement and striping, gutter and building locations, north arrow, and scale.
- Planned work hours included.
- Exact location and dimensions of the construction work zone shown.
- If multiple phases are necessary, include perimeter impact of each phase, phase number, anticipated work hours and phase duration.
- Details on construction activity and equipment being used as part of construction included for each phase.
- Specify if any on-street parking, and/or metered parking, is to be restricted and if bus zone will need to be relocated.
- Specify if trash pickup will be impacted.
- Provide information on all utility work and utility connections.
- List all affected residents, businesses, agencies, and schools and any conversations/agreements taken place.
- Show ongoing construction projects within vicinity of proposed project impact.
- Provide plan to address conflicts with other nearby projects.
- Provide traffic control plan for each phase of construction (see traffic control checklist for more information).
- Provide information on work vehicle parking locations.
- Show construction trucks ingress/egress to project location.
- Provide information on any traffic signals, traffic signal loops, and traffic signal cabinets in close proximity to project.

TRAFFIC CONTROL PLAN CHECKLIST:

Included Not Applicable

- | | | |
|-------------------------------------|-------------------------------------|---|
| <input checked="" type="checkbox"/> | <input type="checkbox"/> | All temporary traffic control plans shall be designed in accordance with the most recent ADA regulations and requirements of the Manual of Uniform Traffic Control Devices. |
| <input checked="" type="checkbox"/> | <input type="checkbox"/> | Clearly show the locations of all existing signs (including speed limit) as well as the proposed signs for each construction phase. |
| <input checked="" type="checkbox"/> | <input type="checkbox"/> | Show the location of all existing pedestrian paths and pedestrian detour route of each stage of construction. |
| <input checked="" type="checkbox"/> | <input type="checkbox"/> | Show dimensions of travel lane width, shoulder width, sidewalk of each phase, and overall roadway width along the length of affected area. |
| <input type="checkbox"/> | <input checked="" type="checkbox"/> | Show all existing striping and markings to remain, to be removed, and all proposed striping and markings for each construction stage. |
| <input checked="" type="checkbox"/> | <input type="checkbox"/> | Provide detour plan clearly showing detour route for any roadway or pedestrian/bike path closures. |
| <input checked="" type="checkbox"/> | <input type="checkbox"/> | Specify placement of all temporary traffic control devices. |
| <input checked="" type="checkbox"/> | <input type="checkbox"/> | Specify spacing of all temporary traffic control devices. |
| <input checked="" type="checkbox"/> | <input type="checkbox"/> | Show all existing traffic signals and streetlights in the work zone location. |
| <input type="checkbox"/> | <input checked="" type="checkbox"/> | Lighting provided for all pedestrian detour routes. |
| <input checked="" type="checkbox"/> | <input type="checkbox"/> | Provide minimum eleven (11) foot travel lanes at all times. |
| <input type="checkbox"/> | <input checked="" type="checkbox"/> | Show size, height, and location of all channelizing devices, warning lights, flag trees, barriers, etc. |
| <input type="checkbox"/> | <input checked="" type="checkbox"/> | Label all taper lengths and widths. |
| <input type="checkbox"/> | <input checked="" type="checkbox"/> | Provide locations of police officers for each phase as needed. |
| <input type="checkbox"/> | <input checked="" type="checkbox"/> | Temporary Traffic Control Plan has been stamped and signed by a TN licensed Civil Engineer. |

TRAFFIC CONTROL PLANS

N 11TH STREET AND FOREST AVENUE

ROAD CLOSURE (PHASE 2), LANE CLOSURE (PHASE 1-3), AND SIDEWALK CLOSURE (PHASE 3)

INDEX OF SHEETS CONSTRUCTION

SHEET NO.	DESCRIPTION
1	TITLE SHEET
2	PHASE 1 TRAFFIC CONTROL PLAN
3	PHASE 1 TRAFFIC CONTROL PLAN PEDESTRIAN DETOUR MAP
4	PHASE 2 TRAFFIC CONTROL PLAN
5	PHASE 2 TRAFFIC CONTROL PLAN – VEHICLE DETOUR MAP
6	PHASE 2 TRAFFIC CONTROL PLAN PEDESTRIAN DETOUR MAP
7	PHASE 3 TRAFFIC CONTROL PLAN
8	PHASE 3 TRAFFIC CONTROL PLAN PEDESTRIAN DETOUR MAP
9	TRAFFIC CONTROL TYPICAL SECTIONS
10	TRAFFIC CONTROL NOTES AND ESTIMATED QUANTITIES

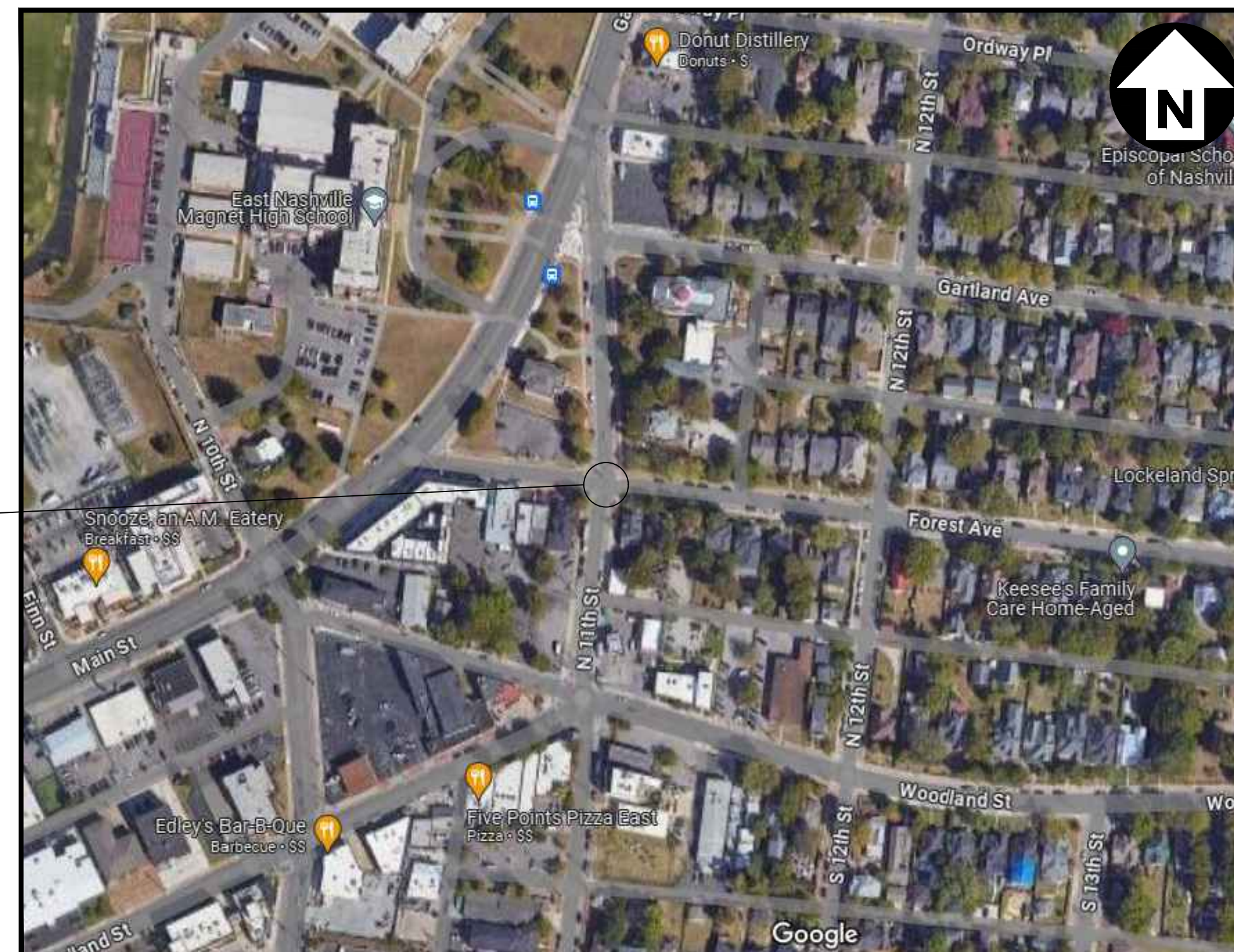
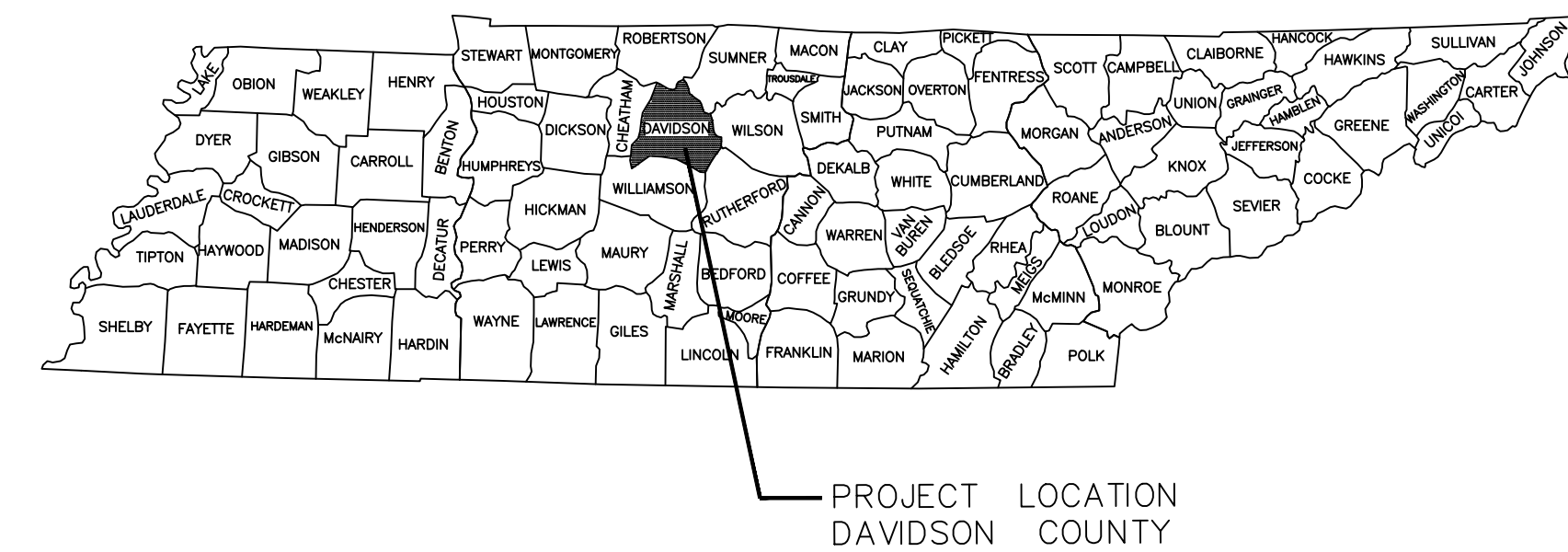

PROJECT
LOCATION

SPECIAL NOTE

THIS PROJECT TO BE CONSTRUCTED UNDER THE STANDARD SPECIFICATIONS OF THE TENNESSEE DEPARTMENT OF TRANSPORTATION DATED: JANUARY 1, 2021 AND ADDITIONAL SPECIFICATIONS AND SPECIAL PROVISIONS CONTAINED IN THE PLANS AND THE PROPOSAL CONTRACT.

SPECIAL NOTE:
THE DESIGN INFORMATION FOR ROADWAY AND UTILITIES PRESENTED ON THIS PLAN WERE PROVIDED TO KCI TECHNOLOGIES, INC. BY GRAYSTONE CONSTRUCTION TN. WHERE AVAILABLE, BASE INFORMATION HAS BEEN SUPPLEMENTED BY AERIAL IMAGERY AND FIELD OBSERVATIONS BY THE ENGINEER. KCI TECHNOLOGIES, INC. MAKES NO CLAIMS AS TO THE COMPLETENESS OR ACCURACY OF THE PROVIDED BASE INFORMATION.

DESIGNED BY KCI TECHNOLOGIES, INC.
DESIGNER MATTHEW A. THERIOT, PE
P.E. NO. 124090

T.D.O.T. STANDARD DRAWINGS

- T-S-10 STANDARD MOUNTING DETAILS FLAT SHEET SIGNS ALUMINUM-STEEL DESIGN
- T-S-16 GROUND MOUNTED ROADSIDE SIGN PLACEMENT DETAILS
- T-S-17 STANDARD GROUND MOUNTED SIGN USING PERFORATED/KNOCKOUT SQUARE TUBE
- T-S-18 END OF ROADWAY AND DEAD END SIGNS, METAL BARRICADES (TYPE III)
- T-S-19 STANDARD STEEL SIGN SUPPORTS
- T-S-20 SIGN DETAILS
- T-S-9 STANDARD LAYOUT GROUND MOUNTED SIGNS
- T-WZ-55 SIDEWALK TRAFFIC CONTROL
- T-WZ-PBR1 INTERCONNECTED PORTABLE BARRIER RAIL
- T-WZ-PBR2 DETAILS FOR WORK ZONE CHANNELIZATION DEVICES

LOCATION MAP

NOT TO SCALE

N 11TH STREET 30 MPH POSTED SPEED
FOREST AVENUE 25 MPH POSTED SPEED

FILE NO.	332401943
DATE:	05/23/24
DESIGNED BY:	MAT
DRAWN BY:	JMG
CHECKED BY:	JMC

REVISION BLOCK

DATE:		

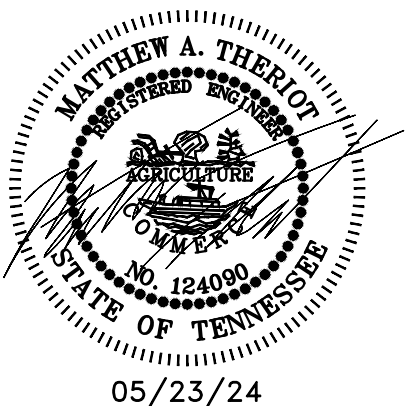

ALL CONSTRUCTION ACTIVITIES SHALL BE COMPLETED IN FULL COMPLIANCE WITH THE AMERICANS WITH DISABILITIES ACT (ADA) AND ARCHITECTURAL AND TRANSPORTATION BARRIERS COMPLIANCE BOARD, FEDERAL REGISTER 36 CFR PARTS 1190 AND 1191, ACCESSIBILITY GUIDELINES FOR BUILDINGS AND FACILITIES, ARCHITECTURAL BARRIERS ACT (ABA) ACCESSIBILITY GUIDELINES, PROPOSED RULE. PUBLISHED IN THE FEDERAL REGISTER ON JULY 23, 2004, AS HAS BEEN ADOPTED BY METRO.

ACCEPTED BY : _____

DATE : _____



TITLE
SHEET

N 11TH STREET AND FOREST AVENUE

N.T.S.

SHEET 1

FILE NO.	332401943
DATE:	05/23/24
DESIGNED BY:	MAT
DRAWN BY:	JMG
CHECKED BY:	JMC

REVISION BLOCK

DATE:		

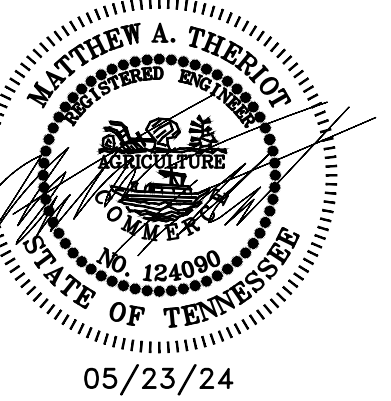

ALL CONSTRUCTION ACTIVITIES SHALL BE COMPLETED IN FULL COMPLIANCE WITH THE AMERICANS WITH DISABILITIES ACT (ADA) AND ARCHITECTURAL AND TRANSPORTATION BARRIERS COMPLIANCE BOARD, FEDERAL REGISTER 36 CFR PARTS 1190 AND 1191, ACCESSIBILITY GUIDELINES FOR BUILDINGS AND FACILITIES, ARCHITECTURAL BARRIERS ACT (ABA) ACCESSIBILITY GUIDELINES, PROPOSED RULE. PUBLISHED IN THE FEDERAL REGISTER ON JULY 23, 2004, AS HAS BEEN ADOPTED BY METRO.



PHASE 1 TRAFFIC CONTROL PLAN

N 11TH STREET AND FOREST AVENUE

SCALE: 1"=50'

SHEET 2



GENERAL NOTES:

1. PEDESTRIAN CROSSWALK TO REMAIN OPEN AT ALL TIMES CONSTRUCTION IS NOT ACTIVE AT THIS SPECIFIC LOCATION. CONTRACTOR SHOULD LIMIT THE DURATION OF THIS CROSSWALK CLOSURE WHEN POSSIBLE.
2. CONTRACTOR SHALL COORDINATE WITH LOCAL BUSINESSES AND MAINTAIN ACCESS AS NEEDED.
3. CONTRACTOR SHALL COORDINATE WITH METRO NASHVILLE TRASH SERVICES AND AVOID CLOSING ACCESS TO ALLEY WHEN PICKUP IS SCHEDULED.
4. CONTRACTOR IS RESPONSIBLE FOR SECURING THE WORK ZONE AND EXCAVATIONS FROM VEHICLES, PEDESTRIANS, AND CYCLISTS AT ALL TIMES.
5. QUALIFIED FLAGGERS TRAINED IN PROCEDURES DETAILED IN THE MANUAL ON UNIFORM TRAFFIC CONTROL DEVICES (MUTCD) SHALL BE STATIONED AT EACH END OF THE WORK ZONE TO CONTROL ALL VEHICULAR PEDESTRIAN, AND BICYCLE TRAFFIC. FLAGGERS SHALL CONTROL ALL TRAFFIC WITH A STOP (R1-1) AND SLOW (W20-8) PADDLE. FLAGGERS SHALL PROVIDE PRIORITY ACCESS FOR EMERGENCY VEHICLES.
6. TRAFFIC CONTROL PHASES SHALL NOT BE IMPLEMENTED SIMULTANEOUSLY. TRAFFIC CONTROL PHASES 1, 2, AND 3 SHALL ONLY BE IMPLEMENTED INDEPENDENTLY OF OTHER PHASES.
7. CONTRACTOR SHALL MAINTAIN EMERGENCY VEHICLE ACCESS AT ALL TIMES ON N 11TH STREET AND FOREST AVENUE.
8. CONTRACTOR SHALL PLATE ROADWAY FOR VEHICLE ACCESS DURING HOURS THAT CONSTRUCTION IS NOT ACTIVE. CONTRACTOR SHALL COORDINATE WITH NDOT AND LOCAL BUSINESSES TO COMPLETE CONSTRUCTION DURING HOURS WHICH MINIMIZE IMPACTS TO LOCAL BUSINESSES AND RESIDENTS.

LEGEND

	GROUND MOUNTED CONSTRUCTION SIGN W/ NUMBER (NEW)
	DIRECTION OF TRAVEL
	FLAGGER
	CONSTRUCTION WORK ZONE (NEW)
	INTERCONNECTED PORTABLE BARRIER RAIL (NEW)
	TEMPORARY BARRICADE W/ SIGN (TYPE III) (NEW)
	FLEXIBLE DRUMS

SPECIAL NOTE:
THE DESIGN INFORMATION FOR ROADWAY AND UTILITIES PRESENTED ON THIS PLAN WERE PROVIDED TO KCI TECHNOLOGIES, INC. BY GRAYSTONE CONSTRUCTION TN. WHERE AVAILABLE, BASE INFORMATION HAS BEEN SUPPLEMENTED BY AERIAL IMAGERY AND FIELD OBSERVATIONS BY THE ENGINEER. KCI TECHNOLOGIES, INC. MAKES NO CLAIMS AS TO THE COMPLETENESS OR ACCURACY OF THE PROVIDED BASE INFORMATION.

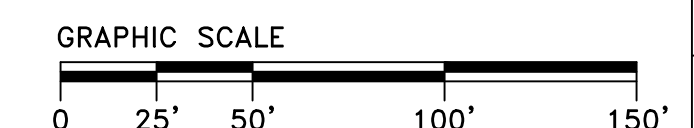
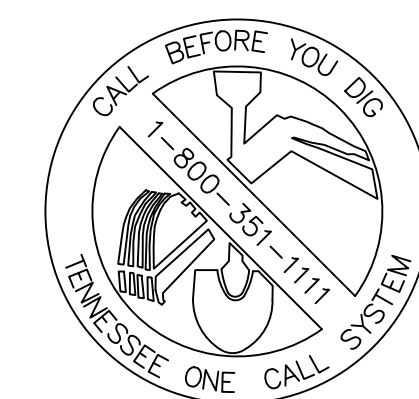
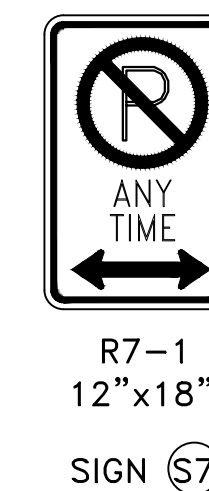
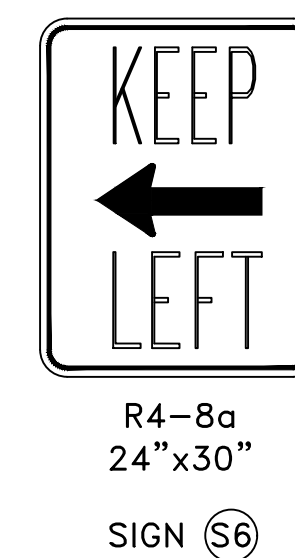
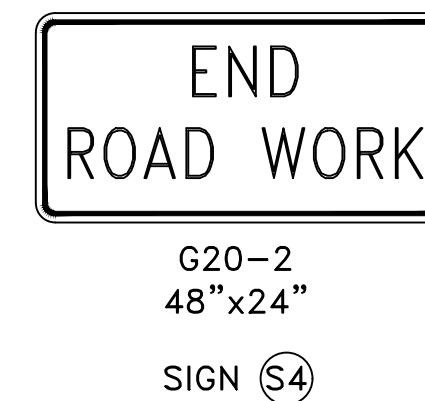
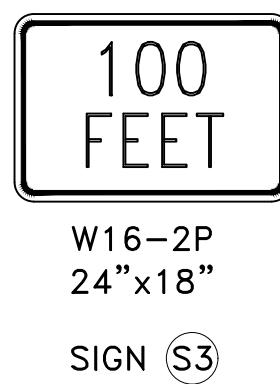
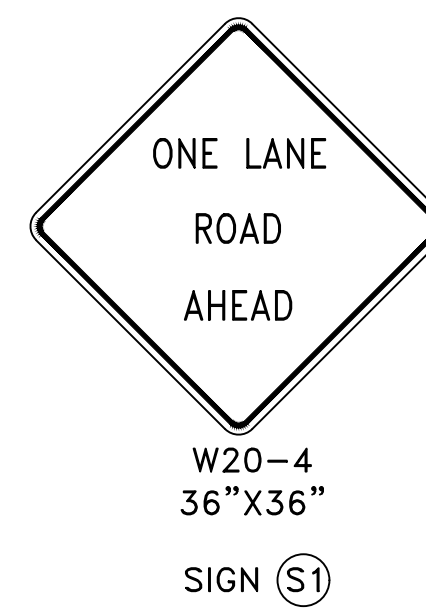

FILE NO.	332401943
DATE:	05/23/24
DESIGNED BY:	MAT
DRAWN BY:	JMG
CHECKED BY:	JMC

REVISION BLOCK	
DATE:	

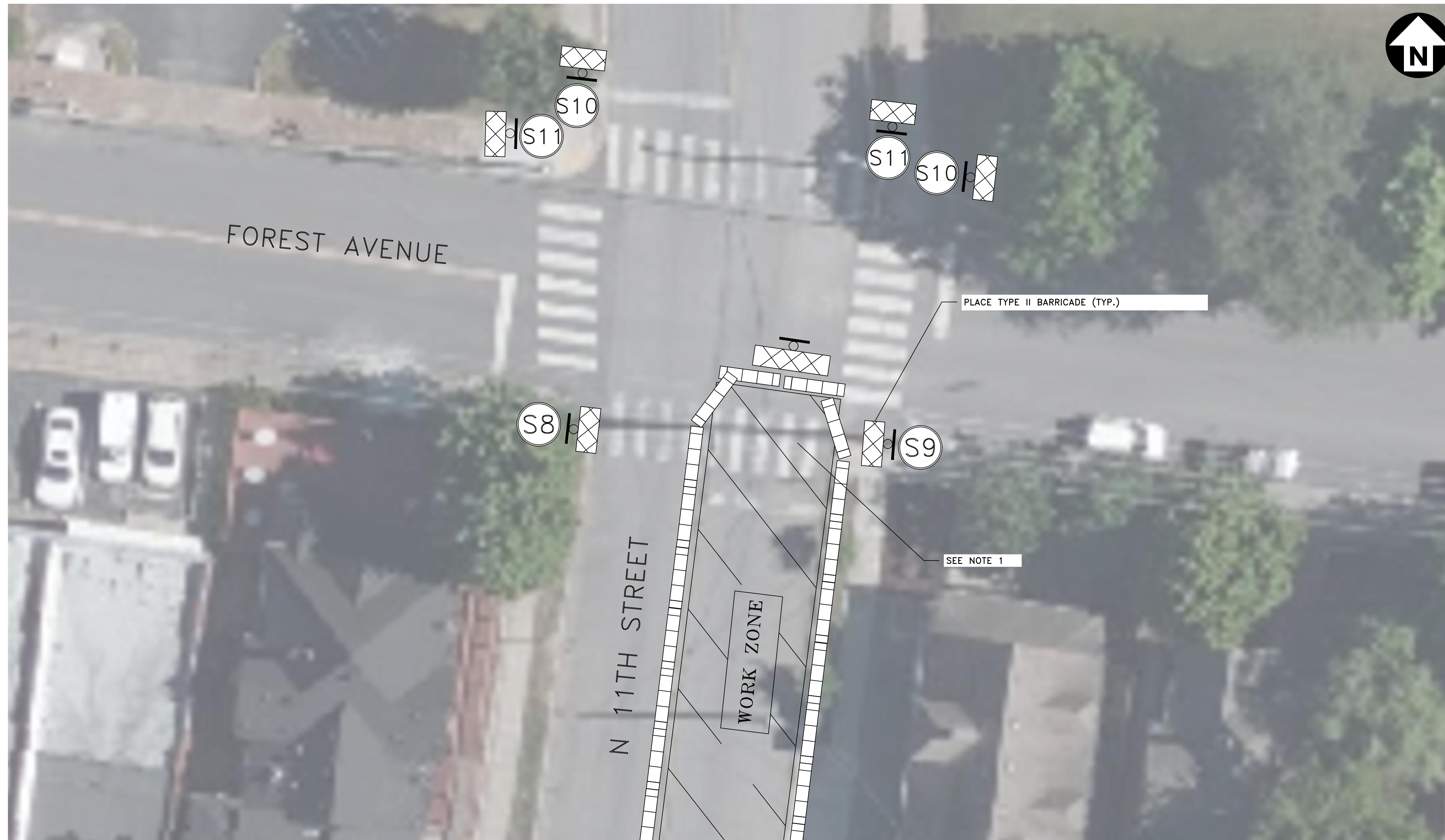

ALL CONSTRUCTION ACTIVITIES SHALL BE COMPLETED IN FULL COMPLIANCE WITH THE AMERICANS WITH DISABILITIES ACT (ADA) AND ARCHITECTURAL AND TRANSPORTATION BARRIERS COMPLIANCE BOARD, FEDERAL REGISTER 36 CFR PARTS 1190 AND 1191, ACCESSIBILITY GUIDELINES FOR BUILDINGS AND FACILITIES, ARCHITECTURAL BARRIERS ACT (ABA) ACCESSIBILITY GUIDELINES, PROPOSED RULE. PUBLISHED IN THE FEDERAL REGISTER ON JULY 23, 2004, AS HAS BEEN ADOPTED BY METRO.



PHASE 1 TRAFFIC CONTROL PLAN - PEDESTRIAN DETOUR MAP

N 11TH STREET AND FOREST AVENUE

SCALE: 1"=10'

SHEET 3

LEGEND

	TEMPORARY SIDEWALK BARRICADE W/ SIGN (NEW)
	CONSTRUCTION WORK ZONE (NEW)
	INTERCONNECTED PORTABLE BARRIER RAIL (NEW)
	TEMPORARY BARRICADE W/ SIGN (TYPE III) (NEW)

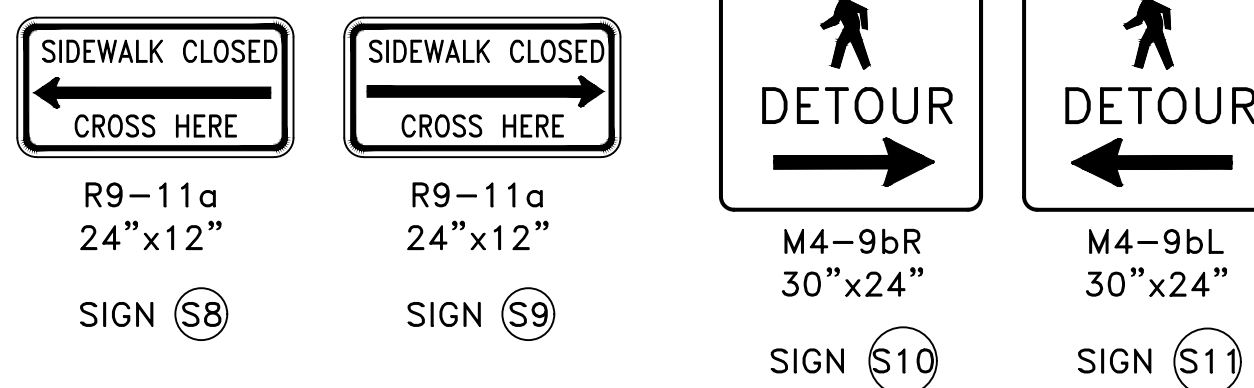

GENERAL NOTES:

1. PEDESTRIAN CROSSWALK TO REMAIN OPEN AT ALL TIMES CONSTRUCTION IS NOT ACTIVE AT THIS SPECIFIC LOCATION. CONTRACTOR SHOULD LIMIT THE DURATION OF THIS CROSSWALK CLOSURE WHEN POSSIBLE.
2. CONTRACTOR SHALL COORDINATE WITH LOCAL BUSINESSES AND MAINTAIN ACCESS AS NEEDED.
3. AMERICANS WITH DISABILITY ACT (ADA) COMPLIANT PEDESTRIAN CROSSINGS SHALL REMAIN MARKED AND CLEAR OF OBSTRUCTIONS ON THE NORTH, EAST, AND WEST LEGS AT ALL TIMES DURING THIS PHASE OF CONSTRUCTION.
4. CONTRACTOR SHALL MAINTAIN EMERGENCY VEHICLE ACCESS AT ALL TIMES ON N 11TH STREET AND FOREST AVENUE.
5. CONTRACTOR SHALL PLATE ROADWAY FOR VEHICLE ACCESS DURING HOURS THAT CONSTRUCTION IS NOT ACTIVE. CONTRACTOR SHALL COORDINATE WITH NDOT AND LOCAL BUSINESSES TO COMPLETE CONSTRUCTION DURING HOURS WHICH MINIMIZE IMPACTS TO LOCAL BUSINESSES AND RESIDENTS.

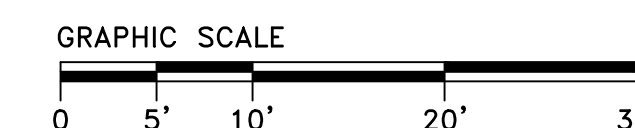



SPECIAL NOTE:
 THE DESIGN INFORMATION FOR ROADWAY AND UTILITIES PRESENTED ON THIS PLAN WERE PROVIDED TO KCI TECHNOLOGIES, INC. BY GRAYSTONE CONSTRUCTION TN. WHERE AVAILABLE, BASE INFORMATION HAS BEEN SUPPLEMENTED BY AERIAL IMAGERY AND FIELD OBSERVATIONS BY THE ENGINEER. KCI TECHNOLOGIES, INC. MAKES NO CLAIMS AS TO THE COMPLETENESS OR ACCURACY OF THE PROVIDED BASE INFORMATION.

LEGEND

	GROUND MOUNTED CONSTRUCTION SIGN W/ NUMBER (NEW)
	DIRECTION OF TRAVEL
	FLAGGER
	CONSTRUCTION WORK ZONE (NEW)
	INTERCONNECTED PORTABLE BARRIER RAIL (NEW)
	TEMPORARY BARRICADE W/ SIGN (TYPE III) (NEW)
	FLEXIBLE DRUMS
	TEMPORARY BARRICADE (TYPE III) (NEW)

GENERAL NOTES:

1. PEDESTRIAN CROSSWALK TO REMAIN OPEN AT ALL TIMES CONSTRUCTION IS NOT ACTIVE AT THIS SPECIFIC LOCATION. CONTRACTOR SHOULD LIMIT THE DURATION OF THIS CROSSWALK CLOSURE WHEN POSSIBLE.
2. CONTRACTOR SHALL COORDINATE WITH LOCAL BUSINESSES AND MAINTAIN ACCESS AS NEEDED.
3. CONTRACTOR SHALL COORDINATE WITH METRO NASHVILLE TRASH SERVICES AND AVOID CLOSING ACCESS TO ALLEY WHEN PICKUP IS SCHEDULED.
4. CONTRACTOR IS RESPONSIBLE FOR SECURING THE WORK ZONE AND EXCAVATIONS FROM VEHICLES, PEDESTRIANS, AND CYCLISTS AT ALL TIMES.
5. QUALIFIED FLAGGERS TRAINED IN PROCEDURES DETAILED IN THE MANUAL ON UNIFORM TRAFFIC CONTROL DEVICES (MUTCD) SHALL BE STATIONED AT EACH END OF THE WORK ZONE TO CONTROL ALL VEHICULAR PEDESTRIAN, AND BICYCLE TRAFFIC. FLAGGERS SHALL CONTROL ALL TRAFFIC WITH A STOP (R1-1) AND SLOW (W20-8) PADDLE. FLAGGERS SHALL PROVIDE PRIORITY ACCESS FOR EMERGENCY VEHICLES.
6. TRAFFIC CONTROL PHASES SHALL NOT BE IMPLEMENTED SIMULTANEOUSLY. TRAFFIC CONTROL PHASES 1, 2, AND 3 SHALL ONLY BE IMPLEMENTED INDEPENDENTLY OF OTHER PHASES.
7. PLACE SIGNS S2 AND S3 100 FEET IN ADVANCE OF THE FLAGGER IN EACH APPROACH.
8. CONTRACTOR SHALL MAINTAIN EMERGENCY VEHICLE ACCESS AT ALL TIMES ON N 11TH STREET AND FOREST AVENUE.
9. CONFLICTING STOP LINES AND DOUBLE SOLID YELLOW LINE TO BE COVERED WITH BLACK-OUT TAPE DURING THIS PHASE OF CONSTRUCTION. PAVEMENT MARKINGS TO BE RESTORED TO THEIR ORIGINAL CONDITION FOLLOWING THIS PHASE OF CONSTRUCTION.
10. CONTRACTOR SHALL PLATE ROADWAY FOR VEHICLE ACCESS DURING HOURS THAT CONSTRUCTION IS NOT ACTIVE. CONTRACTOR SHALL COORDINATE WITH NDOT AND LOCAL BUSINESSES TO COMPLETE CONSTRUCTION DURING HOURS WHICH MINIMIZE IMPACTS TO LOCAL BUSINESSES AND RESIDENTS.

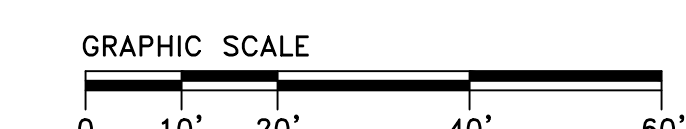
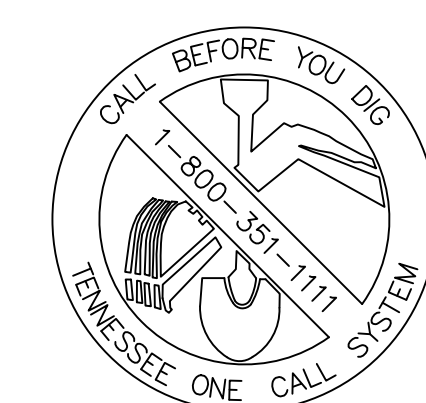
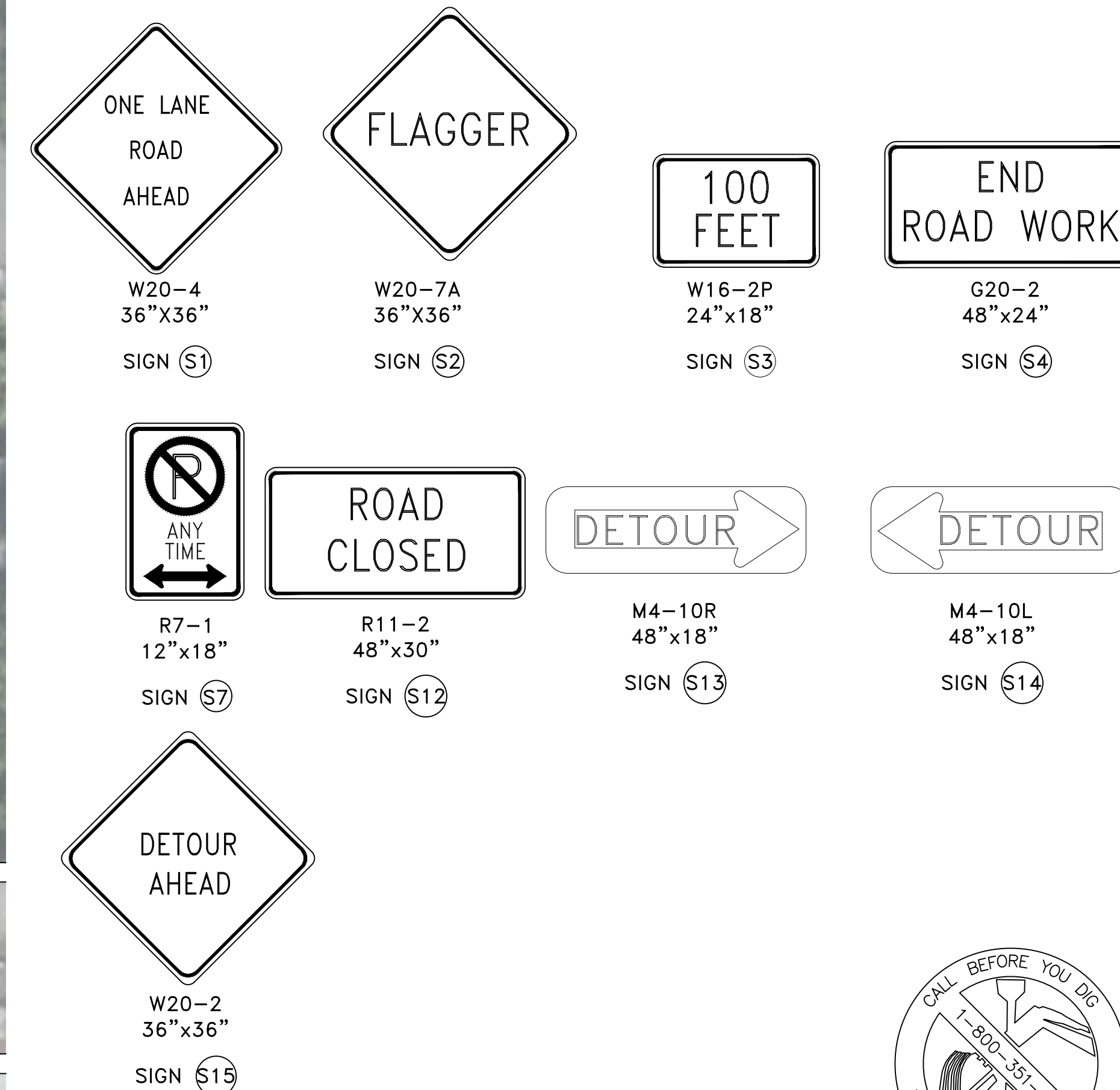

FILE NO.	332401943
DATE:	05/23/24
DESIGNED BY:	MAT
DRAWN BY:	JMG
CHECKED BY:	JMC

REVISION BLOCK	
DATE:	

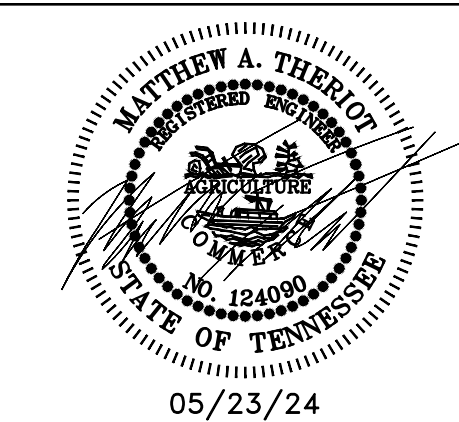

ALL CONSTRUCTION ACTIVITIES SHALL BE COMPLETED IN FULL COMPLIANCE WITH THE AMERICANS WITH DISABILITIES ACT (ADA) AND ARCHITECTURAL AND TRANSPORTATION BARRIERS COMPLIANCE BOARD, FEDERAL REGISTER 36 CFR PARTS 1190 AND 1191, ACCESSIBILITY GUIDELINES FOR BUILDINGS AND FACILITIES, ARCHITECTURAL BARRIERS ACT (ABA) ACCESSIBILITY GUIDELINES, PROPOSED RULE. PUBLISHED IN THE FEDERAL REGISTER ON JULY 23, 2004, AS HAS BEEN ADOPTED BY METRO.



PHASE 2 TRAFFIC CONTROL PLAN

N 11TH STREET AND FOREST AVENUE

SCALE: 1"=20'

SHEET 4

FILE NO.	332401943
DATE:	05/23/24
DESIGNED BY:	MAT
DRAWN BY:	JMG
CHECKED BY:	JMC

REVISION BLOCK

DATE:		

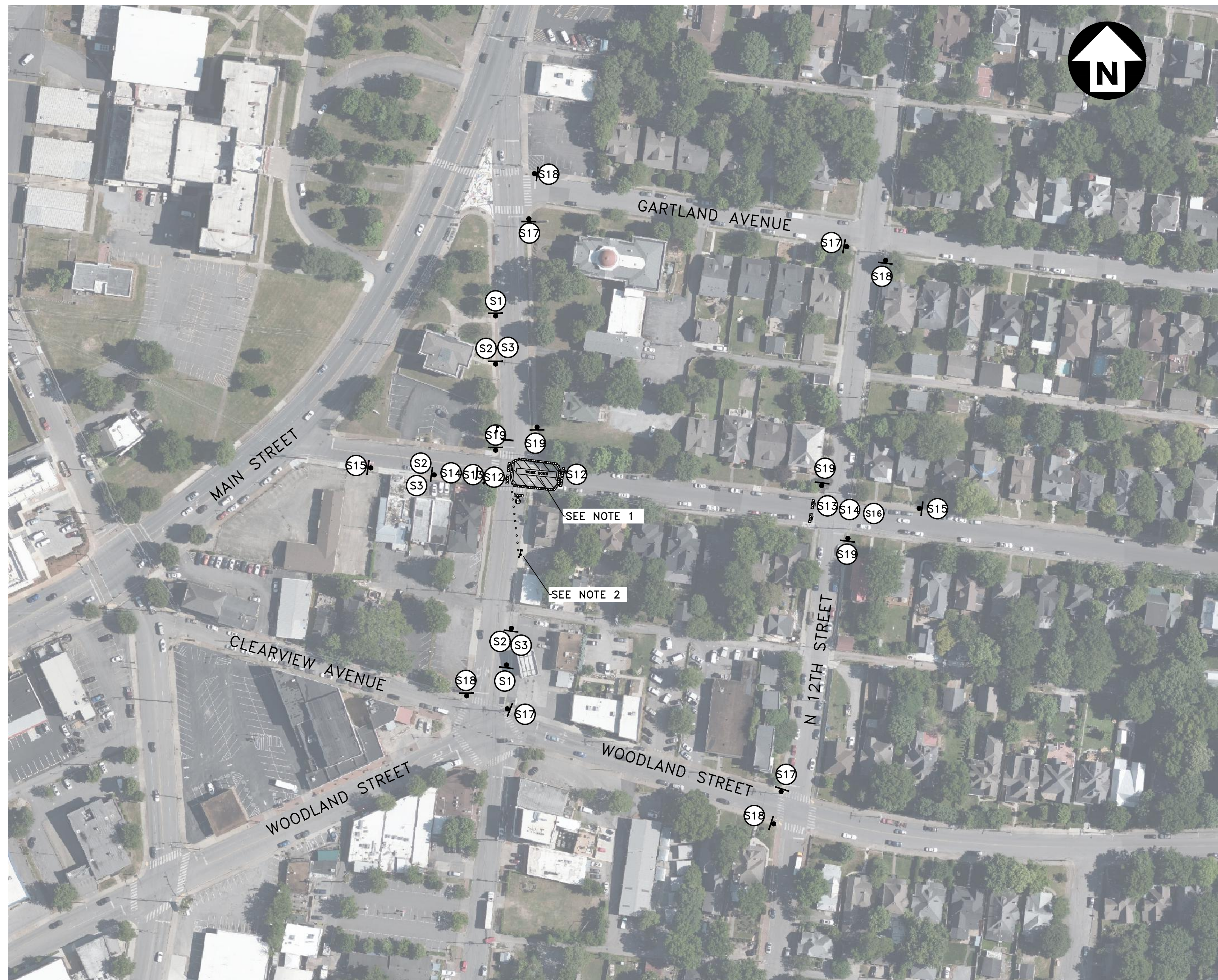

 W20-4 36"x36" SIGN (S1)	 G20-2 48"x24" SIGN (S4)	 R11-2 48"x30" SIGN (S12)	 M4-10R 48"x18" SIGN (S13)
 M4-10L 48"x18" SIGN (S14)	 W20-2 36"x36" SIGN (S15)	 R11-3a 60"x30" SIGN (S16)	
 M4-9R (MOD.) 30"x24" SIGN (S17)	 M4-9L (MOD.) 30"x24" SIGN (S18)	 M4-8a 24"x18" SIGN (S19)	

LEGEND

	GROUND MOUNTED CONSTRUCTION SIGN W/ NUMBER (NEW)
	DIRECTION OF TRAVEL
	FLAGGER
	CONSTRUCTION WORK ZONE (NEW)
	INTERCONNECTED PORTABLE BARRIER RAIL (NEW)
	TEMPORARY BARRICADE W/ SIGN (TYPE III) (NEW)
	FLEXIBLE DRUMS

GENERAL NOTES:

1. PEDESTRIAN CROSSWALK TO REMAIN OPEN AT ALL TIMES CONSTRUCTION IS NOT ACTIVE AT THIS SPECIFIC LOCATION. CONTRACTOR SHOULD LIMIT THE DURATION OF THIS CROSSWALK CLOSURE WHEN POSSIBLE.
2. CONTRACTOR SHALL COORDINATE WITH LOCAL BUSINESSES AND MAINTAIN ACCESS AS NEEDED.
3. CONTRACTOR SHALL MAINTAIN EMERGENCY VEHICLE ACCESS AT ALL TIMES ON N 11TH STREET AND FOREST AVENUE.
4. CONTRACTOR SHALL PLATE ROADWAY FOR VEHICLE ACCESS DURING HOURS THAT CONSTRUCTION IS NOT ACTIVE. CONTRACTOR SHALL COORDINATE WITH NDOT AND LOCAL BUSINESSES TO COMPLETE CONSTRUCTION DURING HOURS WHICH MINIMIZE IMPACTS TO LOCAL BUSINESSES AND RESIDENTS.

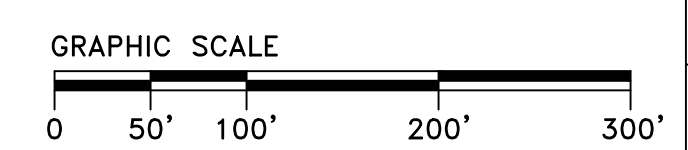

ALL CONSTRUCTION ACTIVITIES SHALL BE COMPLETED IN FULL COMPLIANCE WITH THE AMERICANS WITH DISABILITIES ACT (ADA) AND ARCHITECTURAL AND TRANSPORTATION BARRIERS COMPLIANCE BOARD, FEDERAL REGISTER 36 CFR PARTS 1190 AND 1191, ACCESSIBILITY GUIDELINES FOR BUILDINGS AND FACILITIES, ARCHITECTURAL BARRIERS ACT (ABA) ACCESSIBILITY GUIDELINES, PROPOSED RULE. PUBLISHED IN THE FEDERAL REGISTER ON JULY 23, 2004, AS HAS BEEN ADOPTED BY METRO.



PHASE 2 TRAFFIC CONTROL PLAN - VEHICLE DETOUR MAP

N 11TH STREET AND FOREST AVENUE

SCALE: 1"=100'

FILE NO.	332401943
DATE:	05/23/24
DESIGNED BY:	MAT
DRAWN BY:	JMG
CHECKED BY:	JMC

REVISION BLOCK	
DATE:	

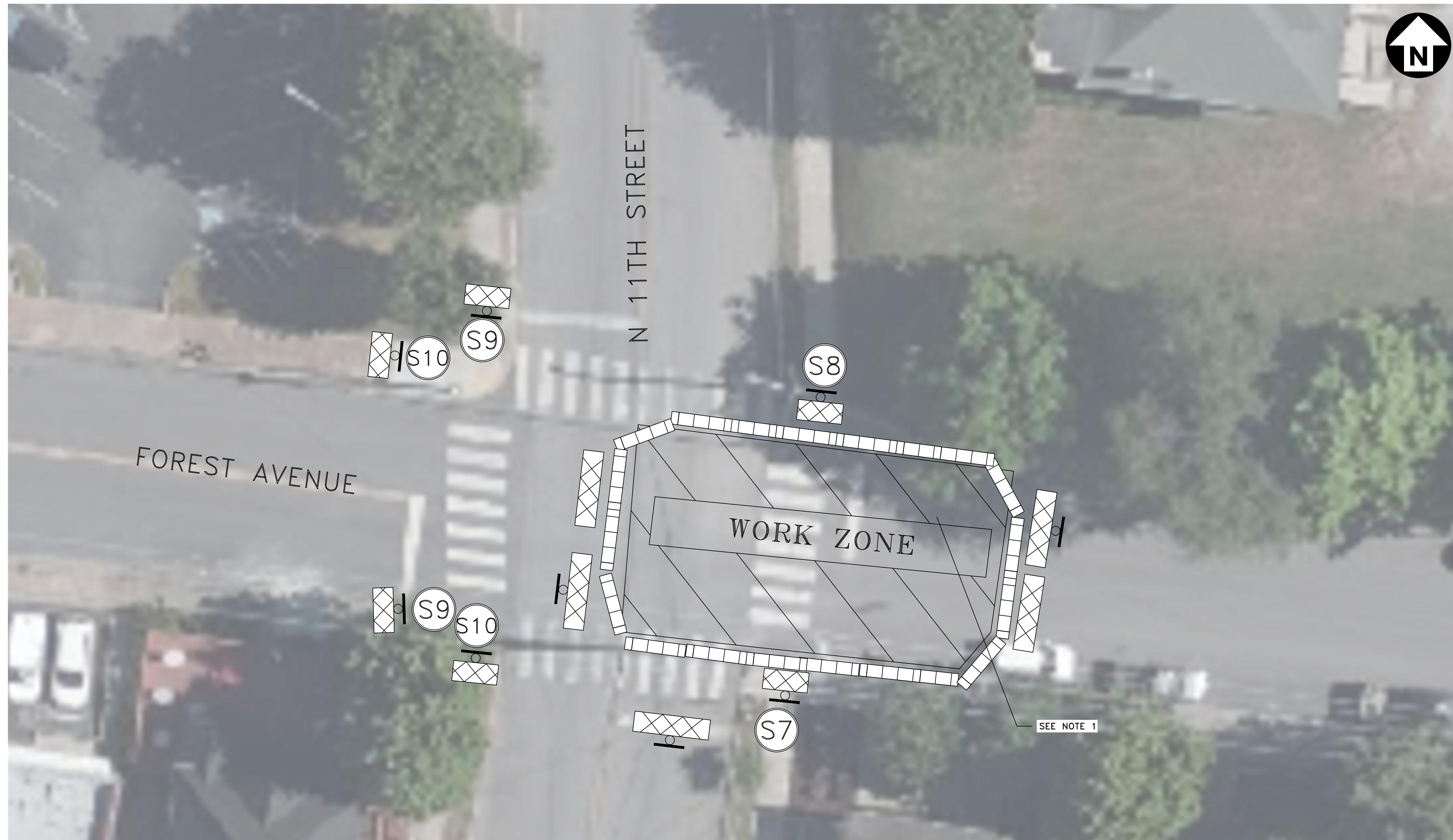

ALL CONSTRUCTION ACTIVITIES SHALL BE COMPLETED IN FULL COMPLIANCE WITH THE AMERICANS WITH DISABILITIES ACT (ADA) AND ARCHITECTURAL AND TRANSPORTATION BARRIERS COMPLIANCE BOARD, FEDERAL REGISTER 36 CFR PARTS 1190 AND 1191, ACCESSIBILITY GUIDELINES FOR BUILDINGS AND FACILITIES, ARCHITECTURAL BARRIERS ACT (ABA) ACCESSIBILITY GUIDELINES, PROPOSED RULE. PUBLISHED IN THE FEDERAL REGISTER ON JULY 23, 2004, AS HAS BEEN ADOPTED BY METRO.



PHASE 2 TRAFFIC CONTROL PLAN - PEDESTRIAN DETOUR MAP

N 11TH STREET AND FOREST AVENUE

SCALE: 1"=10'

SHEET 6

LEGEND

	GROUND MOUNTED CONSTRUCTION SIGN W/ NUMBER (NEW)
	DIRECTION OF TRAVEL
	TEMPORARY SIDEWALK BARRICADE W/ SIGN (NEW)
	CONSTRUCTION WORK ZONE (NEW)
	INTERCONNECTED PORTABLE BARRIER RAIL (NEW)
	TEMPORARY BARRICADE W/ SIGN (TYPE III) (NEW)
	FLEXIBLE DRUMS

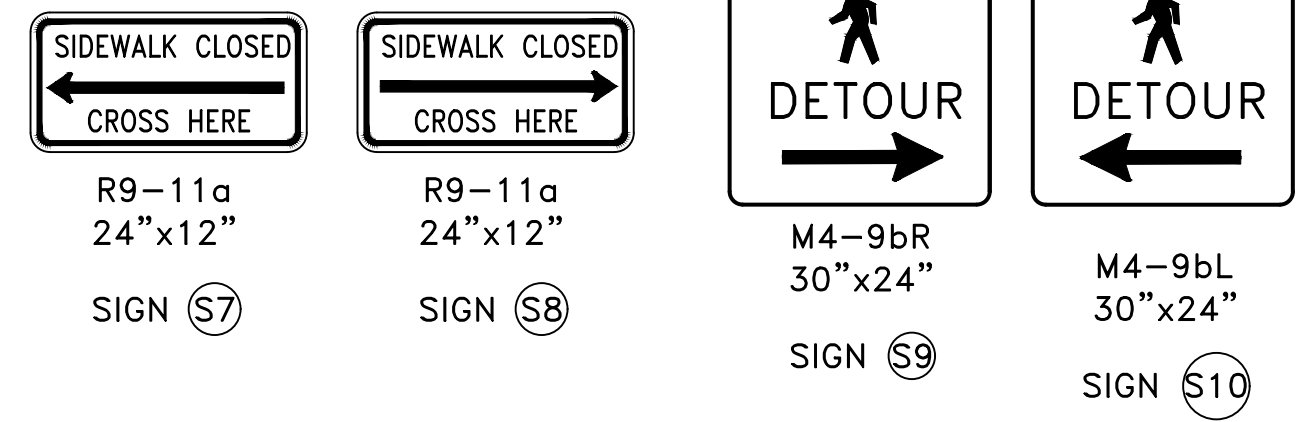

- GENERAL NOTES:**
1. PEDESTRIAN CROSSWALK TO REMAIN OPEN AT ALL TIMES CONSTRUCTION IS NOT ACTIVE AT THIS SPECIFIC LOCATION. CONTRACTOR SHOULD LIMIT THE DURATION OF THIS CROSSWALK CLOSURE WHEN POSSIBLE.
 2. CONTRACTOR SHALL COORDINATE WITH LOCAL BUSINESSES AND MAINTAIN ACCESS AS NEEDED.
 3. AMERICANS WITH DISABILITY ACT (ADA) COMPLIANT CURB RAMPS AND PEDESTRIAN CROSSINGS SHALL REMAIN OPEN ON ALL LEGS AND CORNERS OF N 11TH STREET AND FOREST AVENUE DURING THIS PHASE OF CONSTRUCTION.
 4. CONTRACTOR SHALL MAINTAIN EMERGENCY VEHICLE ACCESS AT ALL TIMES ON N 11TH STREET AND FOREST AVENUE.
 5. CONTRACTOR SHALL PLATE ROADWAY FOR VEHICLE ACCESS DURING HOURS THAT CONSTRUCTION IS NOT ACTIVE. CONTRACTOR SHALL COORDINATE WITH NDOT AND LOCAL BUSINESSES TO COMPLETE CONSTRUCTION DURING HOURS WHICH MINIMIZE IMPACTS TO LOCAL BUSINESSES AND RESIDENTS.

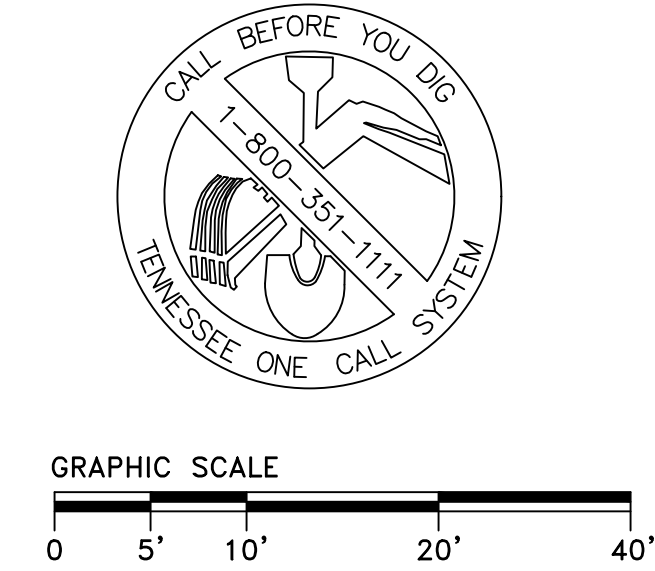

FILE NO.	332401943
DATE:	05/23/24
DESIGNED BY:	MAT
DRAWN BY:	JMG
CHECKED BY:	JMC

REVISION BLOCK	
DATE:	



ALL CONSTRUCTION ACTIVITIES SHALL BE COMPLETED IN FULL COMPLIANCE WITH THE AMERICANS WITH DISABILITIES ACT (ADA) AND ARCHITECTURAL AND TRANSPORTATION BARRIERS COMPLIANCE BOARD, FEDERAL REGISTER 36 CFR PARTS 1190 AND 1191, ACCESSIBILITY GUIDELINES FOR BUILDINGS AND FACILITIES, ARCHITECTURAL BARRIERS ACT (ABA) ACCESSIBILITY GUIDELINES, PROPOSED RULE. PUBLISHED IN THE FEDERAL REGISTER ON JULY 23, 2004, AS HAS BEEN ADOPTED BY METRO.

LEGEND

	GROUND MOUNTED CONSTRUCTION SIGN W/ NUMBER (NEW)
	DIRECTION OF TRAVEL
	TEMPORARY SIDEWALK BARRICADE W/ SIGN (NEW)
	CONSTRUCTION WORK ZONE (NEW)
	INTERCONNECTED PORTABLE BARRIER RAIL (NEW)
	TEMPORARY BARRICADE W/ SIGN (TYPE III) (NEW)
	FLEXIBLE DRUMS
	FLAGGER

SPECIAL NOTE:
THE DESIGN INFORMATION FOR ROADWAY AND UTILITIES PRESENTED ON THIS PLAN WERE PROVIDED TO KCI TECHNOLOGIES, INC. BY GRAYSTONE CONSTRUCTION TN. WHERE AVAILABLE, BASE INFORMATION HAS BEEN SUPPLEMENTED BY AERIAL IMAGERY AND FIELD OBSERVATIONS BY THE ENGINEER. KCI TECHNOLOGIES, INC. MAKES NO CLAIMS AS TO THE COMPLETENESS OR ACCURACY OF THE PROVIDED BASE INFORMATION.

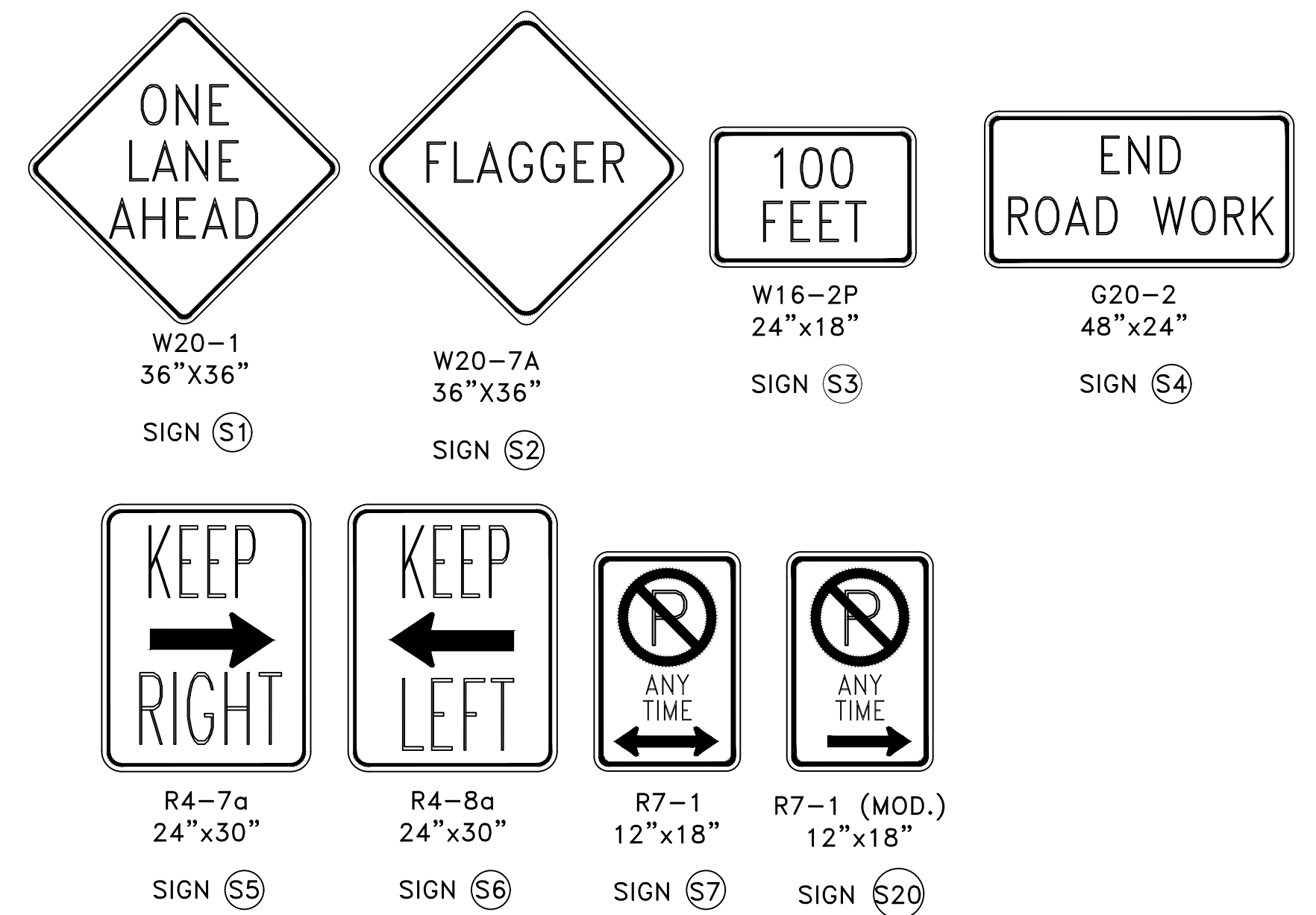

GENERAL NOTES:

- PEDESTRIAN CROSSWALK TO REMAIN OPEN AT ALL TIMES. CONSTRUCTION IS NOT ACTIVE AT THIS SPECIFIC LOCATION. CONTRACTOR SHOULD LIMIT THE DURATION OF THIS CROSSWALK CLOSURE WHEN POSSIBLE.
- CONTRACTOR SHALL COORDINATE WITH LOCAL BUSINESSES AND MAINTAIN ACCESS AS NEEDED.
- CONTRACTOR SHALL COORDINATE WITH METRO NASHVILLE TRASH SERVICES AND AVOID CLOSING ACCESS TO ALLEY WHEN PICKUP IS SCHEDULED.
- CONTRACTOR IS RESPONSIBLE FOR SECURING THE WORK ZONE AND EXCAVATIONS FROM VEHICLES, PEDESTRIANS, AND CYCLISTS AT ALL TIMES.
- QUALIFIED FLAGGERS TRAINED IN PROCEDURES DETAILED IN THE MANUAL ON UNIFORM TRAFFIC CONTROL DEVICES (MUTCD) SHALL BE STATIONED AT EACH END OF THE WORK ZONE TO CONTROL ALL VEHICULAR PEDESTRIAN, AND BICYCLE TRAFFIC. FLAGGERS SHALL CONTROL ALL TRAFFIC WITH A STOP (R1-1) AND SLOW (W20-8) PADDLE. FLAGGERS SHALL PROVIDE PRIORITY ACCESS FOR EMERGENCY VEHICLES.
- TRAFFIC CONTROL PHASES SHALL NOT BE IMPLEMENTED SIMULTANEOUSLY. TRAFFIC CONTROL PHASES 1, 2, AND 3 SHALL ONLY BE IMPLEMENTED INDEPENDENTLY OF OTHER PHASES.
- CONTRACTOR SHALL MAINTAIN EMERGENCY VEHICLE ACCESS AT ALL TIMES ON N 11TH STREET AND FOREST AVENUE.
- CONTRACTOR SHALL PLATE ROADWAY FOR VEHICLE ACCESS DURING HOURS THAT CONSTRUCTION IS NOT ACTIVE. CONTRACTOR SHALL COORDINATE WITH NDOT AND LOCAL BUSINESSES TO COMPLETE CONSTRUCTION DURING HOURS WHICH MINIMIZE IMPACTS TO LOCAL BUSINESSES AND RESIDENTS.

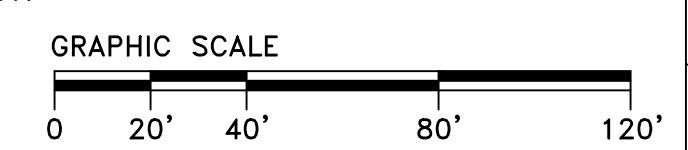

PHASE 3 TRAFFIC CONTROL PLAN

N 11TH STREET AND FOREST AVENUE

SCALE: 1"=40'

SHEET 7

FILE NO.	332401943
DATE:	05/23/24
DESIGNED BY:	MAT
DRAWN BY:	JMG
CHECKED BY:	JMC

REVISION BLOCK	
DATE:	



ALL CONSTRUCTION ACTIVITIES SHALL BE COMPLETED IN FULL COMPLIANCE WITH THE AMERICANS WITH DISABILITIES ACT (ADA) AND ARCHITECTURAL AND TRANSPORTATION BARRIERS COMPLIANCE BOARD, FEDERAL REGISTER 36 CFR PARTS 1190 AND 1191, ACCESSIBILITY GUIDELINES FOR BUILDINGS AND FACILITIES, ARCHITECTURAL BARRIERS ACT (ABA) ACCESSIBILITY GUIDELINES, PROPOSED RULE. PUBLISHED IN THE FEDERAL REGISTER ON JULY 23, 2004, AS HAS BEEN ADOPTED BY METRO.



PHASE 3 TRAFFIC CONTROL PLAN - PEDESTRIAN DETOUR MAP
N 11TH STREET AND FOREST AVENUE

SCALE: 1"=20'

SHEET 8

	GROUND MOUNTED CONSTRUCTION SIGN W/ NUMBER (NEW)
	DIRECTION OF TRAVEL
	TEMPORARY SIDEWALK BARRICADE W/ SIGN (NEW)
	CONSTRUCTION WORK ZONE (NEW)
	INTERCONNECTED PORTABLE BARRIER RAIL (NEW)
	TEMPORARY BARRICADE W/ SIGN (TYPE III) (NEW)
	FLEXIBLE DRUMS

R9-11a 24"x12"	M4-9bR 30"x24"	M4-9bL 30"x24"	R9-9 24"x12"	R9-11L 24"x18"
SIGN (S8)	SIGN (S9)	SIGN (S10)	SIGN (S21)	SIGN (S22)

GENERAL NOTES:

- SIDEWALK TO REMAIN OPEN AT ALL TIMES CONSTRUCTION IS NOT ACTIVE AT THIS SPECIFIC LOCATION. CONTRACTOR SHOULD LIMIT THE DURATION OF THIS SIDEWALK CLOSURE WHEN POSSIBLE.
- CONTRACTOR SHALL COORDINATE WITH LOCAL BUSINESSES AND MAINTAIN ACCESS AS NEEDED.
- AMERICANS WITH DISABILITY ACT (ADA) COMPLIANT CURB RAMPS AND PEDESTRIAN CROSSINGS SHALL REMAIN OPEN ON ALL LEGS AND CORNERS OF N 11TH STREET AND FOREST AVENUE DURING THIS PHASE OF CONSTRUCTION.
- CONTRACTOR SHALL MAINTAIN EMERGENCY VEHICLE ACCESS AT ALL TIMES ON N 11TH STREET AND FOREST AVENUE.
- CONTRACTOR SHALL PLATE ROADWAY FOR VEHICLE ACCESS DURING HOURS THAT CONSTRUCTION IS NOT ACTIVE. CONTRACTOR SHALL COORDINATE WITH NDOT AND LOCAL BUSINESSES TO COMPLETE CONSTRUCTION DURING HOURS WHICH MINIMIZE IMPACTS TO LOCAL BUSINESSES AND RESIDENTS.

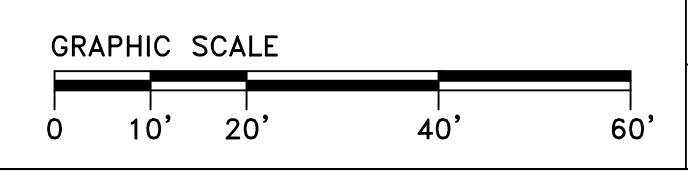
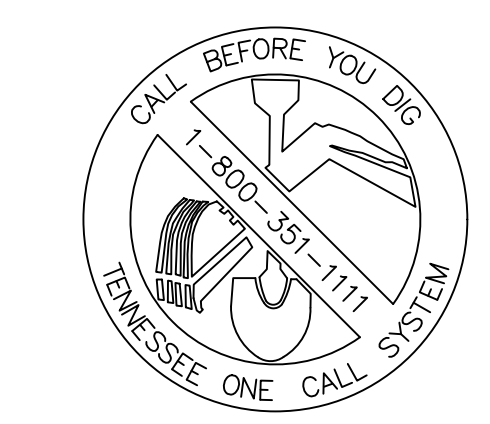

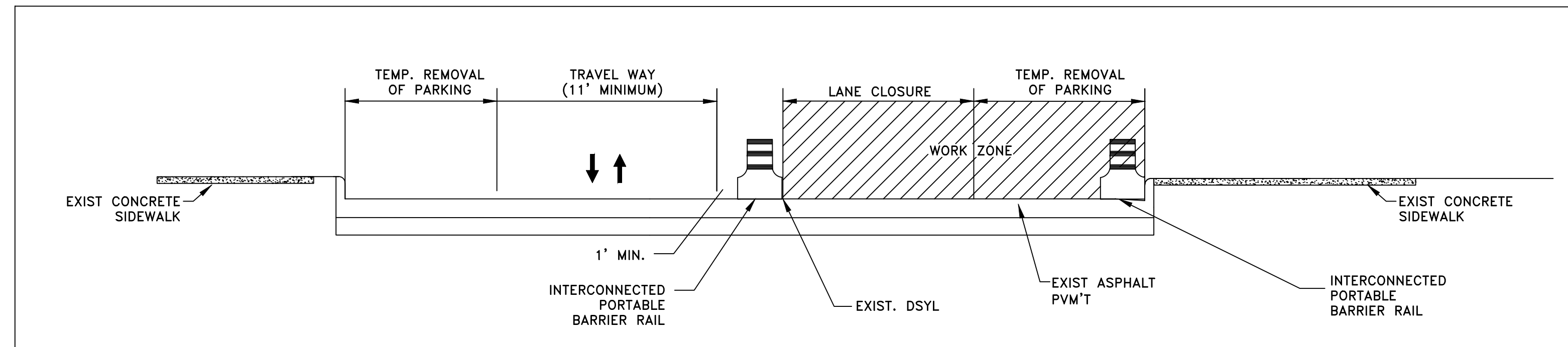

PHASE 1 N 11TH STREET TYPICAL SECTION A-A
N.T.S.

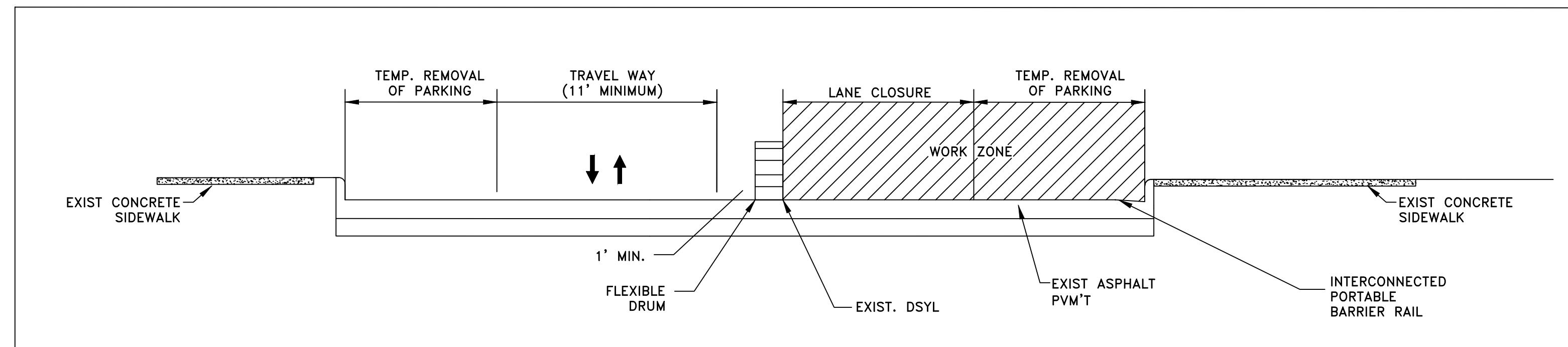

PHASE 2 N 11TH STREET TYPICAL SECTION B-B
N.T.S.

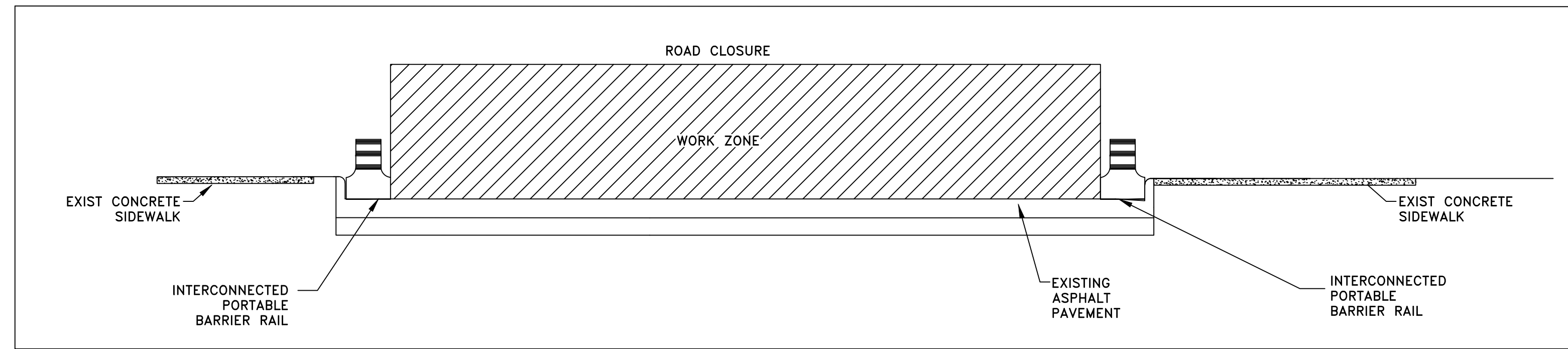

PHASE 2 FOREST AVENUE TYPICAL SECTION C-C
N.T.S.

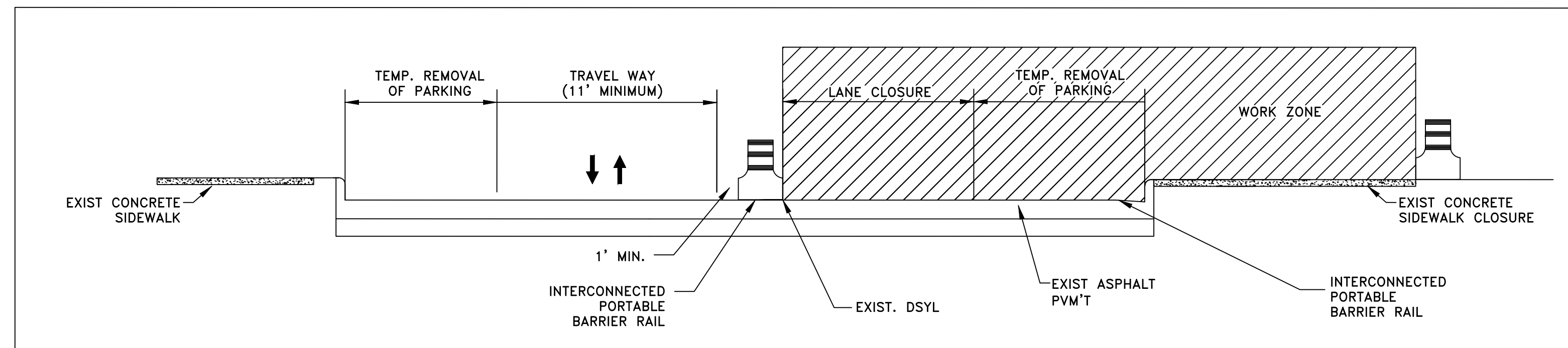

PHASE 3 FOREST AVENUE TYPICAL SECTION D-D
N.T.S.

GENERAL NOTES:

1. PEDESTRIAN CROSSWALK TO REMAIN OPEN AT ALL TIMES CONSTRUCTION IS NOT ACTIVE AT THIS SPECIFIC LOCATION. CONTRACTOR SHOULD LIMIT THE DURATION OF THIS CROSSWALK CLOSURE WHEN POSSIBLE.
2. CONTRACTOR SHALL COORDINATE WITH LOCAL BUSINESSES AND MAINTAIN ACCESS AS NEEDED.
3. CONTRACTOR SHALL PLATE ROADWAY FOR VEHICLE ACCESS DURING HOURS THAT CONSTRUCTION IS NOT ACTIVE. CONTRACTOR SHALL COORDINATE WITH NDOT AND LOCAL BUSINESSES TO COMPLETE CONSTRUCTION DURING HOURS WHICH MINIMIZE IMPACTS TO LOCAL BUSINESSES AND RESIDENTS.

FILE NO.	332401943
DATE:	05/23/24
DESIGNED BY:	MAT
DRAWN BY:	JMG
CHECKED BY:	JMC

REVISION BLOCK	
DATE:	

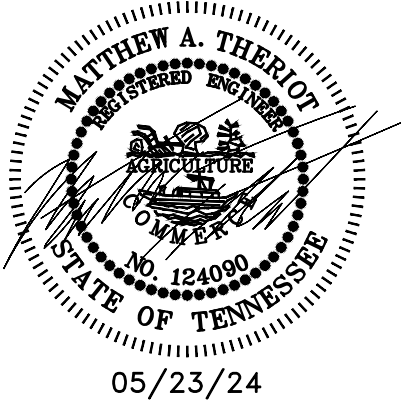

ALL CONSTRUCTION ACTIVITIES SHALL BE COMPLETED IN FULL COMPLIANCE WITH THE AMERICANS WITH DISABILITIES ACT (ADA) AND ARCHITECTURAL AND TRANSPORTATION BARRIERS COMPLIANCE BOARD, FEDERAL REGISTER 36 CFR PARTS 1190 AND 1191, ACCESSIBILITY GUIDELINES FOR BUILDINGS AND FACILITIES, ARCHITECTURAL BARRIERS ACT (ABA) ACCESSIBILITY GUIDELINES, PROPOSED RULE. PUBLISHED IN THE FEDERAL REGISTER ON JULY 23, 2004, AS HAS BEEN ADOPTED BY METRO.



TYPICAL SECTIONS

N 11TH STREET AND FOREST AVENUE

N.T.S.

SHEET 9

TRAFFIC CONTROL NOTES

GENERAL

1. NOTHING IN THE GENERAL NOTES OR SPECIAL PROVISIONS SHALL RELIEVE THE CONTRACTOR FROM HIS RESPONSIBILITIES TOWARD THE SAFETY AND CONVENIENCE OF THE GENERAL PUBLIC AND THE RESIDENTS ALONG THE PROPOSED CONSTRUCTION AREA.
2. ALL CONSTRUCTION, EQUIPMENT, AND INSTALLATION PROCEDURES SHALL COMPLY WITH THE TENNESSEE DEPARTMENT OF TRANSPORTATION (TDOT) STANDARD SPECIFICATIONS FOR ROAD AND BRIDGE CONSTRUCTION, (AS AMENDED) AND WITH THE CURRENT STANDARDS AND SPECIFICATIONS OF METRO PUBLIC WORKS. PAVEMENT MARKING REMOVAL AND TRAFFIC CONTROL SHALL COMPLY WITH SECTION 712-TEMPORARY TRAFFIC CONTROL.

TEMPORARY TRAFFIC CONTROL

3. ADVANCED WARNING SIGNS SHALL NOT BE DISPLAYED MORE THAN FORTY-EIGHT (48) HOURS BEFORE PHYSICAL CONSTRUCTION BEGINS. SIGNS MAY BE ERECTED UP TO ONE WEEK BEFORE NEEDED, IF THE SIGN FACE IS FULLY COVERED.
4. IF THE CONTRACTOR MOVES OFF THE PROJECT, HE SHALL COVER OR REMOVE ALL UNNEEDED SIGNS AS DIRECTED BY THE ENGINEER. COSTS OF REMOVAL, COVERING, AND REINSTALLING SIGNS SHALL NOT BE MEASURED AND PAID FOR SEPARATELY, BUT ALL COST SHALL BE INCLUDED IN THE ORIGINAL UNIT PRICE BID FOR ITEM NO 712-06, SIGNS (CONSTRUCTION) PER SQUARE FOOT.
5. A LONG TERM BUT SPORADIC USE WARNING SIGN, SUCH AS A FLAGGER SIGN, MAY REMAIN IN PLACE WHEN NOT REQUIRED PROVIDED THE SIGN FACE IS FULLY COVERED.
6. TRAFFIC CONTROL DEVICES SHALL NOT BE DISPLAYED OR ERECTED UNLESS RELATED CONDITIONS ARE PRESENT NECESSITATING WARNING.
7. USE OF BARRICADES, PORTABLE BARRIER RAILS, VERTICAL PANELS, AND DRUMS SHALL BE LIMITED TO THE IMMEDIATE AREAS OF CONSTRUCTION WHERE A HAZARD IS PRESENT. THESE DEVICES SHALL NOT BE STORED ALONG THE ROADWAY WITHIN THIRTY (30) FEET OF THE EDGE OF THE TRAVELED WAY BEFORE OR AFTER USE UNLESS PROTECTED BY GUARDRAIL, BRIDGE RAIL, AND/OR BARRIERS INSTALLED FOR OTHER PURPOSES FOR ROADWAYS WITH CURRENT ADTS LESS THAN 1500 AND DESIGN SPEED OF LESS THAN 60 MPH. THIS DISTANCE SHALL INCREASE TO FORTY-FIVE (45) FEET FOR ROADWAYS WITH CURRENT ADTS OF 1500 OR GREATER AND DESIGN SPEED OF 60 MPH OR GREATER OR ON THE OUTSIDE OF A HORIZONTAL CURVE. THESE DEVICES SHALL BE REMOVED FROM THE CONSTRUCTION WORK ZONE WHEN THE ENGINEER DETERMINES THEY ARE NO LONGER NEEDED. WHERE THERE IS INSUFFICIENT RIGHT-OF-WAY TO PROVIDE FOR THIS REQUIRED SETBACK, THE CONTRACTOR SHALL DETERMINE THE ALTERNATE LOCATIONS AND REQUEST THE ENGINEERS APPROVAL TO USE THEM.
8. THE CONTRACTOR SHALL NOT BE PERMITTED TO PARK ANY VEHICLES OR CONSTRUCTION EQUIPMENT DURING PERIODS OF INACTIVITY, WITHIN THIRTY (30) FEET OF THE EDGE OF PAVEMENT WHEN THE LANE IS OPEN TO TRAFFIC. UNLESS PROTECTED BY GUARDRAIL, BRIDGE RAIL, AND/OR BARRIERS INSTALLED FOR OTHER PURPOSES FOR ROADWAYS WITH CURRENT ADTS LESS THAN 1500 AND DESIGN SPEED LESS THAN 60 MPH. THIS DISTANCE SHALL BE INCREASED TO FORTY-FIVE (45) FEET FOR ROADWAYS WITH CURRENT ADTS OF 1500 OR GREATER AND DESIGN SPEED OF 60 MPH OR GREATER OR ON THE OUTSIDE OF A HORIZONTAL CURVE. PRIVATELY OWNED VEHICLES SHALL NOT BE ALLOWED TO PARK WITHIN THIRTY (30) FEET OF AN OPEN TRAFFIC LANE AT ANY TIME UNLESS PROTECTED AS DESCRIBED ABOVE. WHERE THERE IS INSUFFICIENT RIGHT-OF-WAY TO PROVIDE FOR THIS 30 FOOT SETBACK, THE CONTRACTOR SHALL DETERMINE THE ALTERNATE LOCATIONS AND REQUEST THE ENGINEER'S APPROVAL TO USE THEM.
9. ALL DETOUR AND CONSTRUCTION SIGNING SHALL BE IN STRICT ACCORDANCE WITH THE MANUAL ON UNIFORM TRAFFIC CONTROL DEVICES.
10. ALL DETOURS SHALL BE PAVED, STRIPED, SIGNED AND THE VERTICAL PANELS ARE TO BE IN PLACE BEFORE IT IS OPEN TO TRAFFIC.

11. ALL CONSTRUCTION ACTIVITIES SHALL BE COMPLETED IN FULL COMPLIANCE WITH THE AMERICANS WITH DISABILITIES ACT (ADA) AND ARCHITECTURAL AND TRANSPORTATION BARRIERS COMPLIANCE BOARD, FEDERAL REGISTER 36 CFR PARTS 1190 AND 1191, ACCESSIBILITY GUIDELINES FOR BUILDINGS AND FACILITIES, ARCHITECTURAL BARRIERS ACT (ABA) ACCESSIBILITY GUIDELINES, PROPOSED RULE. PUBLISHED IN THE FEDERAL REGISTER ON JULY 23, 2004, AS HAS BEEN ADOPTED BY METRO.
12. CONTRACTOR SHALL PLATE ROADWAY FOR VEHICLE ACCESS DURING HOURS THAT CONSTRUCTION IS NOT ACTIVE. CONTRACTOR SHALL COORDINATE WITH NDOT AND LOCAL BUSINESSES TO COMPLETE CONSTRUCTION DURING HOURS WHICH MINIMIZE IMPACTS TO LOCAL BUSINESSES AND RESIDENTS.

ESTIMATED ROADWAY QUANTITIES			
ITEM NO.	DESCRIPTION	UNIT	QUANTITY
712-01	TRAFFIC CONTROL	L.S.	1
712-01.05	FLAGMAN	HOURS	505
712-02.02	INTERCONNECTED PORTABLE BARRIER RAIL	L.F.	410
712-04.01	FLEXIBLE DRUMS (CHANNELIZING)	EACH	15
(1) 712-06	SIGNS (CONSTRUCTION)	S.F.	352
712-07.01	TEMPORARY BARRICADES (TYPE II)	L.F.	12
712-07.03	TEMPORARY BARRICADES (TYPE III)	L.F.	65
717-01	MOBILIZATION	L.S.	1

FOOTNOTES:

- (1) SEE SUMMARY OF ITEM 712-06 FOR DETAILS OF CONSTRUCTION SIGNS (THIS SHEET).

SUMMARY OF QUANTITIES - ITEM NO. 712-06 *			
SIGN NO.	DESCRIPTION	SIZE (IN)	NUMBER REQUIRED
G20-2	END ROAD WORK	48X24	7
M4-8a	END DETOUR	24X18	4
M4-9bL	PEDESTRIAN DETOUR (LEFT)	30X24	2
M4-9bR	PEDESTRIAN DETOUR (RIGHT)	30X24	2
M4-9bL MOD	FOREST AVENUE DETOUR (LEFT)	30X24	4
M4-9bR MOD	FOREST AVENUE DETOUR (RIGHT)	30X24	4
M4-10L	DETOUR (LEFT ARROW)	48X18	2
M4-10R	DETOUR (RIGHT ARROW)	48X18	2
R4-7a	KEEP RIGHT	24X30	1
R4-8a	KEEP LEFT	24X30	1
R7-1	NO PARKING ANYTIME	12X18	4
R7-1 MOD	NO PARKING ANYTIME (RIGHT)	12X18	1
R9-9	SIDEWALK CLOSED	24X12	1
R9-11aL	SIDEWALK CLOSED CROSS HERE (LEFT)	24X12	1
R9-11aR	SIDEWALK CLOSED CROSS HERE (RIGHT)	24X12	1
R9-11L	SIDEWALK CLOSED AHEAD CROSS HERE (LEFT)	24X18	1
R11-2	ROAD CLOSED	48X30	2
R11-3A	ROAD CLOSED AHEAD LOCAL TRAFFIC ONLY	60X30	1
W20-2	DETOUR AHEAD	36X36	2
W20-4	ONE LANE AHEAD	36X36	7
W20-7A	FLAGGER	36X36	5
W16-2P	100 FEET	24X18	5

FILE NO.	332401943
DATE:	05/23/24
DESIGNED BY:	MAT
DRAWN BY:	JMG
CHECKED BY:	JMC

REVISION BLOCK

DATE:		

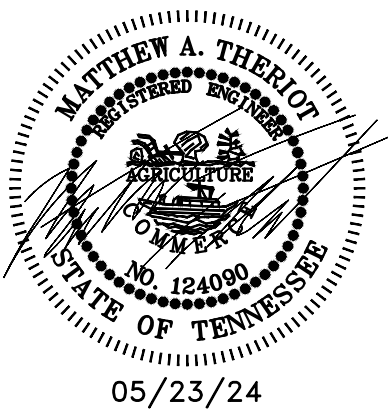

ALL CONSTRUCTION ACTIVITIES SHALL BE COMPLETED IN FULL COMPLIANCE WITH THE AMERICANS WITH DISABILITIES ACT (ADA) AND ARCHITECTURAL AND TRANSPORTATION BARRIERS COMPLIANCE BOARD, FEDERAL REGISTER 36 CFR PARTS 1190 AND 1191, ACCESSIBILITY GUIDELINES FOR BUILDINGS AND FACILITIES, ARCHITECTURAL BARRIERS ACT (ABA) ACCESSIBILITY GUIDELINES, PROPOSED RULE. PUBLISHED IN THE FEDERAL REGISTER ON JULY 23, 2004, AS HAS BEEN ADOPTED BY METRO.



TRAFFIC CONTROL NOTES AND QUANTITIES

N 11TH STREET AND FOREST AVENUE

N.T.S.

SHEET 10