

MULTIMODAL ACCESS CLOSURE EXCEPTION APPLICATION FORM AND CHECKLIST

Submittal Date: 10/03/2024 New Submittal Re-Submittal No: _____

Related Building Permit No: T2023059287

Project Name: Nashville Motto Hotel

Street Name Location: Korean Veterans Blvd

Between: 4th Ave. S. And: Almond Street

Applicant Name: Natalie Burgess

Address: 401 Church St. Unit 2200 Nashville, TN 37219

Phone: (612) 839-4312 Fax: N/A Contact: Natalie Burgess

Email: natalie.burgess@mortenson.com

Project Description: The construction of a new bus shelter within the right of way.

Start Date: _____ End Date: _____ Project Length: _____

Describe Type of Closure: _____

The project requires the closure of a parking lane and periodic closure of the adjacent travel lane.

Provide Reasons why Project cannot be completed without closures and what other options were considered (attach documents as needed): _____

The construction takes place in the parking lane and concrete trucks will need to use the adjacent travel lane. This will prevent the need to close the sidewalk.

PROJECT INFORMATION CHECKLIST:

Included Not Applicable

- | | | |
|-------------------------------------|-------------------------------------|--|
| <input checked="" type="checkbox"/> | <input type="checkbox"/> | Project Vicinity Map with Project Area shown, street names, property information, existing pavement and striping, gutter and building locations, north arrow, and scale. |
| <input checked="" type="checkbox"/> | <input type="checkbox"/> | Planned work hours included. |
| <input checked="" type="checkbox"/> | <input type="checkbox"/> | Exact location and dimensions of the construction work zone shown. |
| <input checked="" type="checkbox"/> | <input type="checkbox"/> | If multiple phases are necessary, include perimeter impact of each phase, phase number, anticipated work hours and phase duration. |
| <input checked="" type="checkbox"/> | <input type="checkbox"/> | Details on construction activity and equipment being used as part of construction included for each phase. |
| <input checked="" type="checkbox"/> | <input type="checkbox"/> | Specify if any on-street parking, and/or metered parking, is to be restricted and if bus zone will need to be relocated. |
| <input type="checkbox"/> | <input checked="" type="checkbox"/> | Specify if trash pickup will be impacted. |
| <input type="checkbox"/> | <input checked="" type="checkbox"/> | Provide information on all utility work and utility connections. |
| <input type="checkbox"/> | <input checked="" type="checkbox"/> | List all affected residents, businesses, agencies, and schools and any conversations/agreements taken place. |
| <input type="checkbox"/> | <input checked="" type="checkbox"/> | Show ongoing construction projects within vicinity of proposed project impact. |
| <input checked="" type="checkbox"/> | <input type="checkbox"/> | Provide plan to address conflicts with other nearby projects. |
| <input checked="" type="checkbox"/> | <input type="checkbox"/> | Provide traffic control plan for each phase of construction (see traffic control checklist for more information). |
| <input checked="" type="checkbox"/> | <input type="checkbox"/> | Provide information on work vehicle parking locations. |
| <input checked="" type="checkbox"/> | <input type="checkbox"/> | Show construction trucks ingress/egress to project location. |
| <input type="checkbox"/> | <input checked="" type="checkbox"/> | Provide information on any traffic signals, traffic signal loops, and traffic signal cabinets in close proximity to project. |

TRAFFIC CONTROL PLAN CHECKLIST:

Included Not Applicable

- All temporary traffic control plans shall be designed in accordance with the most recent ADA regulations and requirements of the Manual of Uniform Traffic Control Devices.
- Clearly show the locations of all existing signs (including speed limit) as well as the proposed signs for each construction phase.
- Show the location of all existing pedestrian paths and pedestrian detour route of each stage of construction.
- Show dimensions of travel lane width, shoulder width, sidewalk of each phase, and overall roadway width along the length of affected area.
- Show all existing striping and markings to remain, to be removed, and all proposed striping and markings for each construction stage.
- Provide detour plan clearly showing detour route for any roadway or pedestrian/bike path closures.
- Specify placement of all temporary traffic control devices.
- Specify spacing of all temporary traffic control devices.
- Show all existing traffic signals and streetlights in the work zone location.
- Lighting provided for all pedestrian detour routes.
- Provide minimum eleven (11) foot travel lanes at all times.
- Show size, height, and location of all channelizing devices, warning lights, flag trees, barriers, etc.
- Label all taper lengths and widths.
- Provide locations of police officers for each phase as needed.
- Temporary Traffic Control Plan has been stamped and signed by a TN licensed Civil Engineer.

TYPE	YEAR	PROJECT NO.	SHEET NO.
	2024	2590_00001	1

HILTON - MOTTO HOTEL BUS STOP CONSTRUCTION

INDEX OF SHEETS

SHEET TITLE	NUMBER
TITLE SHEET	1
TRAFFIC CONTROL PLANS	2-3



PROJECT LOCATION

N.T.S.



SPECIAL NOTES

THIS PROJECT TO BE CONSTRUCTED UNDER THE STANDARD SPECIFICATIONS OF THE TENNESSEE DEPARTMENT OF TRANSPORTATION DATED JANUARY 1, 2021 AND ADDITIONAL SPECIFICATIONS AND SPECIAL PROVISIONS CONTAINED IN THE PLANS AND IN THE PROPOSAL CONTRACT.

DESIGNED BY: JEFFERY A. MESSENGER, P.E.
 DESIGNER: JEFFERY A. MESSENGER, P.E. CHECKED BY TRAVIS BONAR, P.E.
 P.E. NO. 126339

\$\$\$\$\$TIMES\$\$\$\$\$
 \$\$\$SDGN SPECOC\$\$\$

TYPE	YEAR	PROJECT NO.	SHEET NO.
	2024	2590_00001	2

PHASE 1

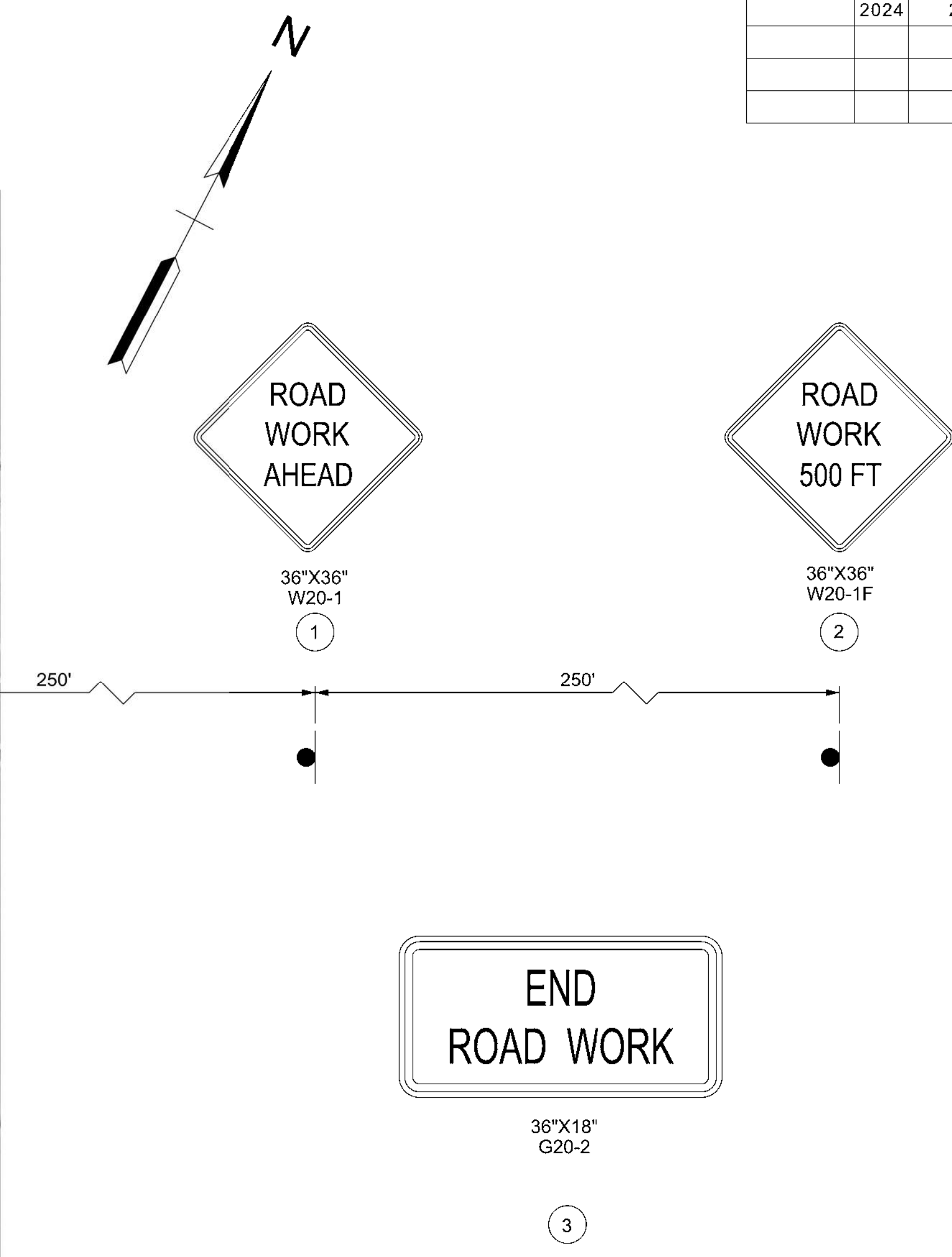
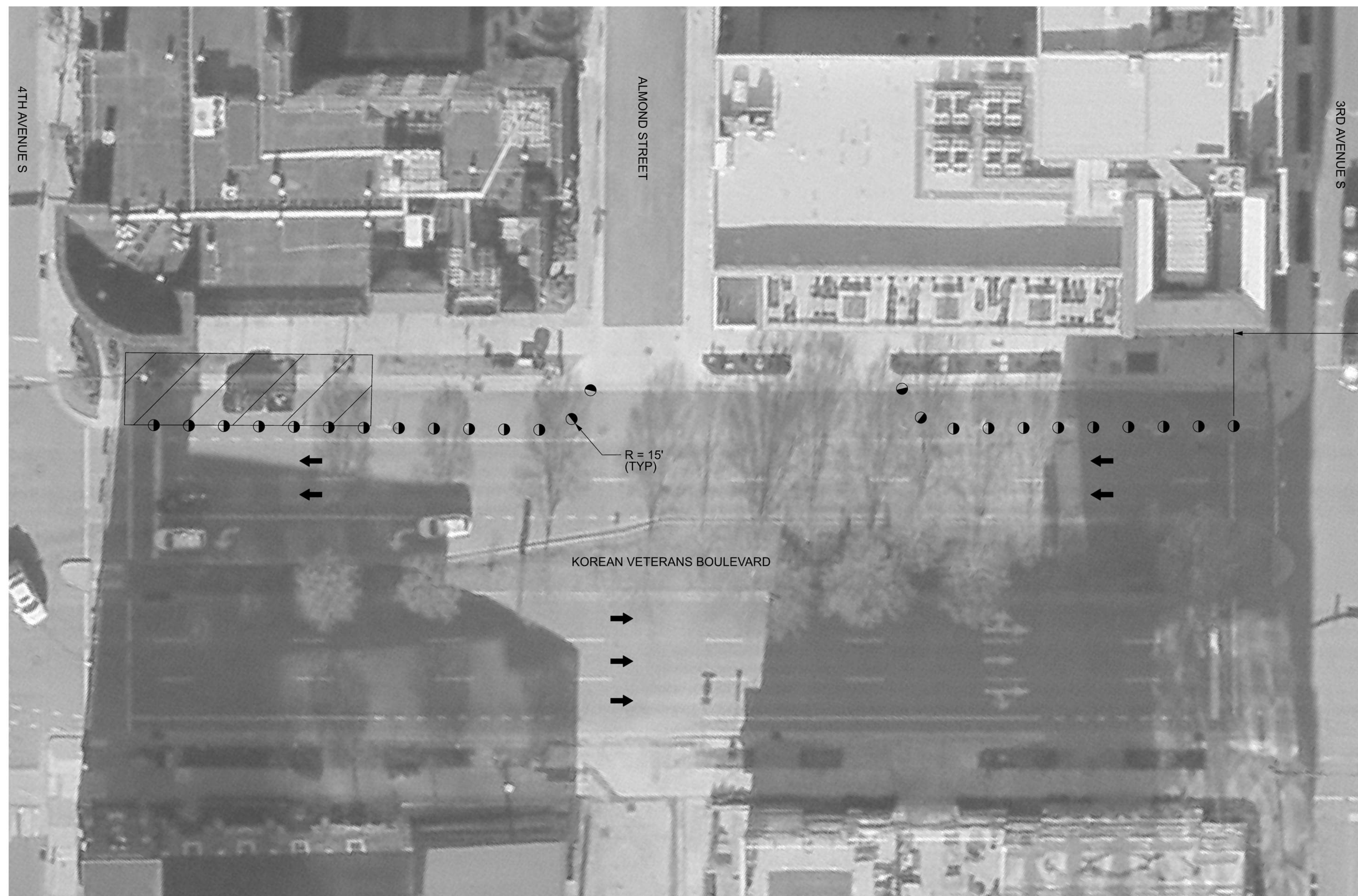

NOTES:

THIS PHASE WILL BE USED FOR THE MAJORITY OF THE PROJECT TO CONSTRUCT THE BUS STOP. ALL TRAVEL LANES AND A MINIMUM 6' WALKWAY WILL BE MAINTAINED AT ALL TIMES.

1. MAINTAIN FULL SIDEWALK WIDTH WHEN WORK IS NOT BEING PERFORMED.
2. WHEN PORTIONS OF THE SIDEWALK ARE CLOSED TO PERFORM WORK, UTILIZE CONES OR DRUMS TO CHANNELIZE PEDESTRIANS.
3. WORK SHALL DO NOT ENCROACH INTO THE CROSSWALKS.
4. COORDINATE WORK ZONE ON ALMOND STREET WITH MOTTO HOTEL WORK.
5. PLACE SIGN 3 200' PAST THE WORK ZONE.

TRAFFIC CONTROL LEGEND	
SYMBOL	ITEM
	WORK ZONE
	SIGN (CONSTRUCTION)
	TRAFFIC FLOW
	CHANNELIZING DEVICES @ 10' O/C

\$\$\$\$SYTIME\$\$\$\$
 \$\$\$SDGN SPECOC\$\$\$
 \$\$\$SYTIME\$\$\$\$

PHASE 2

TYPE	YEAR	PROJECT NO.	SHEET NO.
	2024	2590_00001	3

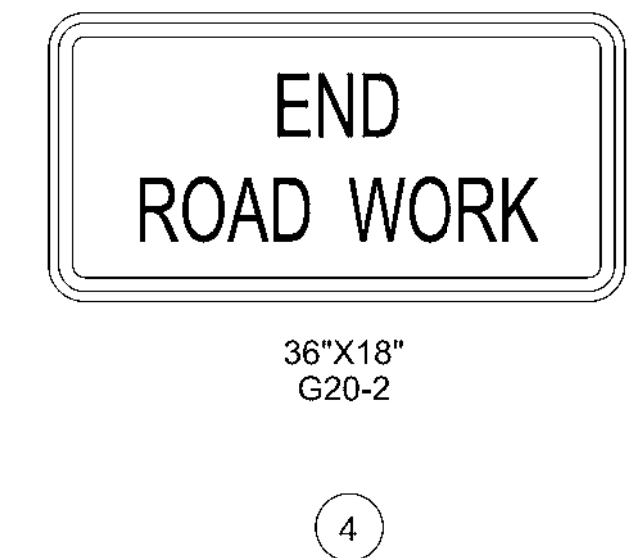
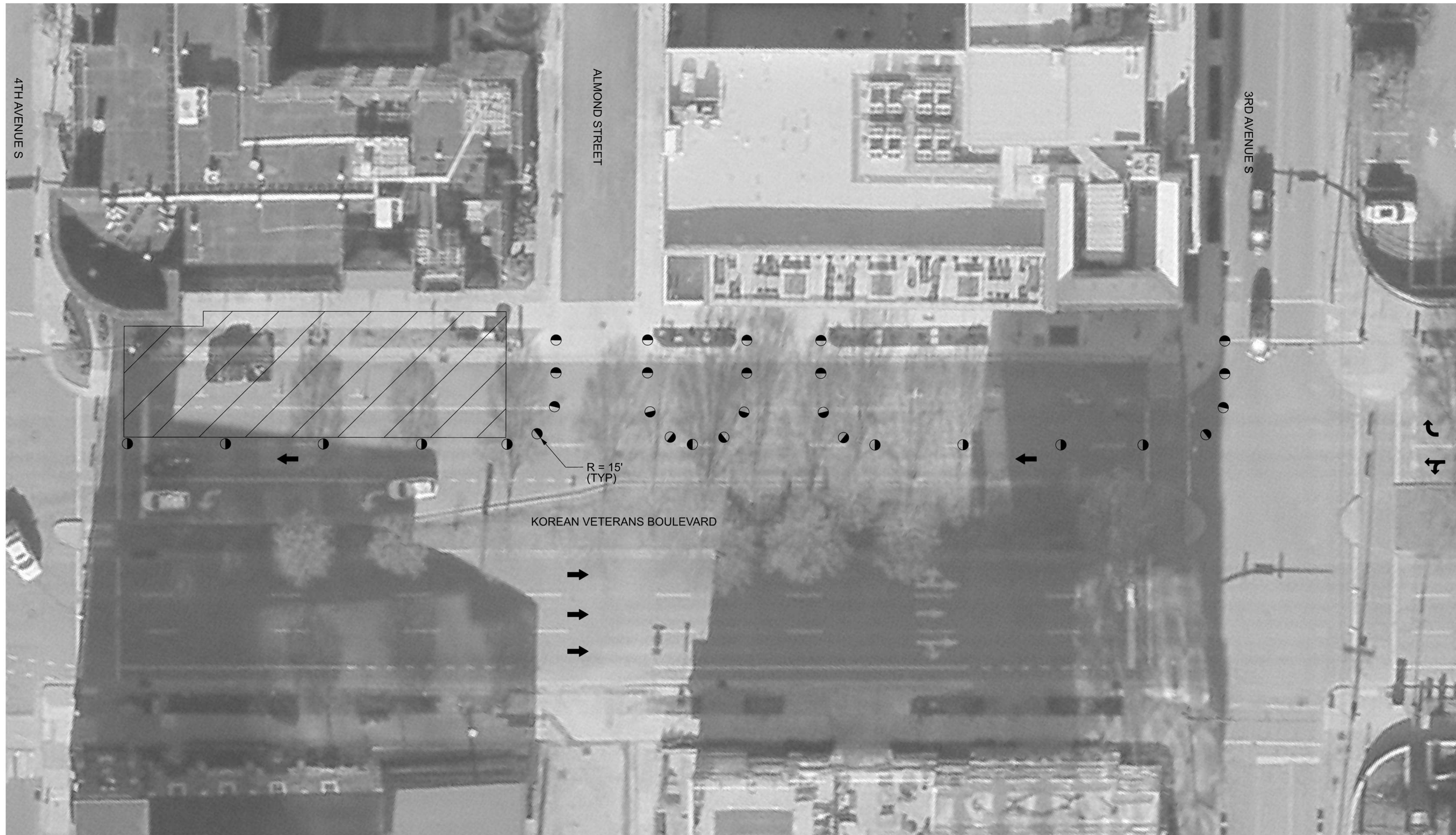
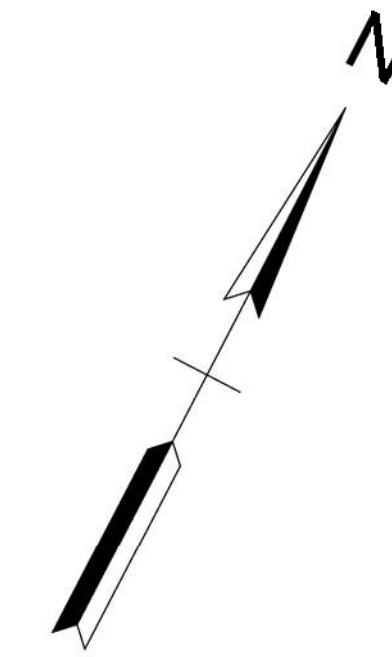

NOTES:

THIS PHASE WILL ONLY BE CONCRETE POURS ARE TAKING PLACE AT THE BUS STOP. MAINTAIN A MINIMUM 6' ADA COMPLIANT WALKWAY AT ALL TIMES.

1. WHEN PORTIONS OF THE SIDEWALK ARE CLOSED TO PERFORM WORK, UTILIZE CONES OR DRUMS TO CHANNELIZE PEDESTRIANS.
2. WORK SHALL DO NOT ENCROACH INTO THE CROSSWALKS.
3. COORDINATE WORK ZONE ON ALMOND STREET WITH MOTTO HOTEL WORK.
4. PLACE SIGN 1 100' PRIOR TO THE WORK ZONE.
5. PLACE SIGN 2 200' PRIOR TO THE INTERSECTION.
6. PLACE SIGN 3 400' PRIOR TO THE INTERSECTION.
7. PLACE SIGN 4 200' PAST THE WORK ZONE.
8. PLACE CHANNELIZING DEVICES AT 30' O/C IN THE TANGENTS AND 10' O/C IN THE CURVES.

TRAFFIC CONTROL LEGEND	
SYMBOL	ITEM
	WORK ZONE
	SIGN (CONSTRUCTION)
	TRAFFIC FLOW
	CHANNELIZING DEVICES

\$\$\$\$SYTIME\$\$\$\$
 \$\$\$SDGN\$PECOC\$\$\$\$
 \$\$\$SYTIME\$\$\$\$