

MULTIMODAL ACCESS CLOSURE EXCEPTION APPLICATION FORM AND CHECKLIST

Submittal Date: 10/3/2024 New Submittal Re-Submittal No: _____

Related Building Permit No: _____

Project Name: CANOPY-HOMEWOOD SUITES

Street Name Location: 910 DIVISION ST

Between: OVERTON ST And: 9TH AVE S

Applicant Name: YATES CONSTRUCTION

Address: 22 CENTURY BLVD STE. 140 NASHVILLE, TN 37214

Phone: 629-246-4721 Fax: _____ Contact: TIM TYLER

Email: TTYLER@WGYATES.COM

Project Description: DEMO AND REPLACE SIDEWALK AND CURB AND GUTTER

Start Date: ASAP End Date: ASAP Project Length: 5 WEEKS

Describe Type of Closure: WEEKS 1-3: COMBINE PEDESTRIAN AND BIKE LANE TRAFFIC INTO THE BIKE LANE ON DIVISION ST TO DEMO EXISTING SIDEWALK AND EXCAVATE FOR SILVA CELLS. WEEK 4: RE-ROUTE TRAFFIC TO SOUTH SIDE OF DIVISION ST TO DEMO EXISTING CURB AND GUTTER AND REPLACE WITH NEW. WEEK 5: SAME AS WEEKS 1-3, TRAFFIC CAN USE THE BIKE LANE WHILE WE PLACE NEW SIDEWALKS.

Provide Reasons why Project cannot be completed without closures and what other options were considered (attach documents as needed): IS IT NOT FEASIBLE FOR PEDESTRIANS TO UTILIZE THE SIDEWALK WHILE WE ARE DEMOLISHING EXISTING AND EXCAVATING 4' DEEP FOR THE SILVA CELLS AND NEW TREES. WE ALSO HAVE TO REPLACE CURB AND GUTTER WHICH WOULD MAKE THE BIKE LANE UNUSABLE FOR APPROXIMATELY ONE WEEK.

PROJECT INFORMATION CHECKLIST:

Included Not Applicable

- | | | |
|-------------------------------------|-------------------------------------|--|
| <input checked="" type="checkbox"/> | <input type="checkbox"/> | Project Vicinity Map with Project Area shown, street names, property information, existing pavement and striping, gutter and building locations, north arrow, and scale. |
| <input checked="" type="checkbox"/> | <input type="checkbox"/> | Planned work hours included. |
| <input type="checkbox"/> | <input checked="" type="checkbox"/> | Exact location and dimensions of the construction work zone shown. |
| <input checked="" type="checkbox"/> | <input type="checkbox"/> | If multiple phases are necessary, include perimeter impact of each phase, phase number, anticipated work hours and phase duration. |
| <input type="checkbox"/> | <input checked="" type="checkbox"/> | Details on construction activity and equipment being used as part of construction included for each phase. |
| <input type="checkbox"/> | <input checked="" type="checkbox"/> | Specify if any on-street parking, and/or metered parking, is to be restricted and if bus zone will need to be relocated. |
| <input type="checkbox"/> | <input checked="" type="checkbox"/> | Specify if trash pickup will be impacted. |
| <input type="checkbox"/> | <input checked="" type="checkbox"/> | Provide information on all utility work and utility connections. |
| <input type="checkbox"/> | <input checked="" type="checkbox"/> | List all affected residents, businesses, agencies, and schools and any conversations/agreements taken place. |
| <input type="checkbox"/> | <input checked="" type="checkbox"/> | Show ongoing construction projects within vicinity of proposed project impact. |
| <input type="checkbox"/> | <input checked="" type="checkbox"/> | Provide plan to address conflicts with other nearby projects. |
| <input checked="" type="checkbox"/> | <input type="checkbox"/> | Provide traffic control plan for each phase of construction (see traffic control checklist for more information). |
| <input type="checkbox"/> | <input checked="" type="checkbox"/> | Provide information on work vehicle parking locations. |
| <input type="checkbox"/> | <input checked="" type="checkbox"/> | Show construction trucks ingress/egress to project location. |
| <input type="checkbox"/> | <input checked="" type="checkbox"/> | Provide information on any traffic signals, traffic signal loops, and traffic signal cabinets in close proximity to project. |

TRAFFIC CONTROL PLAN CHECKLIST:

Included Not Applicable

- All temporary traffic control plans shall be designed in accordance with the most recent ADA regulations and requirements of the Manual of Uniform Traffic Control Devices.
- Clearly show the locations of all existing signs (including speed limit) as well as the proposed signs for each construction phase.
- Show the location of all existing pedestrian paths and pedestrian detour route of each stage of construction.
- Show dimensions of travel lane width, shoulder width, sidewalk of each phase, and overall roadway width along the length of affected area.
- Show all existing striping and markings to remain, to be removed, and all proposed striping and markings for each construction stage.
- Provide detour plan clearly showing detour route for any roadway or pedestrian/bike path closures.
- Specify placement of all temporary traffic control devices.
- Specify spacing of all temporary traffic control devices.
- Show all existing traffic signals and streetlights in the work zone location.
- Lighting provided for all pedestrian detour routes.
- Provide minimum eleven (11) foot travel lanes at all times.
- Show size, height, and location of all channelizing devices, warning lights, flag trees, barriers, etc.
- Label all taper lengths and widths.
- Provide locations of police officers for each phase as needed.
- Temporary Traffic Control Plan has been stamped and signed by a TN licensed Civil Engineer.

INDEX

SHEET NO.	SHEET NAME
1	TITLE SHEET & INDEX
2	GENERAL NOTES & STANDARD DRAWINGS
3-3A	TRAFFIC CONTROL PLAN
4-4A	PEDESTRIAN DETOUR ROUTE

TRAFFIC CONTROL PLANS

NASHVILLE CANOPY FOR TARA OF THE GULCH

FILE NO.	COVER.SHT
DATE:	10-03-2024
DESIGNED BY:	JSB
DRAWN BY:	JCB
CHECKED BY:	SM
REVISION BLOCK	
DATE:	
DATE:	
DATE:	

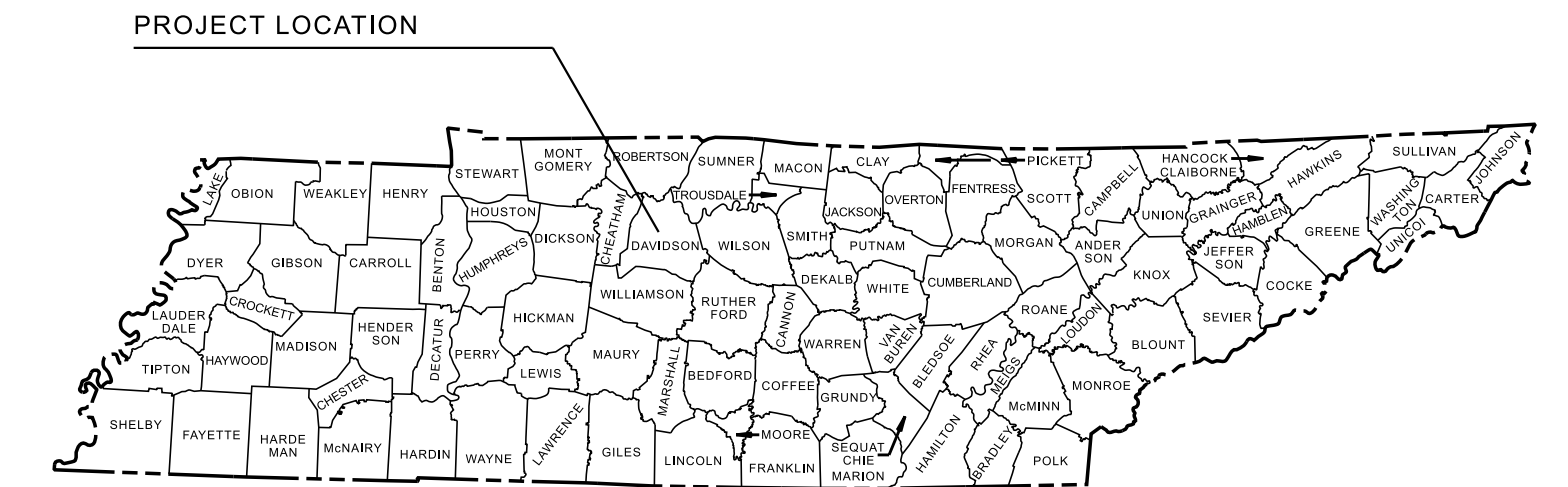

PROJECT LOCATION

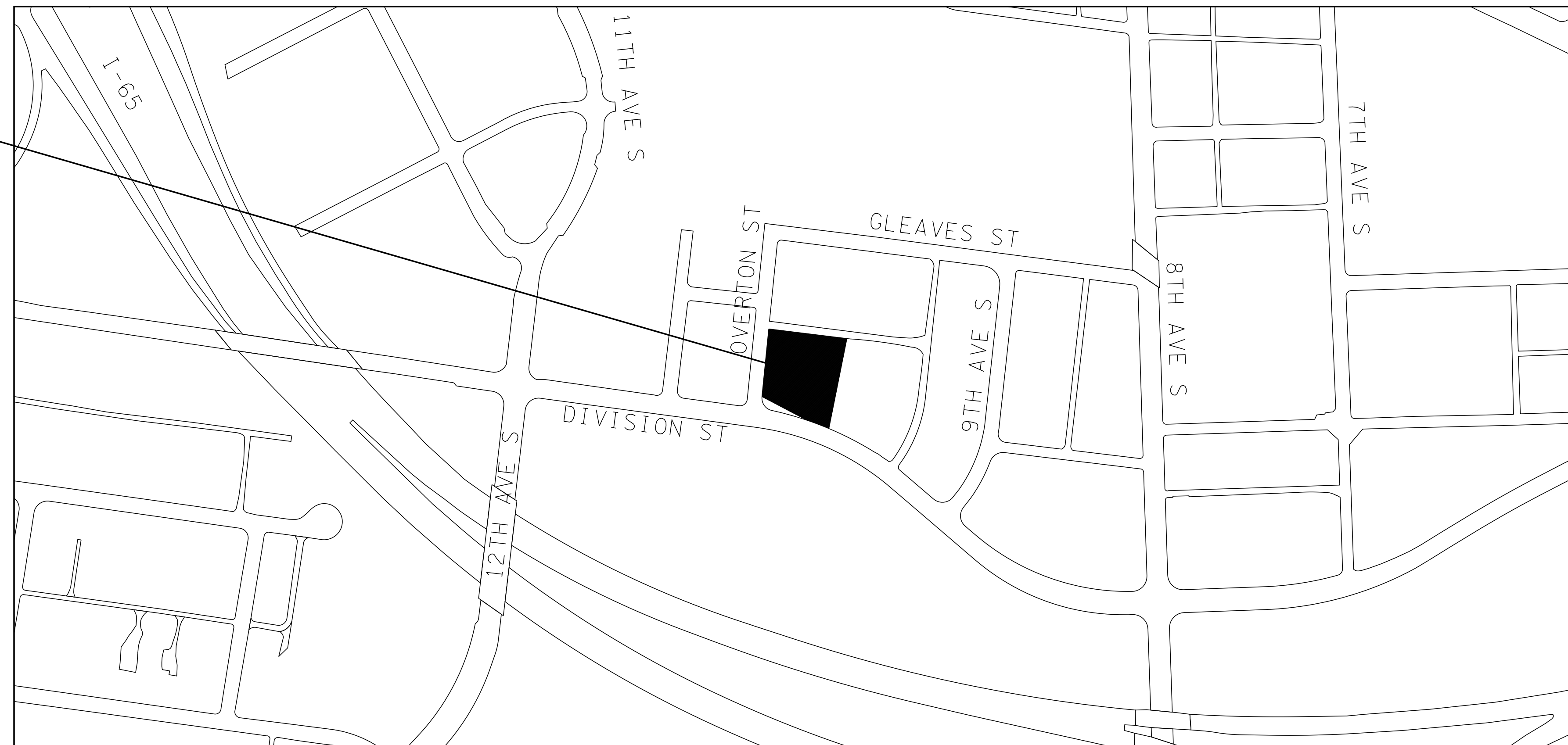

SCALE: 1"=200'

SPECIAL NOTES

THIS PROJECT TO BE CONSTRUCTED UNDER THE STANDARD SPECIFICATIONS OF THE TENNESSEE DEPARTMENT OF TRANSPORTATION DATED JANUARY 1, 2021, AND ADDITIONAL SPECIFICATIONS AND SPECIAL PROVISIONS CONTAINED IN THE PLANS AND IN THE CONTRACT.

ALL CONSTRUCTION ACTIVITIES SHALL BE COMPLETED IN FULL COMPLIANCE WITH THE AMERICANS WITH DISABILITIES ACT (ADA) AND ARCHITECTURAL AND TRANSPORTATION BARRIERS COMPLIANCE BOARD, FEDERAL REGISTER 36CFR PART 1191, ACCESSIBILITY GUIDELINES FOR BUILDINGS AND FACILITIES; ARCHITECTURAL BARRIERS ACT (ABA) ACCESSIBILITY GUIDELINES; PROPOSED RULE, PUBLISHED IN THE FEDERAL REGISTER ON SEPTEMBER 15, 2010, AS HAS BEEN ADOPTED BY METRO.



CONSOR ENGINEERS, LLC
101 WESTPARK DRIVE, SUITE 300
BRENTWOOD, TN 37027
(615) 425-2000

GENERAL NOTES

MISCELLANEOUS

NOTHING IN THE GENERAL NOTES OR SPECIAL PROVISIONS SHALL RELIEVE THE CONTRACTOR FROM HIS RESPONSIBILITIES TOWARD THE SAFETY AND CONVENIENCE OF THE GENERAL PUBLIC AND THE RESIDENTS ALONG THE PROPOSED CONSTRUCTION AREA.

ALL CONSTRUCTION, EQUIPMENT, AND INSTALLATION PROCEDURES SHALL COMPLY WITH THE TENNESSEE DEPARTMENT OF TRANSPORTATION (TDOT) STANDARD SPECIFICATIONS FOR ROAD AND BRIDGE CONSTRUCTION, (AS AMENDED) AND WITH THE CURRENT STANDARDS AND SPECIFICATIONS OF METRO NASHVILLE DEPARTMENT OF TRANSPORTATION. PAVEMENT MARKING REMOVAL AND TRAFFIC CONTROL SHALL COMPLY WITH SECTION 712-TEMPORARY TRAFFIC CONTROL.

ALL CONSTRUCTION ACTIVITIES SHALL BE COMPLETED IN FULL COMPLIANCE WITH THE AMERICANS WITH DISABILITIES ACT (ADA) AND ARCHITECTURAL AND TRANSPORTATION BARRIERS COMPLIANCE BOARD, FEDERAL REGISTER 36 CFR PARTS 1190 AND 1191, ACCESSIBILITY GUIDELINES FOR BUILDINGS AND FACILITIES, ARCHITECTURAL BARRIERS ACT (ABA) ACCESSIBILITY GUIDELINES, PROPOSED RULE. PUBLISHED IN THE FEDERAL REGISTER ON JULY 23, 2004, AS HAS BEEN ADOPTED BY METRO NASHVILLE DEPARTMENT OF TRANSPORTATION.

ROAD CLOSURE

NO LESS THAN SEVEN (7) DAYS PRIOR TO THE CLOSURE OF THE ROAD, THE CONTRACTOR SHALL NOTIFY THE FOLLOWING INDIVIDUALS OR AGENCIES COMPLETELY DESCRIBING THE AFFECTED ROADS AND THE APPROXIMATE DURATION OF THE CONSTRUCTION: THESE PARTIES INCLUDE, BUT ARE NOT LIMITED TO: (1) LOCAL LAW ENFORCEMENT OFFICE, (2) LOCAL FIRE DEPARTMENT, (3) AMBULANCE SERVICE, (4) LOCAL SCHOOL SUPERINTENDENT, (5) UNITED STATES POSTAL SERVICE, AND (6) PUBLIC WORKS UTILITY COORDINATOR.

EXCAVATION AND LANE CLOSURE PERMITS ARE REQUIRED FOR ALL WORK DONE WITHIN THE PUBLIC RIGHT OF WAY.

CONSTRUCTION WORK ZONE AND TRAFFIC CONTROL

ADVANCED WARNING SIGNS SHALL NOT BE DISPLAYED MORE THAN FORTY-EIGHT (48) HOURS BEFORE PHYSICAL CONSTRUCTION BEGINS. SIGNS MAY BE ERECTED UP TO ONE (1) WEEK BEFORE NEEDED, IF THE SIGN FACE IS FULLY COVERED.

IF THE CONTRACTOR MOVES OFF THE PROJECT, HE SHALL COVER OR REMOVE ALL UNNEEDED SIGNS AS DIRECTED BY THE ENGINEER.

A LONG TERM BUT SPORADIC USE WARNING SIGN, SUCH AS A FLAGGER SIGN, MAY REMAIN IN PLACE WHEN NOT REQUIRED PROVIDED THE SIGN FACE IS FULLY COVERED.

TRAFFIC CONTROL DEVICES SHALL NOT BE DISPLAYED OR ERECTED UNLESS RELATED CONDITIONS ARE PRESENT NECESSITATING WARNING.

USE OF BARRICADES, PORTABLE BARRIER RAILS, VERTICAL PANELS, AND DRUMS SHALL BE LIMITED TO THE IMMEDIATE AREAS OF CONSTRUCTION WHERE A HAZARD IS PRESENT. THESE DEVICES SHALL NOT BE STORED ALONG THE ROADWAY WITHIN THIRTY (30) FEET OF THE EDGE OF THE TRAVELED WAY OR AFTER USE UNLESS PROTECTED BY GUARDRAIL, BRIDGE RAIL, AND/OR BARRIERS INSTALLED FOR OTHER PURPOSES. THESE DEVICES SHALL BE REMOVED FROM THE CONSTRUCTION WORK ZONE WHEN THE ENGINEER DETERMINES THEY ARE NO LONGER NEEDED.

ALL DETOUR AND CONSTRUCTION SIGNING SHALL BE IN STRICT ACCORDANCE WITH THE MANUAL ON UNIFORM TRAFFIC CONTROL DEVICES.

ALL DETOURS SHALL BE PAVED, STRIPED, SIGNED, AND THE VERTICAL PANELS ARE TO BE IN PLACE BEFORE IT IS OPENED TO TRAFFIC.

THE CONTRACTOR SHALL NOT BE PERMITTED TO PARK ANY VEHICLES OR CONSTRUCTION EQUIPMENT DURING PERIODS OF INACTIVITY, WITHIN THIRTY (30) FEET OF THE EDGE OF PAVEMENT WHEN THE LANE IS OPEN TO TRAFFIC, UNLESS PROTECTED BY GUARDRAIL, BRIDGE RAIL, AND/OR BARRIERS INSTALLED FOR OTHER PURPOSES. PRIVATELY OWNED VEHICLES SHALL NOT BE ALLOWED TO BE PARKED WITHIN (30) FEET OF AN OPEN TRAFFIC LANE AT ANY TIME UNLESS PROTECTED AS DESCRIBED ABOVE. WHERE THERE IS INSUFFICIENT RIGHT-OF-WAY TO PROVIDE FOR THIS THIRTY (30) FOOT SETBACK, THE CONTRACTOR SHALL DETERMINE THE ALTERNATE LOCATIONS AND REQUEST THE ENGINEER'S APPROVAL TO USE THEM.

CONTRACTOR SHALL MAINTAIN ACCESS FOR ALL LOCAL TRAFFIC THROUGHOUT CONSTRUCTION.

ALL SIGNS, BARRICADES, AND LIGHTS SHALL BE MAINTAINED IN ORDER TO PROVIDE FOR PUBLIC SAFETY AT ALL TIMES.



ADA COMPLIANCE

ALL DESIGN AND CONSTRUCTION ACTIVITIES SHALL BE COMPLETED IN FULL COMPLIANCE WITH THE AMERICANS WITH DISABILITIES ACT ("ADA"), 2010 STANDARDS FOR ACCESSIBLE DESIGN, AS HAS BEEN ADOPTED BY METRO.

PAVEMENT MARKINGS

TEMPORARY PAVEMENT LINE MARKINGS ON INTERMEDIATE LAYERS OF PAVEMENT SHALL BE REFLECTIVE TAPE OR REFLECTORIZED PAINT INSTALLED TO PERMANENT STANDARDS AT THE END OF EACH DAYS WORK. SHORT, UNMARKED SECTIONS SHALL NOT BE ALLOWED.

LEGEND

	PROPOSED ONE SIDED SIGN
	PROPOSED TYPE III BARRICADE WITH SIGN
	PROPOSED PORTABLE CONCRETE BARRICADE
SDWL	SINGLE DOTTED WHITE LINE

STANDARD ROADWAY DRAWINGS (TDOT)

DRAWING NO. (TDOT)	CURRENT REVISION DATE	STANDARD TITLE (TDOT)
		MULTIMODAL
MM-CR-1	06-28-19	DETECTABLE WARNING SURFACE PLACEMENT ON CURB RAMPS
MM-CR-3	01-07-19	PARALLEL CURB RAMP
MM-SW-1	07-07-23	DETAILS FOR CONCRETE SIDEWALK
		TRAFFIC CONTROL APPURTENANCES
T-S-10	04-04-12	STANDARD MOUNTING DETAILS - FLAT SHEET SIGNS, ALUMINUM - STEEL DESIGN
T-S-16	07-02-15	GROUND MOUNTED ROADSIDE SIGN AND DETAILS
T-S-20	07-11-17	SIGN DETAILS
		DESIGN - TRAFFIC CONTROL
T-M-4	07-17-20	STANDARD INTERSECTION PAVEMENT MARKINGS
T-WZ-55	10-29-21	SIDEWALK TRAFFIC CONTROL
T-WZ-PBR2	02-28-20	DETAILS FOR WORK ZONE CHANNELIZATION DEVICES
T-WZ-PCB3	01-28-22	PORTABLE CONCRETE BARRIER RAIL DETAILS
		ROADWAY AND PAVEMENT APPURTENANCES
RP-VC-10	03-04-21	VERTICAL CONCRETE CURBS AND CONCRETE CURBS AND GUTTERS

FILE NO.	
DATE:	10-03-2024
DESIGNED BY:	JSB
DRAWN BY:	JCB
CHECKED BY:	SM

REVISION BLOCK

DATE:	
DATE:	
DATE:	

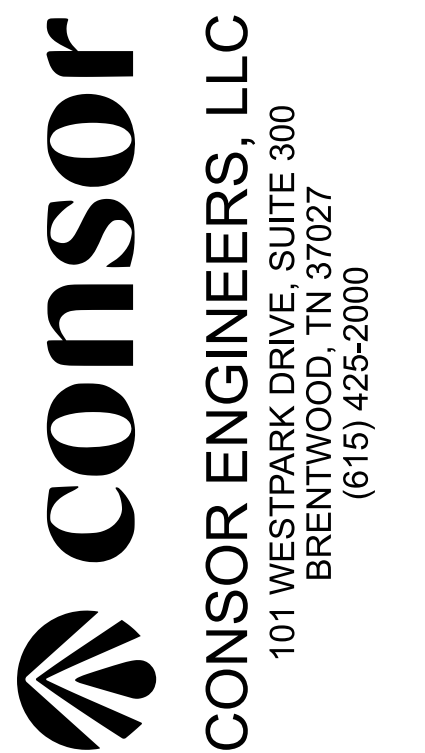

SEALED BY

NASHVILLE
CANOPY

GENERAL NOTES &
STANDARD DRAWINGS

SCALE: N.T.S.

SHEET 2 OF 4

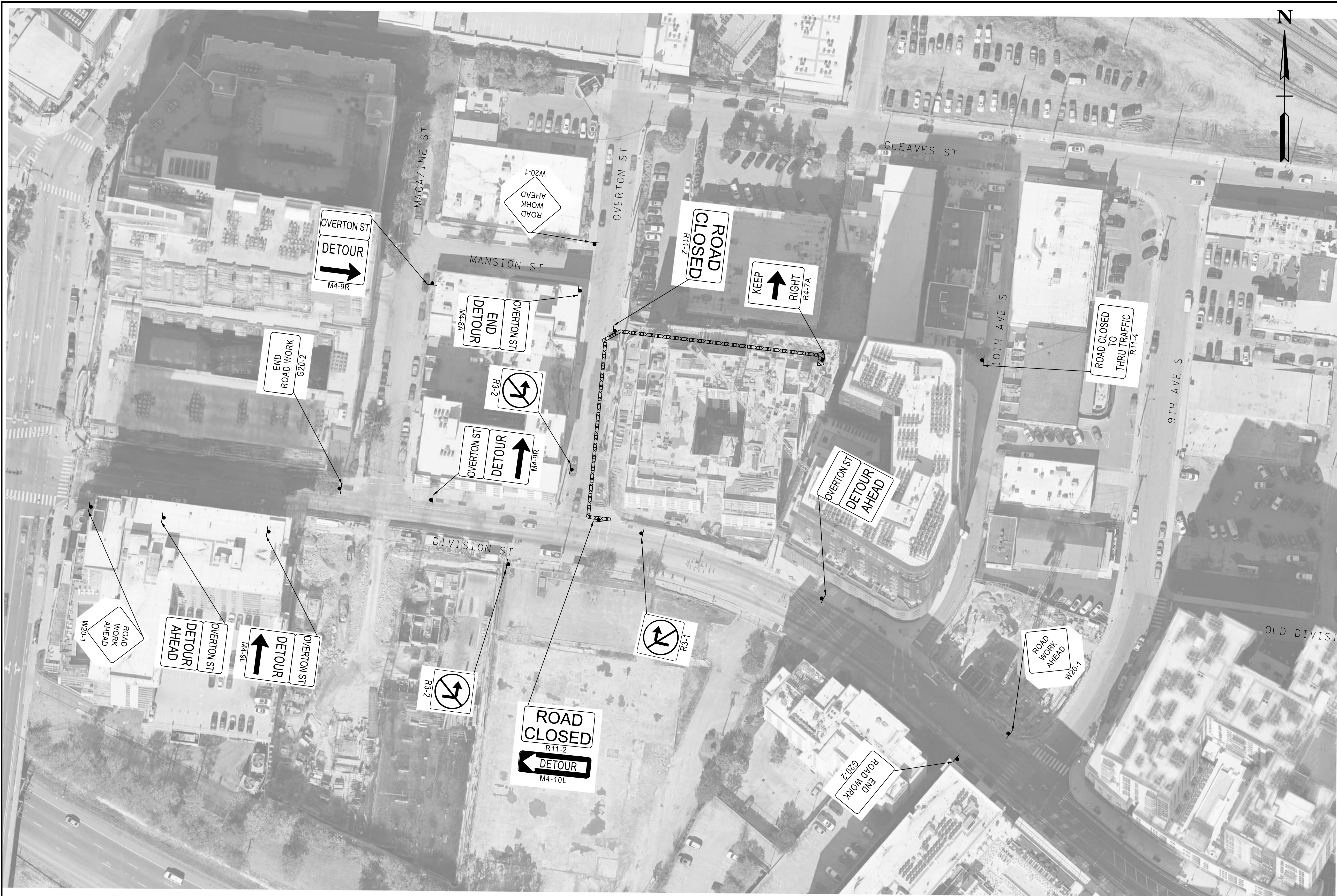

FILE NO.	
DATE:	10-03-2024
DESIGNED BY:	JSB
DRAWN BY:	JCB
CHECKED BY:	SM
REVISION BLOCK	
DATE:	
DATE:	
DATE:	

consor
CONSOR ENGINEERS, LLC
 101 WESTPARK DRIVE, SUITE 300
 BRENTWOOD, TN 37027
 (615) 425-2000

SEALED BY

NASHVILLE
 CANOPY

TRAFFIC
 CONTROL PLAN
 PHASE 1

SCALE: 1" = 50'

SHEET 3 OF 4

NOTES:
 • COORDINATE TRAFFIC CONTROL SIGNS WITH ANY OTHER PROJECTS ALONG DIVISION STREET.



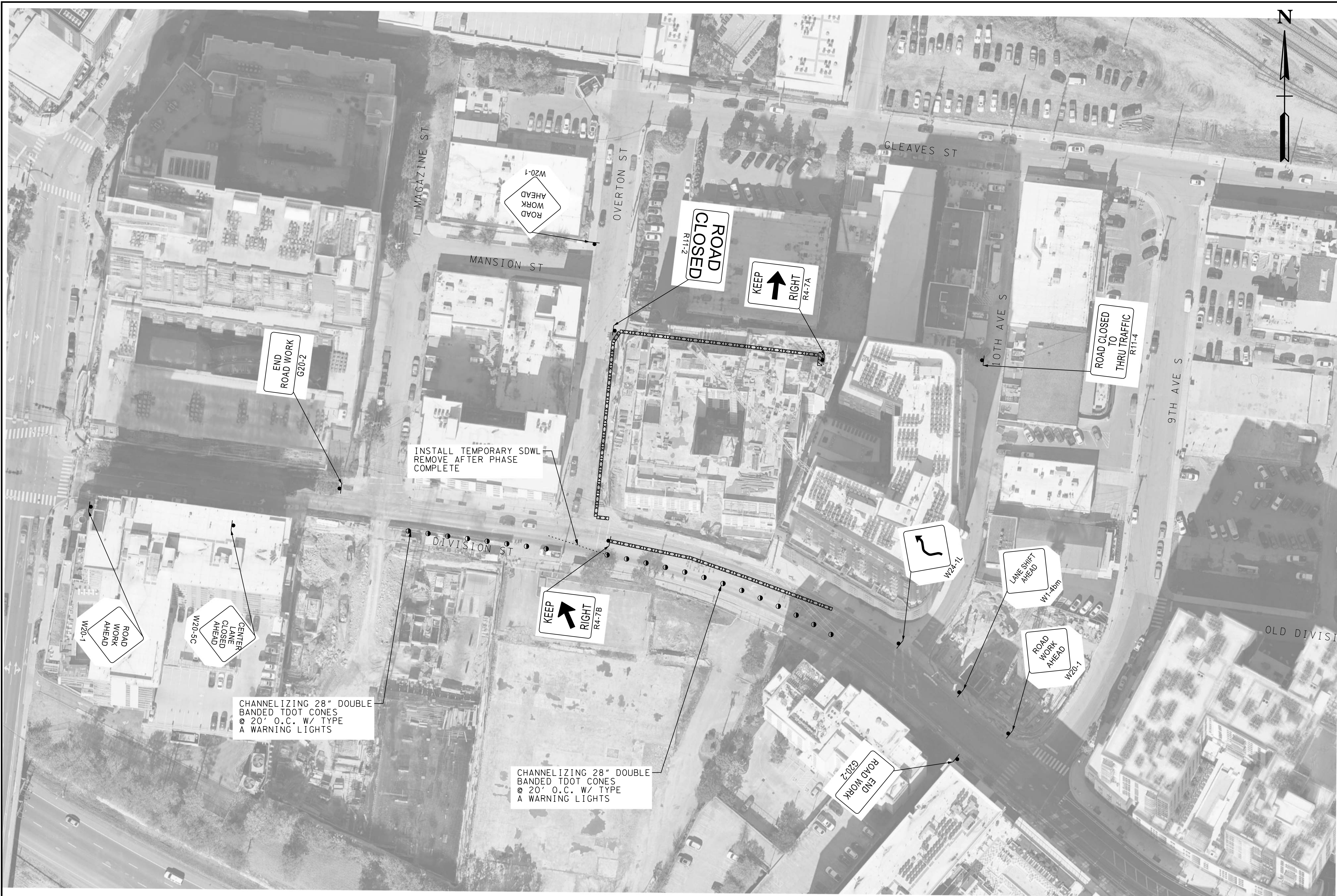

FILE NO.	
DATE:	10-03-2024
DESIGNED BY:	JSB
DRAWN BY:	JCB
CHECKED BY:	SM
REVISION BLOCK	
DATE:	
DATE:	
DATE:	

consor
CONSOR ENGINEERS, LLC
 101 WESTPARK DRIVE, SUITE 300
 BRENTWOOD, TN 37027
 (615) 425-2000

SEALED BY

NASHVILLE
 CANOPY

TRAFFIC
 CONTROL PLAN
 PHASE 2

SCALE: 1" = 50'

SHEET 3A OF 4

NOTES:
 • COORDINATE TRAFFIC CONTROL SIGNS WITH ANY OTHER PROJECTS ALONG DIVISION STREET.



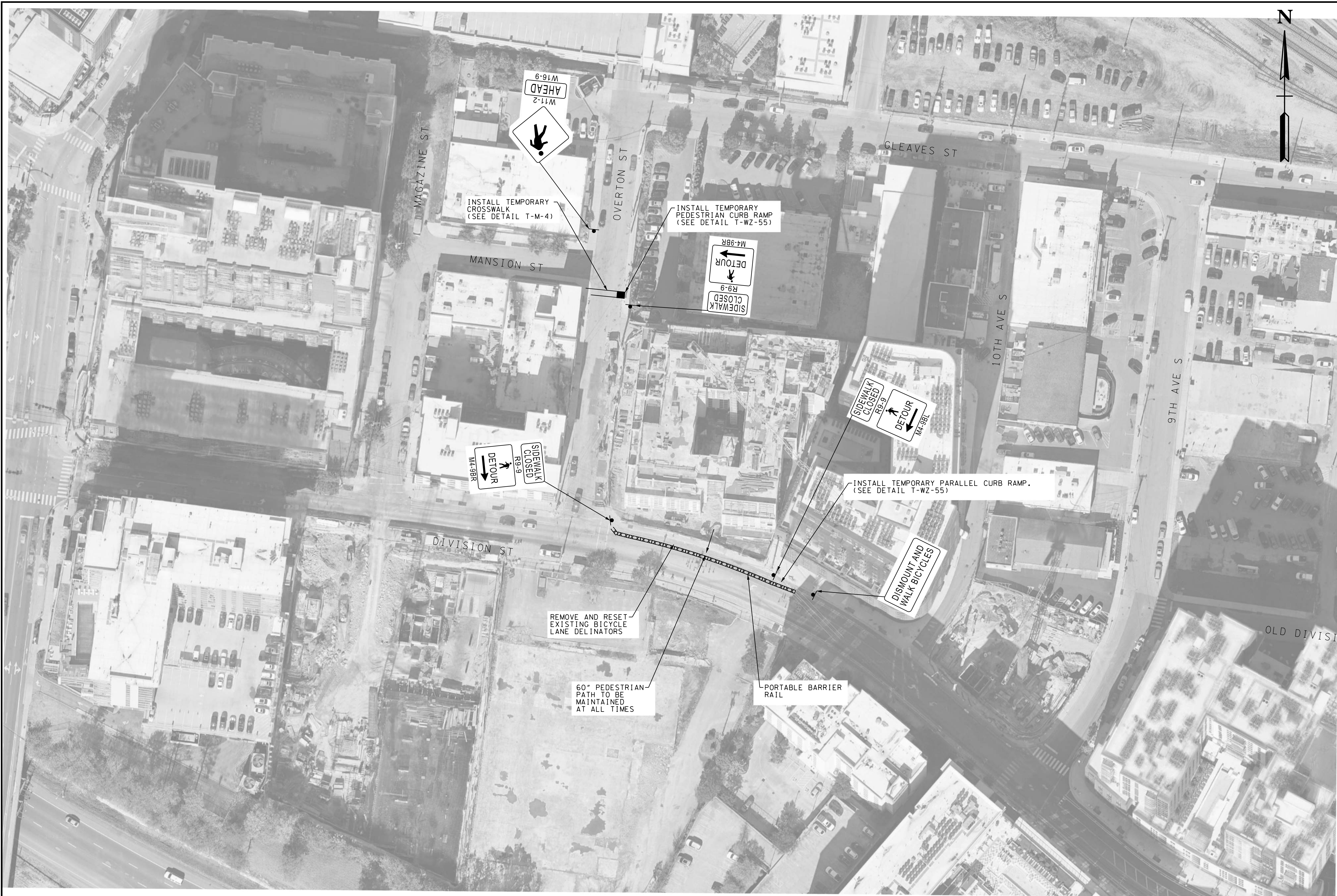

FILE NO.	
DATE:	10-03-2024
DESIGNED BY:	JSB
DRAWN BY:	JCB
CHECKED BY:	SM
REVISION BLOCK	
DATE:	
DATE:	
DATE:	

consor
CONSOR ENGINEERS, LLC
 101 WESTPARK DRIVE, SUITE 300
 BRENTWOOD, TN 37027
 (615) 425-2000

SEALED BY

NASHVILLE
 CANOPY

PEDESTRIAN
 DETOUR ROUTE
 PHASE 1

SCALE: 1" = 50'

SHEET 4 OF 4

NOTES:
 • COORDINATE TRAFFIC CONTROL SIGNS WITH ANY OTHER PROJECTS ALONG DIVISION STREET.





NOTES:
 • COORDINATE TRAFFIC CONTROL SIGNS WITH ANY OTHER PROJECTS ALONG DIVISION STREET.



FILE NO.	
DATE:	10-03-2024
DESIGNED BY:	JSB
DRAWN BY:	JCB
CHECKED BY:	SM

REVISION BLOCK	
DATE:	
DATE:	
DATE:	

consor
 CONSOR ENGINEERS, LLC
 101 WESTPARK DRIVE, SUITE 300
 BRENTWOOD, TN 37027
 (615) 425-2000

SEALED BY

NASHVILLE
 CANOPY

PEDESTRIAN
 DETOUR ROUTE
 PHASE 2

SCALE: 1" = 50'

SHEET 4A OF 4

NASHVILLE CANOPY
 FOR
TARA OF THE GULCH
 910 DIVISION STREET, NASHVILLE, DAVIDSON COUNTY, TENNESSEE

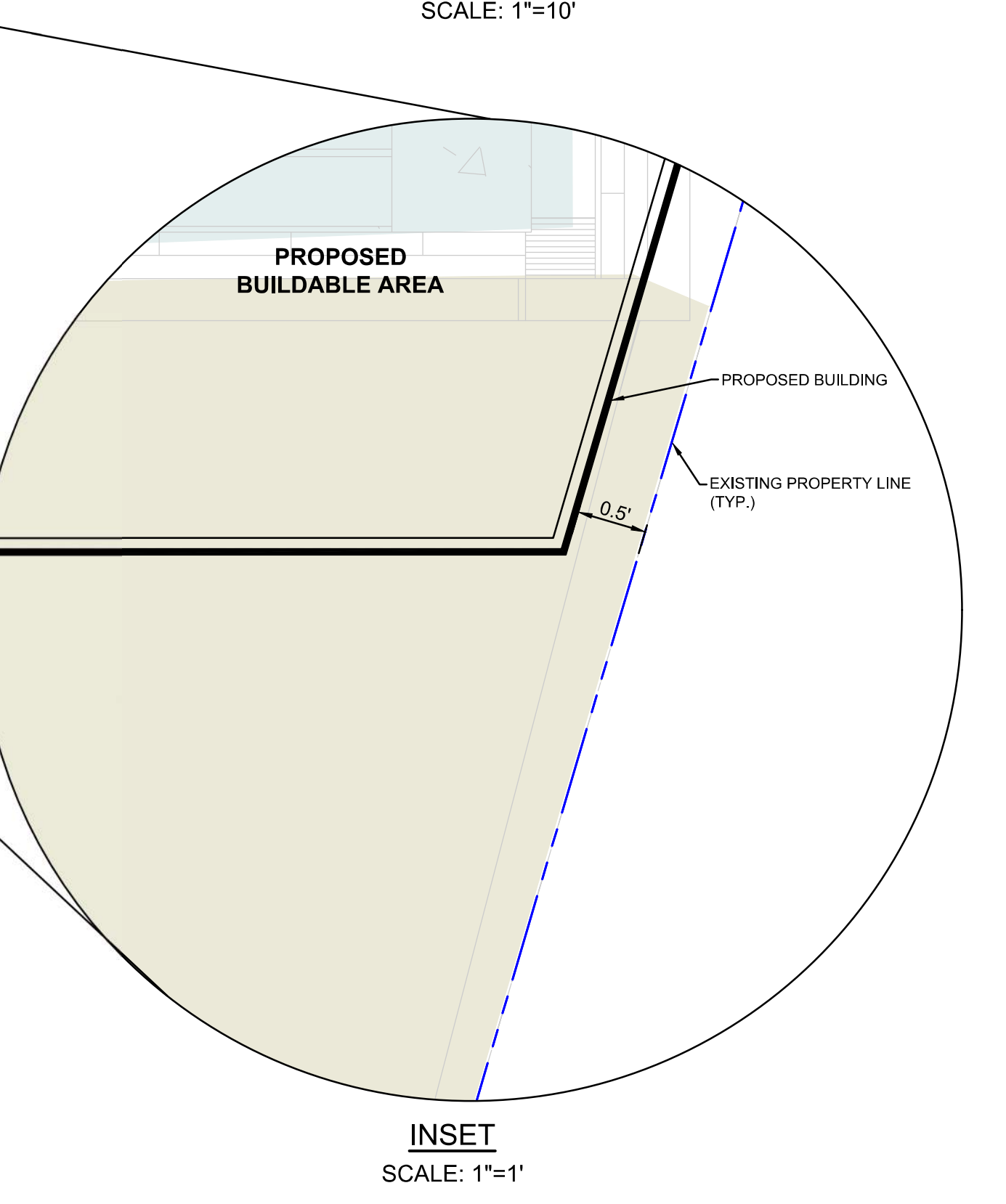
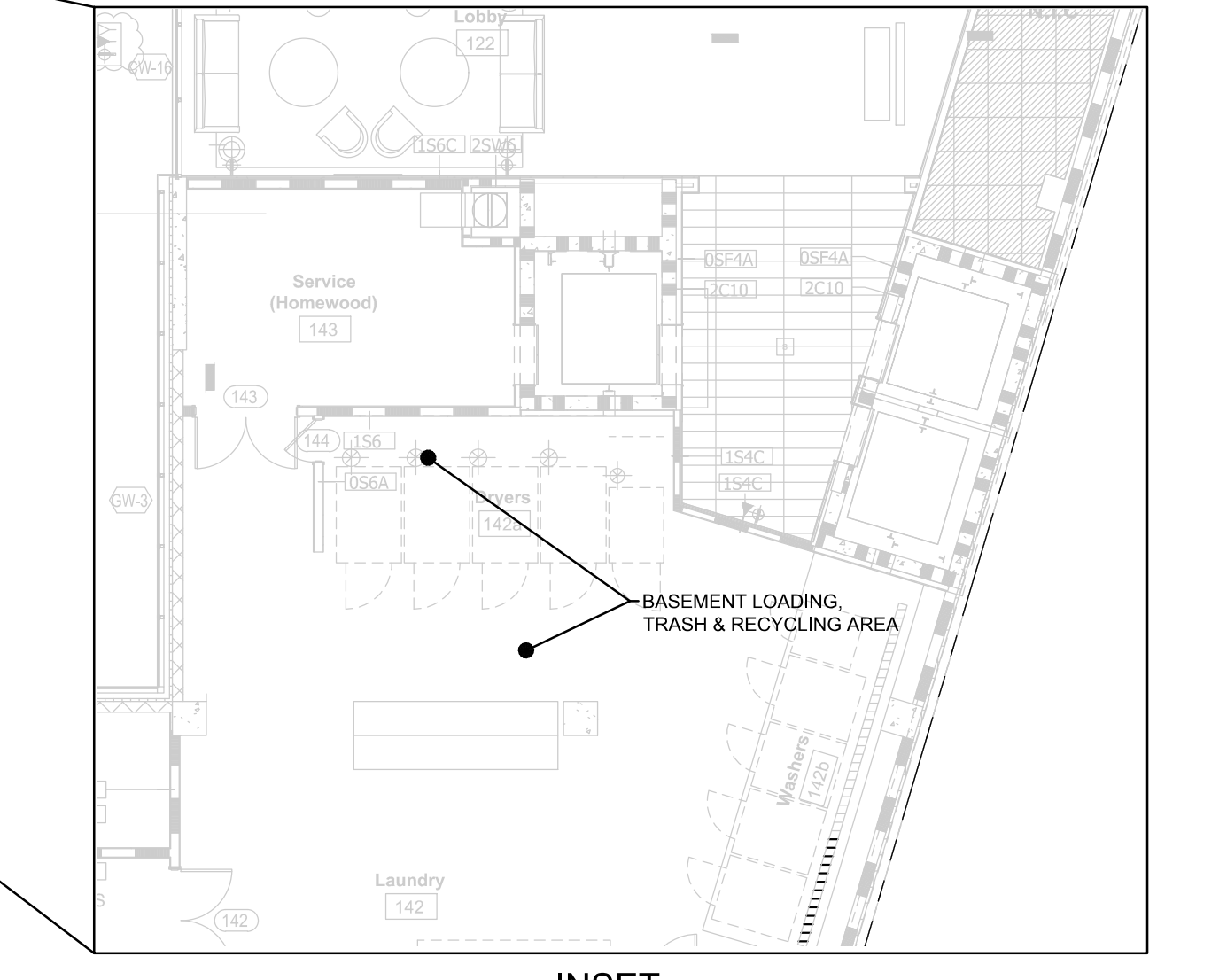
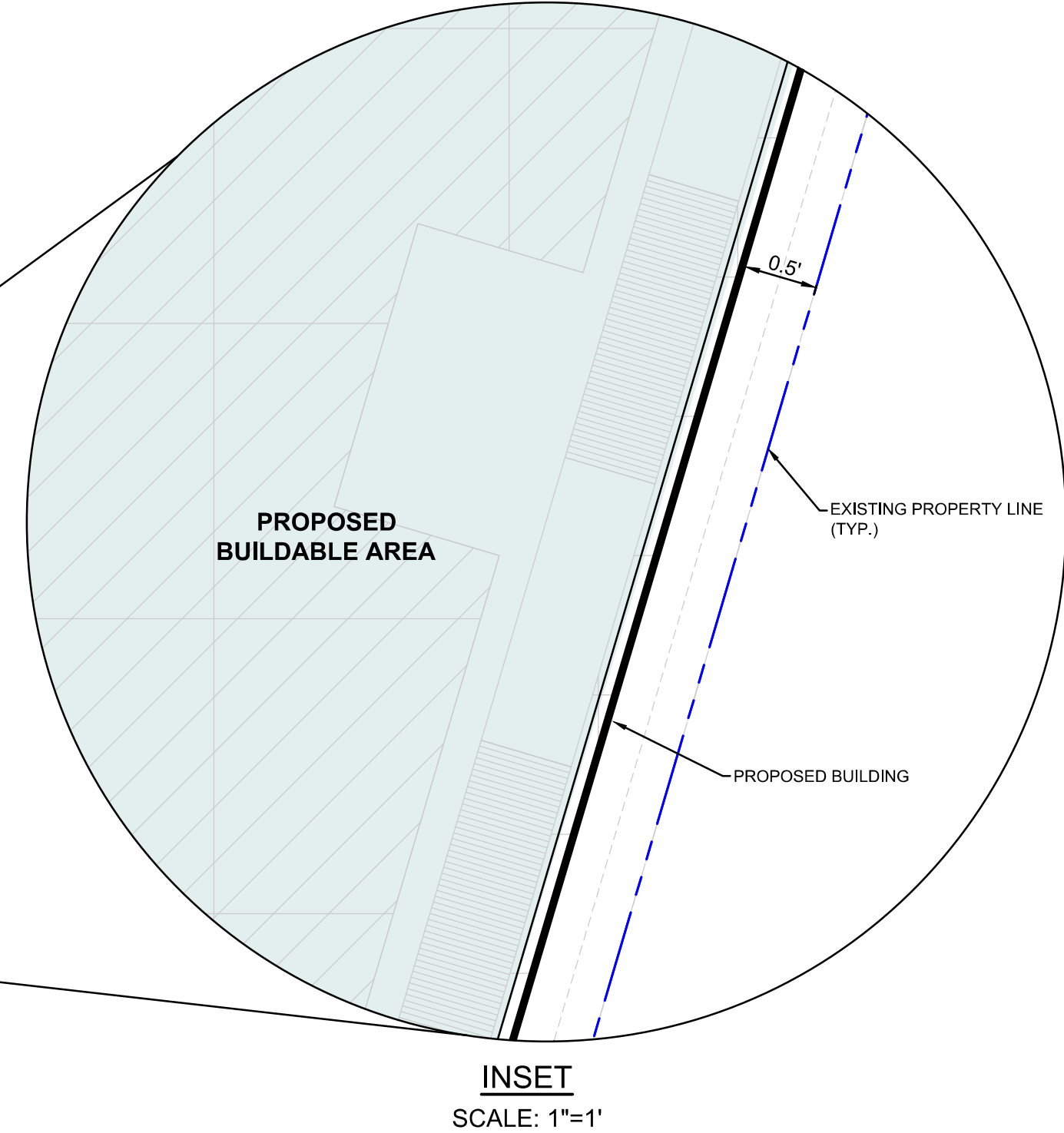
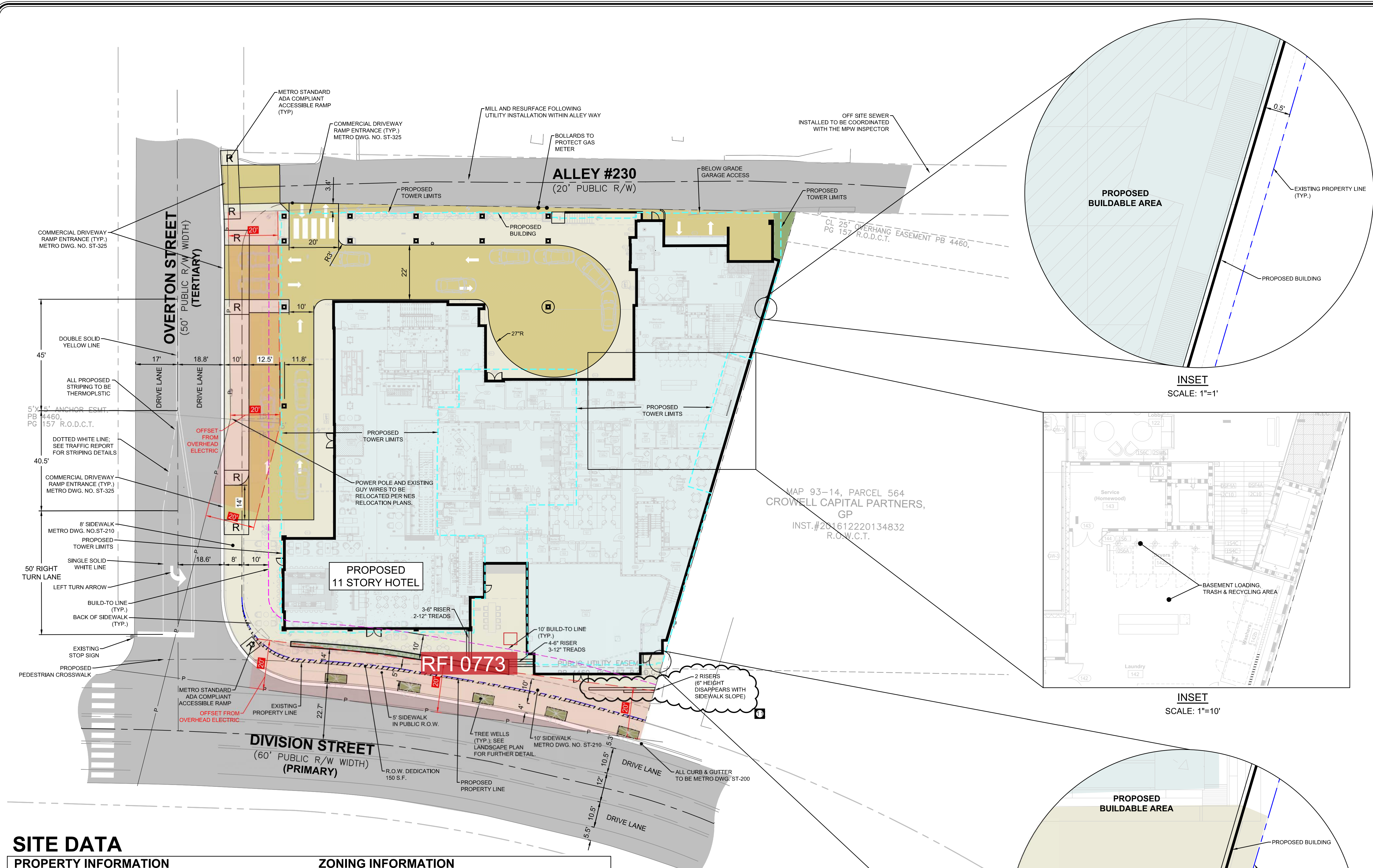

LEGEND

- CONCRETE SIDEWALK
- HARDSCAPE TRAFFIC AREAS (SEE LANDSCAPE ARCH.)
- PLANTING ZONE
- R.O.W. DEDICATION
- TOWER LIMITS
- ADA CURB RAMP

811
 Know what's below. Call before you dig.

0 20 40

North Arrow

SITE DATA

PROPERTY INFORMATION

STREET ADDRESS: 920 DIVISION STREET
 NASHVILLE, TN 37203
 PROPERTY OWNER: TARA OF THE GULCH, LLC
 8832 BLAKENEY PROFESSIONAL DR, SUITE 202
 CHARLOTTE, NC 28277-6724
 PARCEL ACREAGE: 0.86 AC
 PARCEL ID: 09314056500
 COUNCIL DISTRICT NUMBER: 19
 DISTRICT COUNCIL MEMBER: FREDDIE O'CONNELL

ZONING INFORMATION

ZONING CLASSIFICATION: DTC (Downtown Code)**
 ZONING OVERLAY DISTRICT: OV-ADE
 COMM. CHARACTER POLICY: T6-DN (Downtown Neighborhood)
 NEIGHBORHOOD: GS (Gulch South)
 FRONTAGE / BUILD-TO ZONE: 0'-10' measured from back of sidewalk or frontage zone (along both Division & Overton)
 FACADE WITHIN BUILD-TO ZONE: 80% required along Division (59% provided)**
 60% required along Overton (00% provided)**
 ** DRB Minor Modification needed

PROJECT INFORMATION

PROPOSED USE: Hotel (334 keys)
 Retail (2,510 sf)
 Restaurant (10,843 sf) (7,160 indoor + 3,683 outdoor)
 TOTAL BUILDING COVERAGE: 30,420 sf (0.70 ac)
 PARKING REQUIRED: None
 PARKING PROVIDED: 124 (Underground Garage)
 REQUIRED BICYCLE STATEMENT: based on Metro Requirements (BL2014-714)
 1 per 5,000 sf of Retail = 1 space
 4 per establishment (Restaurant) = 4 spaces
 5 spaces provided total

MIN. BUILDING DEPTH: 15' from building facade (see Architectural plans)
 BUILDING HEIGHT: 10 Stories Max. (11 Stories requested)≠
 ≠ BONUS HEIGHT PROGRAM
 Up to two (2) additional stories allowed at 1:1 ratio with proposed underground parking
 • Underground parking: 26,335 sf
 • 11th Story: 19,477 sf

WK. ORDER	NO.	WQ/DIVISION	REV.
11	03/11/22	1327	6
18025	01/08/21		

DESIGNED:	DRAWN:	SCALE:	DATE:
M. WILLIAMS	B. PATTERSON	AS NOTED	04/17/2020

DATE: 03/11/22
 DRAWN BY: J. HUNTER
 CHECKED BY: J. HUNTER
 LATE SUBMITTER: 03/11/22



ODA Architecture
 2010 South Tryon St., Suite 1a
 Charlotte, NC, 28203
 704.332.1615
 www.oda.us.com

SEAL:

CONSULTANT:



6 Custom Mill Ct.
 Greenville SC 29609
 864-412-7712
 www.sextond.com

**Canopy / Homewood
 The Gulch**

910 Division Street
 Nashville, TN 37203
 ODA Project No. 183270

For Construction

06.26.2020

REVISIONS		
No.	Description	Date
1	PRICING REVISION 1	07.17.2020
2	TITLEBLOCK REVISION	07.28.2020
3	PLAN REVIEW COMMENTS	04.15.2021
14	RFI RESPONSE	07.01.2022
15	LANDSCAPE SET REVISIONS IRRIGATION PLANS ADD.	10.04.2022
16	LANDSCAPE SET REVISIONS	04.25.2024

**LANDSCAPE:
 FIRST FLOOR
 MATERIALS PLAN**

L-101.0

© Copyright 2020 ODA Architecture

**ALLEY #230
 (20' PUBLIC R/W)**

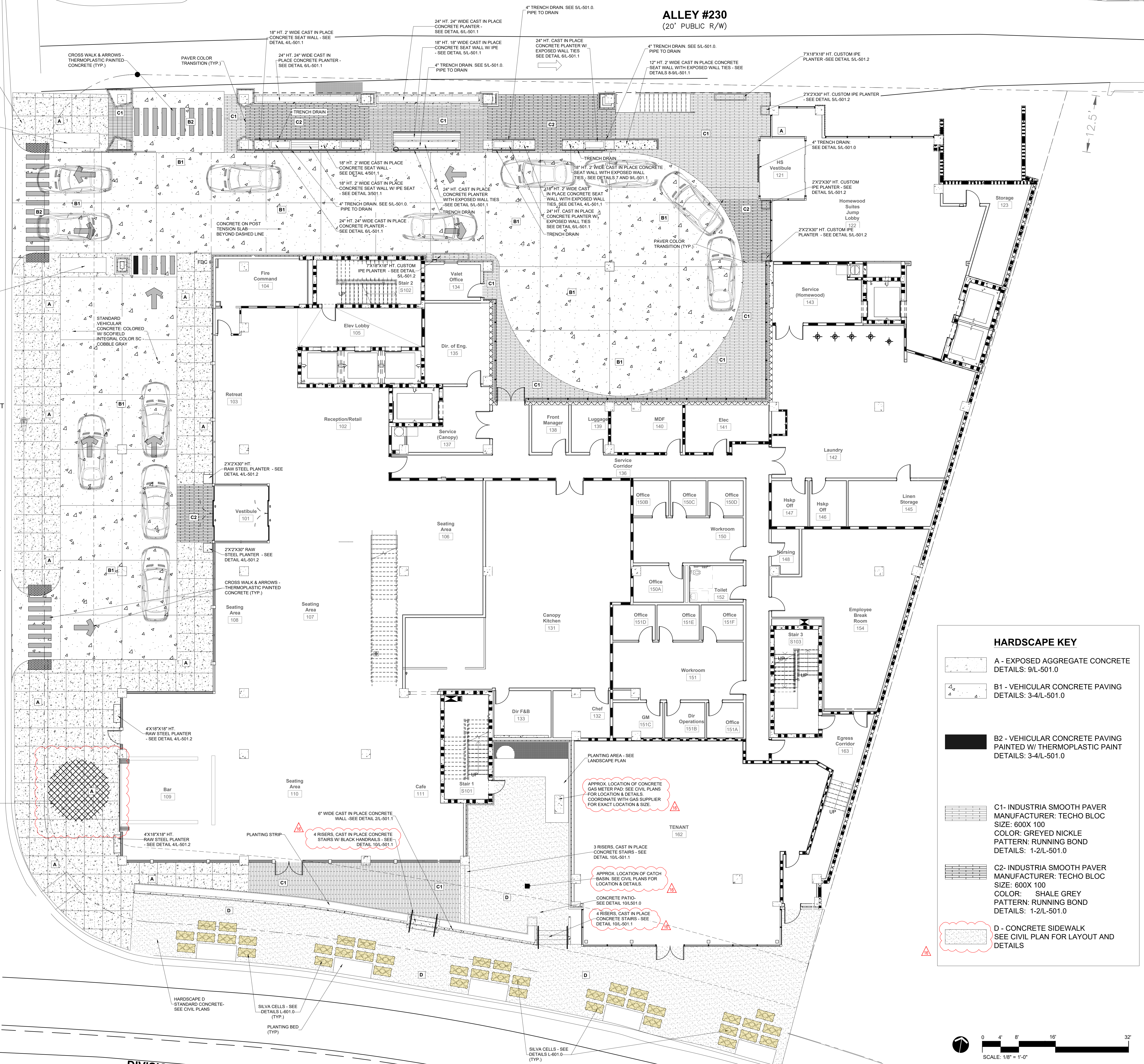

- NOTES:**
- MATERIALS PLAN**
- NO SUBSTITUTIONS ARE PERMITTED WITHOUT PRIOR APPROVAL OF THE LANDSCAPE ARCHITECT AND/OR OWNERS REPRESENTATIVE.
 - SHOP DRAWINGS ARE TO BE SUBMITTED TO LANDSCAPE ARCHITECT AND/OR OWNERS REPRESENTATIVE FOR APPROVAL FOR THE FOLLOWING FEATURES PRIOR TO FABRICATION OR CONSTRUCTION:
 - GREEN SCREEN
 - WOOD DECKING
 - CUSTOM PLANTERS - IPE AND STEEL
 - STAMPED AND SEALED STRUCTURAL ENGINEERING DRAWINGS ARE REQUIRED TO BE SUBMITTED TO LANDSCAPE ARCHITECT AND/OR OWNERS REPRESENTATIVE FOR APPROVAL FOR THE FOLLOWING FEATURES PRIOR TO FABRICATION OR CONSTRUCTION:
 - GREEN SCREEN
 - CONCRETE WALL/CURB CONNECTIONS TO POST TENSION SLAB
 - PRODUCT SAMPLES AND/OR PRODUCT DATA TO BE SUBMITTED TO LANDSCAPE ARCHITECT AND/OR OWNERS REPRESENTATIVE FOR APPROVAL PRIOR TO FABRICATIONS OR CONSTRUCTION:
 - AGGREGATE FOR EXPOSED AGGREGATE CONCRETE
 - EXOTIC WOOD SAMPLES
 - LIGHTWEIGHT STRUCTURAL AGGREGATE
 - PLANTER MEDIA SYSTEM COMPONENTS
 - CATCHBASIN/TRENCH DRAIN
 - TECHO BLOC PAVERS
 - CUSTOM PLANTERS TO BE APPROVED BY LANDSCAPE ARCHITECT AND/OR OWNERS REPRESENTATIVE PRIOR TO INSTALLATION

HARDSCAPE KEY

- A - EXPOSED AGGREGATE CONCRETE
 DETAILS: 9/L-501.0
- B1 - VEHICULAR CONCRETE PAVING
 PAINTED W/ THERMOPLASTIC PAINT
 DETAILS: 3-4/L-501.0
- B2 - VEHICULAR CONCRETE PAVING
 PAINTED W/ THERMOPLASTIC PAINT
 DETAILS: 3-4/L-501.0
- C1 - INDUSTRIA SMOOTH PAVER
 MANUFACTURER: TECHO BLOC
 SIZE: 600X 100
 COLOR: GREYED NICKLE
 PATTERN: RUNNING BOND
 DETAILS: 1-2/L-501.0
- C2 - INDUSTRIA SMOOTH PAVER
 MANUFACTURER: TECHO BLOC
 SIZE: 600X 100
 COLOR: SHALE GREY
 PATTERN: RUNNING BOND
 DETAILS: 1-2/L-501.0
- D - CONCRETE SIDEWALK
 SEE CIVIL PLAN FOR LAYOUT AND
 DETAILS

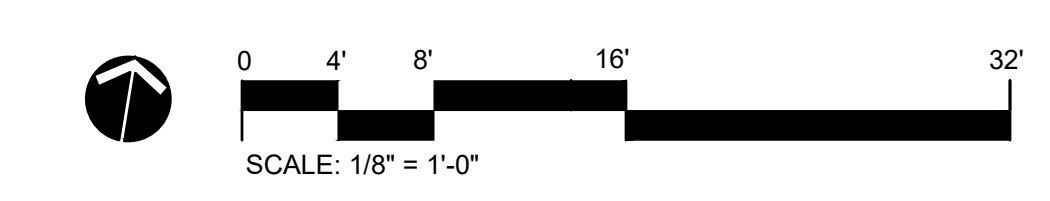

**DIVISION STREET
 (60' PUBLIC R/W WIDTH)**

**OVERTON STREET
 (50' PUBLIC R/W WIDTH)
 (TERTIARY)**

PLANT SCHEDULE-CANOPY AND HOMEWOOD SUITES
NASHVILLE, TN

QTY.	KEY	COMMON NAME	BOTANICAL NAME	SIZE	ROOT	NOTES
1ST FLOOR						
TREES						
5	ACGI	Paperbark Maple	Acer griseum	10-12' Ht. 2" CAL.		B&B, Central Leader. Meets ANSI Z60.1 Standards
SHRUBS						
3	AJUA	Green Aucuba	Aucuba japonica	18-24" Ht	3 Gal.	Container, Full Plant, Meets ANSI Z60.1 standards
5	BUGV	Green Velvet Boxwood	Buxus x 'Green Velvet'	12-18" Ht	3 Gal.	Container, Full Plant, Meets ANSI Z60.1 standards
6	CAJA	Japanese Camelia	Camellia japonica	2-3' Ht.	10 Gal.	Container, Full Plant, Meets ANSI Z60.1 standards
16	DIVS	Vintage Jade Distylium	Distylium 'Vintage Jade'	12-18" Ht	3 Gal.	Container, Full Plant, Meets ANSI Z60.1 standards
0	FAJA	Fatsia	Fatsia japonica	18-24" Ht	3 Gal.	Container, Full Plant, Meets ANSI Z60.1 standards
16	PIJA	Japanese Pieris	Pieris japonica	2-3' Ht.	7 Gal.	Container, Full Plant, Meets ANSI Z60.1 standards
24	MUCL	Pink Muhly Grass	Muhlenbergia capillaris 'Regal Mist'	18-24" Ht	3 GAL.	Container, Full Plant, Meets ANSI Z60.1 standards
9	POMA	Podocarpus	Podocarpus macrophyllus	2-3' Ht.	3 Gal.	Container, Full Plant, Meets ANSI Z60.1 standards
0	SARU	Fragrant Sweetbox	Sarcococca nuscifolia	12-18" Ht	3 Gal.	Container, Full Plant, Meets ANSI Z60.1 standards
18	TAMD	Dense Spreading Yew	Taxus x media 'Densiformis'	12-18" Ht	3 Gal.	Container, Full Plant, Meets ANSI Z60.1 standards
GROUND COVER/VINE						
30 sf	ANN	Annuals	Annuals		Sq. Ft.	Planted at 4-6" on center
43	ASEL	Cast Iron Plant	Aspidistra elatior	12-18" Ht	1 Gal.	Planted min of 12" on center, Container, Full Plant
0	EQHY	Horsetail Wood	Equisetum hyemale	12-18" Ht	1 Gal.	Planted min of 12" on center, full plant
48	GACD	Sweet Woodruff	Galium odoratum	12-18" Ht	4" Pot	Planted min of 9" on center, full plant
0	GESE	Carolina Jessamine	Geisium sempervirens	12-18" Ht	1 Gal.	Planted as shown, train on green screen, Full Plant
21	HELO	Lenton Rose	Heleborus orientalis	12-18" Ht	1 Gal.	Planted as shown, Container, Full Plant
0	LOSM	Trumpet Honeysuckle	Lonicera sempervirens 'Manifica'	12-18" Ht	1 Gal.	Planted as shown, train on green screen, Full Plant
12	POAC	Christmas Fern	Polystichum acrostichoides	12-18" Ht	1 Gal.	Planted as shown, full plant
20	RUHI	Black Eyed Susan	Rudbeckia fulgida 'Goldstrum'	12-18" Ht	1 Gal.	Planted min of 12" on center, full plant
69	TRAS	Asiatic Jasmine	Trachelospermum asiaticum	3-4" Ht	4" Pot	Planted min of 12" on center, full plant
0	VIMI	Periwinkle	Vinca minor	3-4" Ht	4" Pot	Planted min of 12" on center, full plant
2ND FLOOR						
SHRUBS						
11	DIVS	Vintage Jade Distylium	Distylium 'Vintage Jade'	12-18" Ht	3 Gal.	Container, Full Plant, Meets ANSI Z60.1 standards
18	PRLS	Schickp Cherry Laurel	Prunus laurocerasus 'Schipkaensis'	5-6' Ht.		Purchase from Instantedge.com, minimum of 5' height at planting
20	VIFI	Pearl Vibernum	Viburnum 'PiliVib-I' PP23385	36" Ht Min.	7 Gal.	Container, Full Plant, Meets ANSI Z60.1 standards
GROUND COVER/VINE						
2 SF	ANN	Annuals	Annuals		Sq. Ft.	Planted at 4-6" on center
27	HELO	Lenton Rose	Heleborus orientalis	12-18" Ht	1 Gal.	Planted as shown, Container, Full Plant
33 SF	HYCU	Sheet Moss	Hypnum cupressiforme		Sq. Ft.	Planted as shown
10	LBBB	Big Blue Lilyturf	Liriope muscari 'Big Blue'	12-18" Ht	4" Pot	Planted min of 12" on center, full plant
6	LOSM	Trumpet Honeysuckle	Lonicera sempervirens 'Manifica'	12-18" Ht	1 Gal.	Planted as shown, train to grow on trellis
1	LYNU	Creeping Jenny 'Goldlocks'	Lysimachia nummularia 'Aurea'	2-3" Ht	4" Pot	Planted min of 12" on center, full plant
82	POAC	Christmas Fern	Polystichum acrostichoides	12-18" Ht	1 Gal.	Planted as shown, full plant
13	RUHI	Black Eyed Susan	Rudbeckia fulgida 'Goldstrum'	12-18" Ht	1 Gal.	Planted min of 12" on center, full plant
8TH FLOOR						
SHRUBS						
0	BUGV	Green Velvet Boxwood	Buxus x 'Green Velvet'	12-18" Ht	3 Gal.	Container, Full Plant, Meets ANSI Z60.1 standards
0	CUSM	Tiny Tower Italian Cypress	Cupressus sempervirens 'Moshel' PP#12,933	2-3" Ht.	3 Gal.	Container, Full Plant, Meets ANSI Z60.1 standards
0	LAAF	Folgate English Lavender	Lavandula angustifolia 'Folgate'	12-18" Ht	1 Gal.	Container, Full Plant, Meets ANSI Z60.1 standards
30	POMA	Podocarpus	Podocarpus	2-3" Ht.	3 Gal.	Container, Full Plant, Meets ANSI Z60.1 standards
GROUND COVER/VINE						
0	AGNO	Midnight Blue Agapanthus	Agapanthus 'Mornd'	12-18" Ht	1 Gal.	Container, Full Plant, Meets ANSI Z60.1 standards
0	BICT	Tangerine Beauty Cross Vine	Bignonia capreolata 'Tangerine'	12-18" Ht	1 Gal.	Train up screen wall, Meets ANSI Z60.1 Standards
120	LYNU	Creeping Jenny 'Goldlocks'	Lysimachia nummularia 'Aurea'	2-3" Ht	4" Pot	Planted min of 8" on center, full plant
32	SAVL	Lemon Fizz Lavender Cotton	Santolina virens 'Lemon Fizz'	6-9" Ht	1 GAL.	Container, Full Plant, Meets ANSI Z60.1 standards
0	POAC	Christmas Fern	Polystichum acrostichoides	12-18" Ht	1 Gal.	Planted as shown, full plant
0	TRAS	Asiatic Jasmine	Trachelospermum asiaticum	3-4" Ht	4" Pot	Planted min of 12" on center, full plant
20	TRJM	Madison Star Jasmine	Trachelospermum jasminoides 'Madison'	12-18" Ht	1 GAL.	Train up screen wall, Meets ANSI Z60.1 Standards
11TH FLOOR GLASS BOX						
MOSS						
14 SF	ANAT	Tree Apron Moss	Anomodon attenuatus		Sq. Ft.	Planted as shown
0 SF	DISC	Mood Moss	Dicranum scoparium		Sq. Ft.	Planted as shown
28 SF	HYCU	Sheet Moss	Hypnum cupressiforme		Sq. Ft.	Planted as shown
16 SF	LEAL	Cushion Moss	Leucobryum albidum		Sq. Ft.	Planted as shown
16 SF	POCO	Hair Cap Moss	Ptychidium commune		Sq. Ft.	Planted as shown
13 SF	THDE	Fern Moss	Thuidium delicatulum		Sq. Ft.	Planted as shown
11TH FLOOR / AGAVE BAR						
SHRUBS						
0	AGCH	Golden Flower Century Plant	Agave chrysantha	24-30" Ht	7 Gal.	Container, Full Plant, Meets ANSI Z60.1 standards
3	AGHA	Harvard Agave	Agave havardiana	24-30" Ht	7 Gal.	Container, Full Plant, Meets ANSI Z60.1 standards
0	AGNI	King of the Agaves	Agave nickelside	12-18" Ht	7 Gal.	Container, Full Plant, Meets ANSI Z60.1 standards, 18" O.C.
4	AGOV	White's Tongue Agave	Agave ovatifolia	30-36" Ht	7 Gal.	Container, Full Plant, Meets ANSI Z60.1 standards
0	AGPA	Artichoke Agave	Agave parryi var. truncata	12-18" Ht	7 Gal.	Container, Full Plant, Meets ANSI Z60.1 standards
0	AGST	Narrowleaf Century Plant	Agave striata	12-18" Ht	7 Gal.	Container, Full Plant, Meets ANSI Z60.1 standards
6	CAKF	Feather Reed Grass	Calamagrostis x acutiflora 'Karl Foerster'	3-4" Ht.	1 GAL.	Container, Full Plant, Meets ANSI Z60.1 standards
15	MUCL	Pink Muhly Grass	Muhlenbergia capillaris 'Regal Mist'	18-24" Ht	1 GAL.	Container, Full Plant, Meets ANSI Z60.1 standards
GROUND COVER/VINE						
12 SF	ANN	Annuals	Annuals		Sq. Ft.	
30	CHME	Damianita	Chrysactinia mexicana	1-2' Ht.	1 GAL.	Container, Full Plant Meets ANSI Z60.1 standards
15	CLKA	Pink Champagne Clematis	Clematis x 'Kakio'	12-18" Ht.	1 GAL.	Stake and train up columns and planter trellis
21	DEBA	White Eyed Ice Plant	Delosperma basulicum	3-4" Ht.	4" Pot	Planted 6" O.C., Full plant
28	DECO	Hardy Ice Plant	Delosperma cooperi	3-4" Ht.	4" Pot	Planted 6" O.C., Full plant
12	FEGL	Blue Fescue	Festuca glauca	6-10" Ht.	1 GAL.	Container, Full Plant Meets ANSI Z60.1 standards
9	HYPE	Sedum Purple Emperor	Hylotelephium telephium 'Purple Emperor'	12-18" Ht.	1 GAL.	Planted 12" O.C., Full plant
19	IBSE	Candytuff	Iberis sempervirens	12-18" Ht.	4" pot	Planted 8" O.C., Full plant
13	LYNU	Creeping Jenny 'Goldlocks'	Lysimachia nummularia 'Aurea'	2-3" Ht.	4" Pot	Planted min of 6" on center, full plant
14	CECA	Tufted Evening primrose	Oenothera caespitosa	8-12" Ht.	1 GAL.	Container, Full Plant Meets ANSI Z60.1 standards
88	OXAD	Sheer Shamrock	Oxalis adenophylla	3-4" Ht.	Bulb	Planted 12 bulbs per sf
25	PEEA	Firecracker Beardtongue	Penstemon astorian	12-18" Ht.	1 GAL.	Container, Full Plant Meets ANSI Z60.1 standards
3	PHAF	Aizoon Stonecrop	Phedimus aizoon var floribundus	6-10" Ht.	1 GAL.	Container, Full Plant Meets ANSI Z60.1 standards
30	SESA	Autumn Joy Sedum	Hylotelephium telephium 'Autumn Joy'	12-18" Ht.	1 GAL.	Planted 18" O.C., Full plant
162	SEMF	Mixed varieties of Hen and Chicks	Sempervivum	3-4" Ht.	4" Pot	Planted 6" O.C., Full plant, Mix varieties
9	SETC	Coral Reef Sedum	Sedum tetraecium 'Coral Reef'	3-4" Ht.	4" Pot	Planted 6" O.C., Full plant
21	SEVA	Cream and Green Carpet Sedum	Sedum lineare 'Variegatum'	3-4" Ht.	4" Pot	Planted 6" O.C., Full plant
10	TRJM	Madison Star Jasmine	Trachelospermum jasminoides 'Madison'	12-18" Ht.	1 GAL.	Stake and train up columns and planter trellis

TREE DENSITY UNIT WORKSHEET:
MARCH 9, 2021
MAP: 93-14 PARCEL: 565 (ID: 09314065500)
APPLICATION #:
PROJECT NAME: NASHVILLE CANOPY
ADDRESS: 920 DIVISION STREET

- ACREAGE: 86 AC (37,844 S.F.)
- BLDG COVERAGE AREA: 67 AC (29,140 S.F.)
- ADJUSTED ACREAGE: 19 AC (8,504 S.F.)
- X REQUIRED TREE DENSITY UNITS PER ACRE (22)
- REQUIRED TDU FOR PROJECT: 418

***THERE ARE NO EXISTING PROTECTED TREES ON SITE.**

PROPOSED TREE SCHEDULE:
CAL # OF TREES VALUE UNITS
2" CAL. 5 QTY. X 0.5 = 2.5

DENSITY UNITS PROVIDED ON ABOVE SCHEDULES:
TOTAL DENSITY UNITS RETAINED ON SITE: 0
TOTAL DENSITY UNITS FOR NEW TREES: 2.5
TOTAL DENSITY UNITS PROVIDED: 2.5
TOTAL CREDITS PAID TO TREE MITIGATION BANK: _____
TOTAL DENSITY UNITS PROVIDED: 4

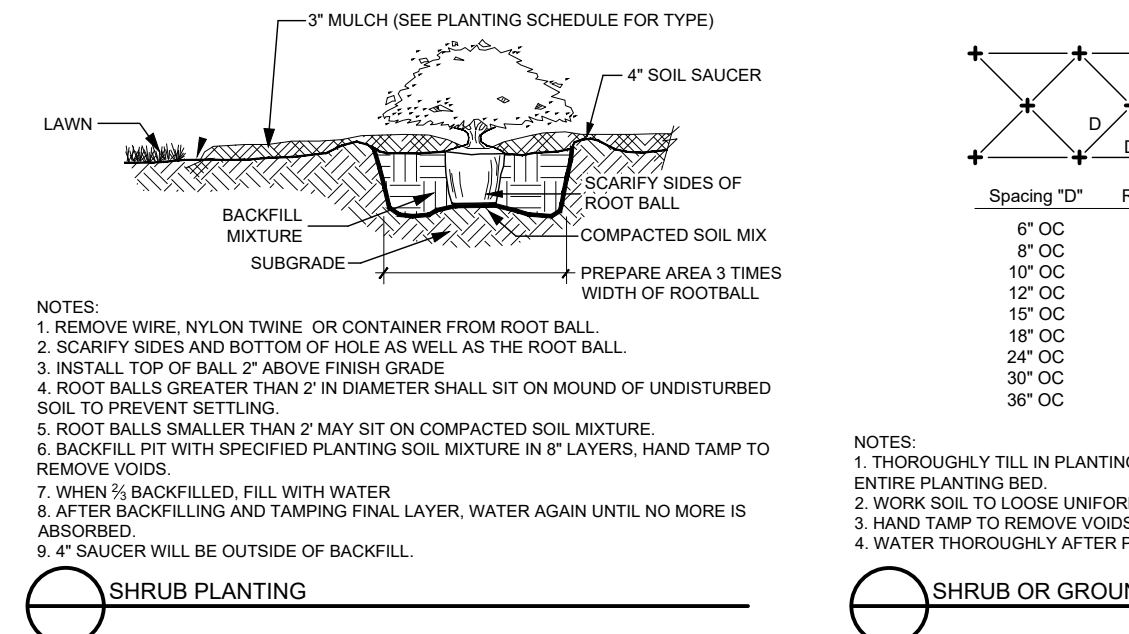
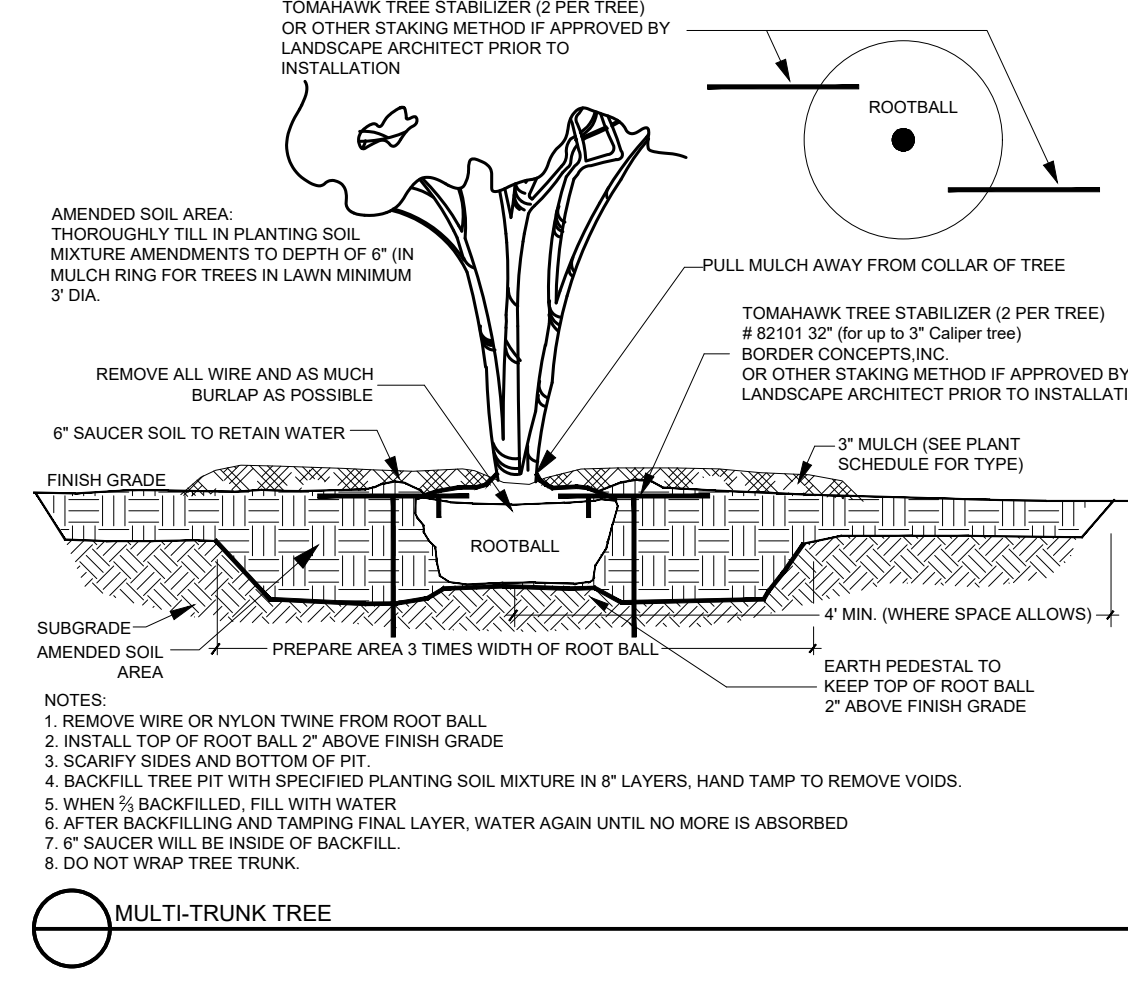
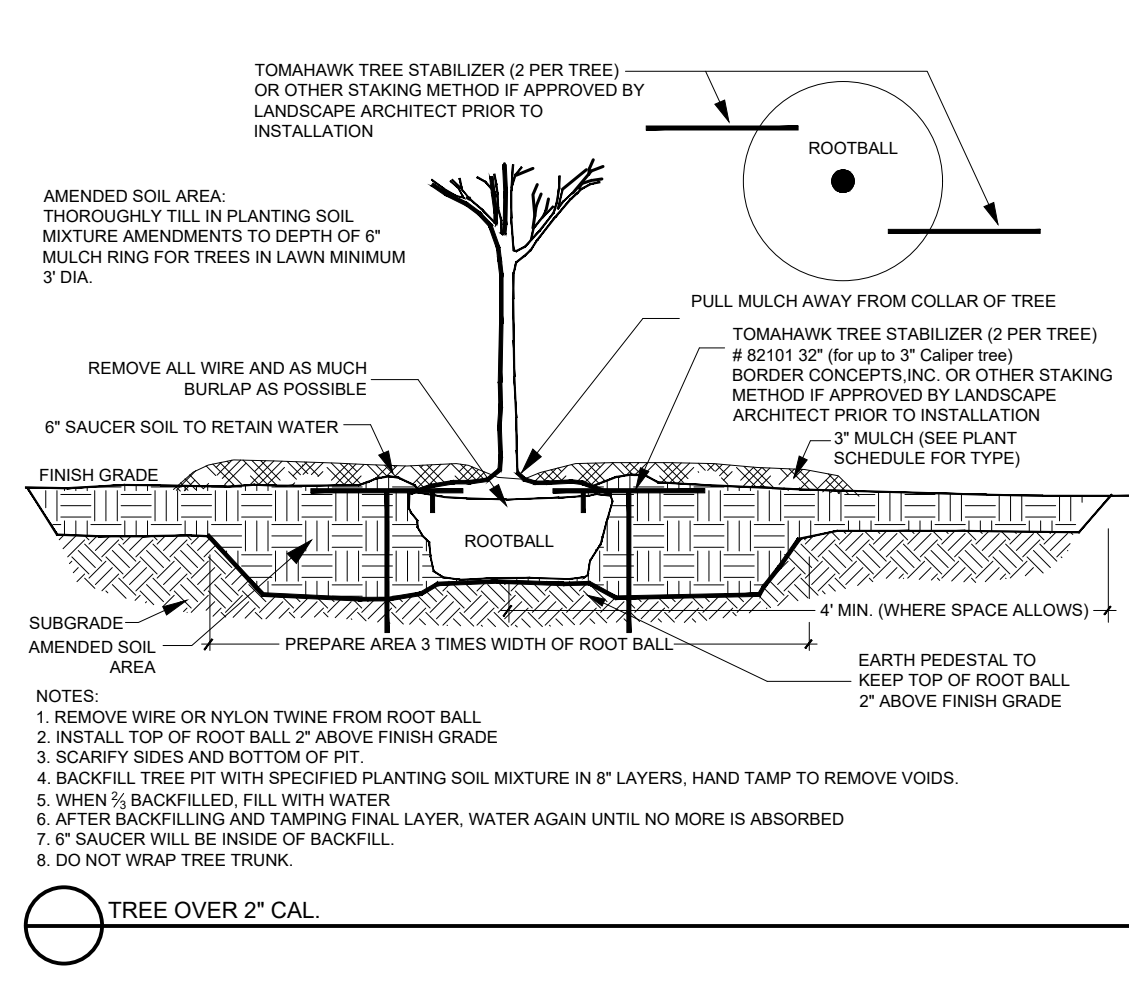

Spacing "D"	Row "A"	No. Plants/Sf
6" OC	5.20'	4.81
8" OC	6.93'	2.60
10" OC	8.66'	1.66
12" OC	10.40'	1.15
14" OC	12.13'	.79
16" OC	13.87'	.62
18" OC	15.60'	.46
24" OC	20.80'	.29
30" OC	26.00'	.18
36" OC	30.00'	.12

NOTES:
1. THOROUGHLY TILL IN PLANTING SOIL MIXTURE AMENDMENTS TO DEPTH OF 6" IN ENTIRE PLANTING BED.
2. WORK SOIL TO LOOSE, UNIFORM FINE TEXTURE.
3. HAND TAMP TO REMOVE VOIDS AND AIR POCKETS.
4. WATER THOROUGHLY AFTER PLANTING UNTIL NO MORE WATER IS ABSORBED.
5. SAUCER WILL BE OUTSIDE OF BACKFILL.

SHRUB OR GROUND COVER SPACING

GENERAL NOTES & SPECIFICATIONS

GENERAL REQUIREMENTS

The Landscape Contractor shall be responsible for all material and all work as called for on the landscape plans. The list of plant quantities shown on the plan are for the contractor's convenience only. Plans shall be installed as shown. Contractor is responsible for confirming all quantities prior to bidding and installation.

The Landscape Contractor shall warranty all trees for a period of one (1) year and shrubs and groundcovers for a period of six (6) months from the time of final acceptance by Owner and Landscape Architect if under irrigation. If the trees and shrubs are not irrigated, no warranty will be required from Landscape Contractor.

The Landscape Contractor shall be wholly responsible for the stability and plumb condition of all trees and shall be legally liable for any damage caused by the instability of any plant material. Staking of trees, if required, shall be done utilizing a method agreed upon by the Landscape Architect.

Positive drainage shall be maintained away from all structures on the site.

It shall be the Landscape Contractor's responsibility to provide for inspection of the plant material by the Landscape Architect or Owner's Representative prior to installation. All plant material will be inspected. Plants not conforming precisely to the plant list will not be accepted and shall be replaced at the contractor's expense.

PLANT SPECIFICATIONS

All nursery stock plant material shall meet or exceed the standards set forth in the Revised American Standard for Nursery Stock (ANSI Z60.1).
All plant material shall be planted, fertilized and mulches as per the plant details and planting specifications noted on the plans.

All container grown material shall be healthy, vigorous, well rooted plants and established in the container in which they are delivered to the site. The plants shall have tops which are good quality and in a healthy growing condition. Established container grown plant material shall be grown in that container sufficiently long enough for the new fibrous roots to have developed enabling the root mass to retain it's shape when removed from the container. Plants which have become root bound in the container are unacceptable.

All plant material that is not container grown shall be freshly dug, sound, healthy, vigorous, well branched, and free of disease and insect eggs and larvae, and shall have adequate root systems. Where any requirements are omitted from the plant list, the plants furnished shall be normal for the variety. Plants may be pruned prior to delivery only upon the approval of the Landscape Architect.

The root ball of container grown plants shall be scarified in several places prior to planting. Plant shrubs and trees so that after initial settlement, the top root balls will be even with or slightly above the adjacent soil line.

FERTILIZER

Granular fertilizer shall be uniform in composition, dry and free flowing. This fertilizer shall be delivered to the site in the original unopened bags bearing the manufacturers statement of analysis. Granular fertilizer shall be a controlled release variety meeting the following requirements: sixteen percent (16%) nitrogen, four percent (4%) phosphorus, eight percent (8%) potassium, plus iron.
Application Rates:

Plant Size	16-4-8
3 gallon	1/3 lb.
7-15 gallon	1/2 lb.
1"-6" caliper	2 lbs. per 1" caliper
6"+ caliper	3 lbs. per 1" caliper

SOIL

Planting soil shall be a fertile, friable natural topsoil of loamy character. It shall contain twenty to thirty percent (20-30%) decomposed organic matter and be free of heavy clay, stones larger than 1" in diameter, noxious weed and plants, sod, partially disintegrated debris, insects or any other undesirable material, plants, or seeds that would be toxic or harmful to plant growth.

MULCH

All plant beds and tree watering basins shall be top dressed with three inches (3") of double ground hardwood mulch

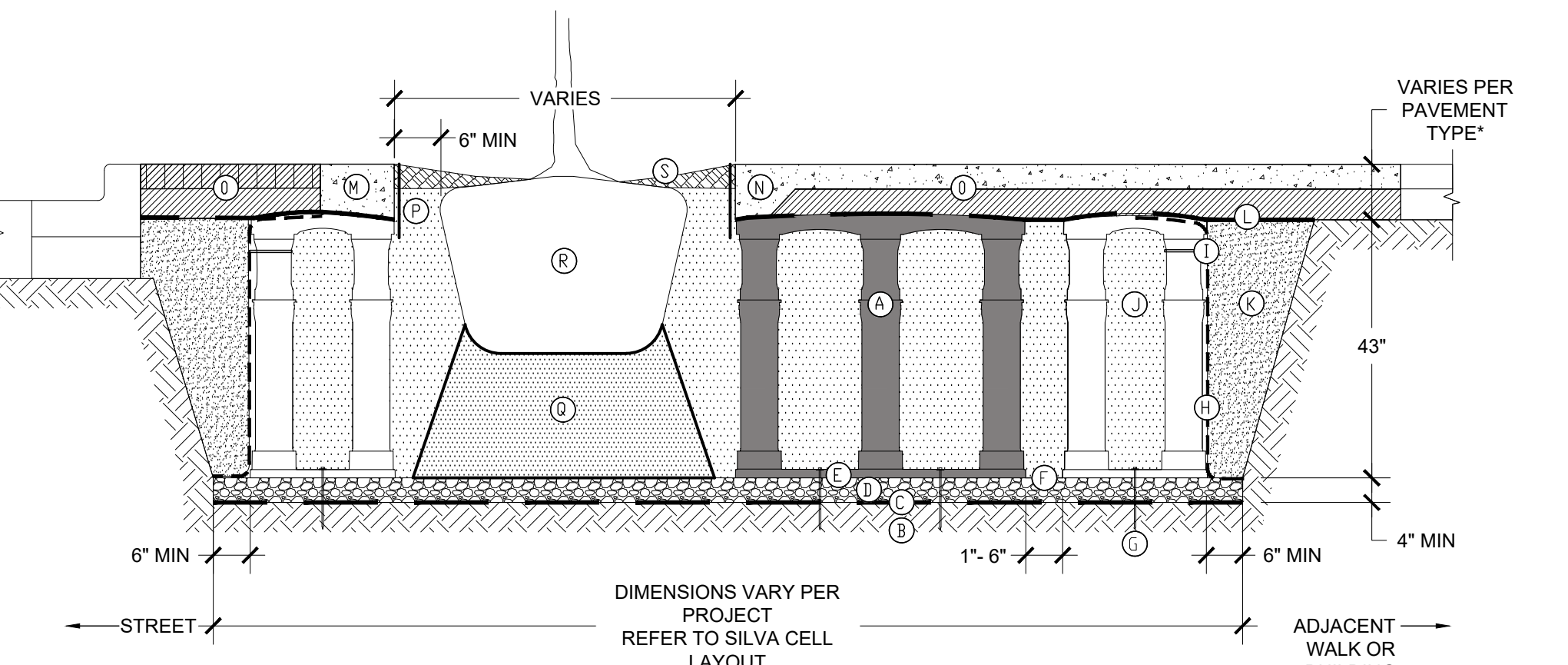

- SILVA CELL SYSTEM 3X NOT TO SCALE**
- KEY PLAN**
- (A) SILVA CELL SYSTEM (DECK, BASE, AND POSTS)
 - (B) SUBGRADE, COMPACTED
 - (C) GEOTEXTILE FABRIC, PLACED ABOVE SUBGRADE
 - (D) 4" MIN AGGREGATE SUB BASE, COMPACTED TO 95% PROCTOR
 - (E) SILVA CELL BASE SLOPE, 10% MAX
 - (F) 1" TO 6" SPACING BETWEEN SILVA CELLS AT BASE
 - (G) ANCHORING SPIKES, CONTACT DEEPROOT FOR ALTERNATIVE
 - (H) GEOGRID, WRAPPED AROUND PERIMETER OF SYSTEM, WITH 6" TOE (OUTWARD FROM BASE) AND 12" EXCESS (OVER TOP OF DECK)
 - (I) CABLE TIE, ATTACHING GEOGRID TO SILVA CELL AT BASE OF UPPER LEG FLARE, AS NEEDED
 - (J) PLANTING SOIL, PER PROJECT SPECIFICATIONS, PLACED IN LIFTS AND WALK-IN COMPACTED TO 75-85% PROCTOR
 - (K) COMPACTED BACKFILL, PER PROJECT SPECIFICATIONS
 - (L) GEOTEXTILE FABRIC TO EDGE OF EXCAVATION
 - (M) RIBBON CURB AT TREE OPENING (TO BE USED WITH PAVERS OR ASPHALT)
 - (N) THICKENED EDGE AT TREE OPENING (TO BE USED WITH CONCRETE)
 - (O) PAVEMENT AND AGGREGATE BASE PER PROJECT *
 - (P) DEEPROOT ROOT BARRIER, 12" OR 18" DEPTH DETERMINED BY THICKNESS OF PAVEMENT SECTION, INSTALL DIRECTLY ADJACENT TO CONCRETE EDGE RESTRAINT
 - (Q) PLANTING SOIL BELOW ROOT BALL, COMPACTED WELL TO PREVENT SETTLING
 - (R) ROOT BALL
 - (S) TREE OPENING TREATMENT, PER PROJECT SPECIFICATIONS
- *MINIMUM PAVEMENT PROFILE OPTIONS TO MEET H-20 LOADING**
- | PAVEMENT COURSE | + AGGREGATE BASE |
|-----------------|------------------|
| 4" CONCRETE | + 4" AGGREGATE |
| 3" PAVER | + 12" AGGREGATE |
| 4" ASPHALT | + 12" AGGREGATE |
| 2" PAVER | + 5" CONCRETE |
- NOTES**
- EXCAVATION SHALL BE DONE IN ACCORDANCE WITH ALL APPLICABLE HEALTH AND SAFETY REGULATIONS
 - INSTALLATION TO BE COMPLETED IN ACCORDANCE WITH MANUFACTURERS SPECIFICATIONS
 - PROVIDE SUPPLEMENTAL IRRIGATION
 - DO NOT SCALE DRAWINGS

ODA Architecture
2010 South Tryon St., Suite 1a
Charlotte, NC, 28203
704.332.1615
www.oda.us.com

SEAL:

CONSULTANT:

SEXTON
Design + Development
6 Custom Mill Ct.
Greenville SC 29609
864-412-7712
www.sextond.com

Canopy / Homewood The Gulch
910 Division Street
Nashville, TN 37203
ODA Project No. 183270

FOR CONSTRUCTION

06.26.2020

No.	Description	Date
1	PRICING REVISION 1	07.17.2020
2	TITLEBLOCK REVISION	07.28.2020
3	PERMIT COMMENTS	12.21.2020
14	RFI RESPONSE	07.01.2022
15	LANDSCAPE SET REVISIONS IRRIGATION PLANS ADD.	10.04.2022
18	LANDSCAPE SET REVISIONS	04.25.2024
17	LANDSCAPE SET REVISIONS	06.14.2024

LANDSCAPE: LANDSCAPE DETAILS

L-601.0