

MULTIMODAL ACCESS CLOSURE EXCEPTION APPLICATION FORM AND CHECKLIST

Submittal Date: 10/04/24 **New Submittal** **Re-Submittal No:** _____

Related Building Permit No: 2023012062

Project Name: Link Tower (VUH Expansion Project)

Street Name Location: 1311 21st Ave S Nashville, TN 37212

Between: Pierce Ave **And:** Vivien Thomas Way

Applicant Name: Porter Martin

Address: 5500 Maryland Way Suite 100 Brentwood, TN 37027

Phone: 205-401-1745 **Fax:** _____ **Contact:** Porter Martin

Email: Pmartin@robinsmorton.com

Project Description: 16 story mixed use building for Vanderbilt University Medical Center

Start Date: 11/04/24 **End Date:** 11/29/24 **Project Length:** 4 years

Describe Type of Closure: West sidewalk closure from one cross walk to another

Provide Reasons why Project cannot be completed without closures and what other options were considered (attach documents as needed): _____

Excavation will occur at and adjacent to sidewalk in order to install new footings and retaining walls. Furthermore, the sidewalk will be expanded.

PROJECT INFORMATION CHECKLIST:

Included Not Applicable

- | | | |
|-------------------------------------|-------------------------------------|--------------------------------------------------------------------------------------------------------------------------------------------------------------------------|
| <input checked="" type="checkbox"/> | <input type="checkbox"/> | Project Vicinity Map with Project Area shown, street names, property information, existing pavement and striping, gutter and building locations, north arrow, and scale. |
| <input checked="" type="checkbox"/> | <input type="checkbox"/> | Planned work hours included. |
| <input checked="" type="checkbox"/> | <input type="checkbox"/> | Exact location and dimensions of the construction work zone shown. |
| <input type="checkbox"/> | <input checked="" type="checkbox"/> | If multiple phases are necessary, include perimeter impact of each phase, phase number, anticipated work hours and phase duration. |
| <input checked="" type="checkbox"/> | <input type="checkbox"/> | Details on construction activity and equipment being used as part of construction included for each phase. |
| <input checked="" type="checkbox"/> | <input type="checkbox"/> | Specify if any on-street parking, and/or metered parking, is to be restricted and if bus zone will need to be relocated. |
| <input type="checkbox"/> | <input checked="" type="checkbox"/> | Specify if trash pickup will be impacted. |
| <input checked="" type="checkbox"/> | <input type="checkbox"/> | Provide information on all utility work and utility connections. |
| <input type="checkbox"/> | <input checked="" type="checkbox"/> | List all affected residents, businesses, agencies, and schools and any conversations/agreements taken place. |
| <input type="checkbox"/> | <input checked="" type="checkbox"/> | Show ongoing construction projects within vicinity of proposed project impact. |
| <input type="checkbox"/> | <input checked="" type="checkbox"/> | Provide plan to address conflicts with other nearby projects. |
| <input checked="" type="checkbox"/> | <input type="checkbox"/> | Provide traffic control plan for each phase of construction (see traffic control checklist for more information). |
| <input type="checkbox"/> | <input checked="" type="checkbox"/> | Provide information on work vehicle parking locations. |
| <input checked="" type="checkbox"/> | <input type="checkbox"/> | Show construction trucks ingress/egress to project location. |
| <input checked="" type="checkbox"/> | <input type="checkbox"/> | Provide information on any traffic signals, traffic signal loops, and traffic signal cabinets in close proximity to project. |

TRAFFIC CONTROL PLAN CHECKLIST:

Included Not Applicable

- | | | |
|-------------------------------------|-------------------------------------|-----------------------------------------------------------------------------------------------------------------------------------------------------------------------------|
| <input checked="" type="checkbox"/> | <input type="checkbox"/> | All temporary traffic control plans shall be designed in accordance with the most recent ADA regulations and requirements of the Manual of Uniform Traffic Control Devices. |
| <input type="checkbox"/> | <input checked="" type="checkbox"/> | Clearly show the locations of all existing signs (including speed limit) as well as the proposed signs for each construction phase. |
| <input checked="" type="checkbox"/> | <input type="checkbox"/> | Show the location of all existing pedestrian paths and pedestrian detour route of each stage of construction. |
| <input checked="" type="checkbox"/> | <input type="checkbox"/> | Show dimensions of travel lane width, shoulder width, sidewalk of each phase, and overall roadway width along the length of affected area. |
| <input checked="" type="checkbox"/> | <input type="checkbox"/> | Show all existing striping and markings to remain, to be removed, and all proposed striping and markings for each construction stage. |
| <input checked="" type="checkbox"/> | <input type="checkbox"/> | Provide detour plan clearly showing detour route for any roadway or pedestrian/bike path closures. |
| <input checked="" type="checkbox"/> | <input type="checkbox"/> | Specify placement of all temporary traffic control devices. |
| <input type="checkbox"/> | <input checked="" type="checkbox"/> | Specify spacing of all temporary traffic control devices. |
| <input checked="" type="checkbox"/> | <input type="checkbox"/> | Show all existing traffic signals and streetlights in the work zone location. |
| <input type="checkbox"/> | <input checked="" type="checkbox"/> | Lighting provided for all pedestrian detour routes. |
| <input type="checkbox"/> | <input checked="" type="checkbox"/> | Provide minimum eleven (11) foot travel lanes at all times. |
| <input checked="" type="checkbox"/> | <input type="checkbox"/> | Show size, height, and location of all channelizing devices, warning lights, flag trees, barriers, etc. |
| <input type="checkbox"/> | <input checked="" type="checkbox"/> | Label all taper lengths and widths. |
| <input type="checkbox"/> | <input checked="" type="checkbox"/> | Provide locations of police officers for each phase as needed. |
| <input type="checkbox"/> | <input checked="" type="checkbox"/> | Temporary Traffic Control Plan has been stamped and signed by a TN licensed Civil Engineer. |

PERMIT APPLICATION

720 South Fifth Street

Nashville, TN 37206

Phone #: 862-8782

Fax #: 880-3259

NASHVILLE DEPARTMENT of TRANSPORTATION
& MULTIMODAL INFRASTRUCTURE

Mark Which Type Permit Applying For:

STREET CLOSURE PERMIT

RIGHT-OF-WAY/LANE CLOSURE PERMIT

TRAILER/DUMPSTER/
STORAGE UNIT PERMIT

SIDEWALK CLOSURE PERMIT

NEW DRIVEWAY PERMIT

PARKING/LOADING ZONE PERMIT

Today's Date: 10/03/2024

Company Name: Robins & Morton

Company Address: 5500 Maryland Way Suite 100 Brentwood, TN 37027

Contact Name: Porter Martin After Hours/Emergency Phone #: (205)401-1745

Phone #: (205) 401-1745 Fax #: ()

Email Address: pmartin@robinsmorton.com

Street Location: N/A

Sidewalk Location: 1215 21st Ave South (West Sidewalk)

From: Pierce Avenue To: Vivian Thomas Way

Work being performed: Excavation and pouring retaining walls/footings.

Number of Days Needed: 25 Start Date: 11/04/24

Work Weekends: Yes No:

Requested By: Porter Martin Porter Martin
Signature Print Name

****Note: By signing you agree that you have read and understood the attached Chapter 13.20.020 notice attached.**

Office Use Only:

Received By: _____

Permit Number: _____

Payment Type: _____

Permit Fee: _____



METROPOLITAN GOVERNMENT OF NASHVILLE AND DAVIDSON COUNTY
JOHN COOPER
MAYOR
NASHVILLE DEPARTMENT OF TRANSPORTATION
AND MULTIMODAL INFRASTRUCTURE

Chapter 13.20.020 Excavations and Obstruction Permissions and Notice Required

According to the referenced Code on Excavations and Obstructions in Metro Right of Way: “no excavation may be undertaken in any street, road, alley or right of way or of any utility or temporary construction easement of the Metropolitan Government or other government entity by any department of the metropolitan government or any other entity unless notice as required herein has been given”.

All contractors performing excavations in Metro right of way are required to provide 1 to 2 weeks of advance notice to the homeowners, residents, and businesses along the streets where the work is being performed. Your company must provide some form of documentation or proof that you have given adequate advance notice of your project. *Failure to do so could result in a triple fee fine to your permit.*

Attached is an example of what the door hangers or mailers should look like.

Please contact PWPermits@Nashville.gov or 615-862-8782 if you have any questions.

NDOT

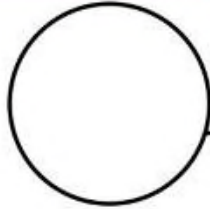

**Mayor
John Cooper**

*NASHVILLE DEPARTMENT OF TRANSPORTATION
& MULTIMODAL INFRASTRUCTURE*

Please be informed that a project for Utility Work will begin in approximately 1-2 weeks depending on weather conditions.

FOR ADDITIONAL INFORMATION CONTACT

Contractor _____

Contact Person _____

Phone # _____

Type of Work _____

NDOT (Formerly Public Works)

Phone #
615-862-8782

We appreciate your cooperation.

 To Request this information in an alternate format or ADA accommodations, please contact

Rick Kirkpatrick
615-862-8750

PROJECT NOTIFICATION

NDOT

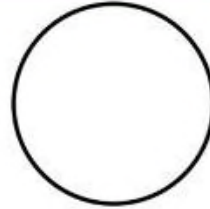

**Mayor
John Cooper**

*NASHVILLE DEPARTMENT OF TRANSPORTATION
& MULTIMODAL INFRASTRUCTURE*

Please be informed that a project for Utility Work will begin in approximately 1-2 weeks depending on weather conditions.

FOR ADDITIONAL INFORMATION CONTACT

Contractor _____

Contact Person _____

Phone # _____

Type of Work _____

NDOT (Formerly Public Works)

Phone #
615-862-8782

We appreciate your cooperation.

 To Request this information in an alternate format or ADA accommodations, please contact

Rick Kirkpatrick
615-862-8750

PROJECT NOTIFICATION

Nashville Department of Transportation

Change from Lane Closure to Street Closure Policy

Change from Lane Closure to Street Closure after Permit is Issued:

A Street Closure Application and Traffic Plan from a Licensed Traffic Engineer must be submitted for approval to the NDOT Permit Office to change the Permit issued for a Lane Closure to a Street Closure. All requests are assessed based on the scope of work, time required, and impacts to pedestrian and vehicular traffic. Street Closure request is reviewed and restrictions such as work times and need for Safety Officers/Traffic Management are based on the location, knowledge of traffic flows, existing permits already issued, and impacts to the public.

If a Street Closure is requested by the contractor for a permit with an existing Lane Closure, a meeting will be scheduled by the inspector with the contractor and the Permit Administrator to review the conditions and requirements. At that time if there is a need to adjust the Lane Closure parameters the inspector directs the contractor to request the change via e-mail to the Permit Office. The inspector will notify the Permit Office via email of their agreement with the request. If there is a need for a Street Closure, the contractor shall submit a traffic plan from a licensed Traffic Engineer that includes a detour plan with Safety Officers, traffic control and notification of the Street Closure to all Metro entities such as OEM, MNPS, MNP, NFD, and WeGo prior to the Street Closure. When the Street Closure Application and the Traffic Plan for the Street Closure is approved by the Permit Administrator, the original Lane Closure Permit will be revised to a Street Closure Permit and reissued. The contractor closes the road, and the inspector confirms that the plan is being followed and is working safely.

Intermittent Traffic Control (ITC) measures, in which a street is temporarily closed for a very short period (less than thirty minutes) must be documented on a Lane Closure Permit. The contractor should request this during their initial application. If during the initial site visit with the assigned inspector, if the need for ITC is identified but not clearly indicated on the permit, the contractor will need to request this addition via e-mail to the Permit Office. The inspector will notify the Permit Office via email of their agreement to add the ITC. If during the project, the need for ITC measures is identified, the contractor should notify the assigned inspector to discuss.

Change from Lane Closure to Street Closure after Permit is Issued due to Safety Conditions:

Changing a Lane Closure to a Street Closure requires following specific protocols. At any time during work if conditions at the site deteriorate such that there is an immediate traffic safety issue, the road should be immediately closed, and the contractor immediately contact the area inspector and the Permit Office. The area inspector will visit the site immediately to assess the situation associated with a potential Street Closure.

Based upon the revised approved Traffic Plan, it will be determined if variable message boards or other elements of a traffic control plan are required.

Nashville Department of Transportation

Change from Lane to Street Closure Procedures

- 1. Contractor emails Permit Office to request a change from Lane Closure to a Street closure. Contractor submits a Traffic Plan from a Licensed Engineer and explains in detail why the change is needed.**
- 2. Office staff receives the email from Contractor requesting a Street Closure and will send to Permit Administrator and NDOT Traffic Engineer for approval.**
- 3. NDOT Permit Office and Traffic Engineer require a minimum of 5 days to review and approve the Traffic Plan for the Street Closure.**
- 4. If the Street Closure is approved by Permit Administrator and Traffic Engineer, area inspector and Permit Office will receive a copy of approved traffic plans and approved Street Closure Permit.**
- 5. The area inspector will contact contractor with approval and conditions of the permit. Inspector will also inform the contractor that it is their responsibility to contact and update the permit with the permit office.**
- 6. Per emailed request to the permit office, referencing Lane closure permit #, the permit office can process a new Street Closure permit at no charge and showing it was paid for on a previous Lane Closure permit.**
- 7. Prior to construction, contractor shall meet with area inspector on site to verify traffic control measures are in place. Inspector will document approval.**

11/04-11/29

TRAFFIC PLAN: WEST SIDEWALK OF 21ST AVE SOUTH



**SIDEWALK CLOSED / PEDESTRIAN
DETOUR WITH BARRIER AND
ARROWS**

SCOPE OF WORK

**SIDEWALK CLOSED / PEDESTRIAN
DETOUR WITH BARRIER AND ARROW**

LINK TOWER

CORE & SHELL

VANDERBILT UNIVERSITY
MEDICAL CENTER

ARCHITECT OF RECORD
BLAIR + MUI DOWD
100 LAFAYETTE STREET, STE 604
NEW YORK NY 10013
TEL. 212.941.8825

MEP ENGINEERS
SMITH SECKMAN
2995 SIDCO DR.
NASHVILLE, TN 37204
TEL. 615.383.1113

STRUCTURAL ENGINEER
STRUCTURAL DESIGN
220 GREAT CIRCLE ROAD
NASHVILLE, TN 37228
TEL. 615.255.5537

CIVIL ENGINEER
BARGE
6606 CHARLOTTE PIKE, STE 210
NASHVILLE, TN 37209
TEL. 615.356.9911

SUSTAINABILITY CONSULTANT
HASTINGS
225 POLK AVE STE 100
NASHVILLE, TN 37203
TEL. 615.329.1399

CODE CONSULTANT
JENSEN HUGHES
3610 COMMERCE DRIVE, STE 817
BALTIMORE, MD 21227
TEL. 410.737.8677

Structural Design Group
220 Great Circle Road, Suite 100
Nashville, Tennessee 37228
P. 615.255.5537
F. 615.255.1486
SDG Project No. 2021-061.00

ARCHITECT / ENGINEERING STAMPS

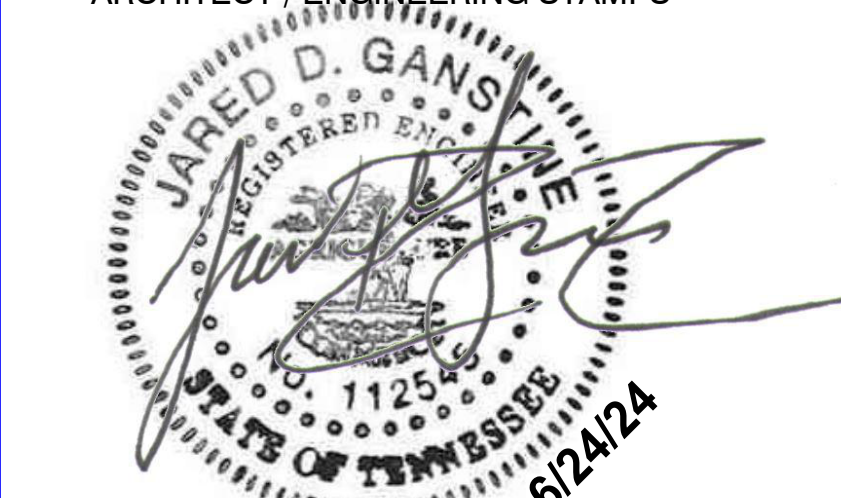

REVISIONS

No.	Date	Description
06	12/14/2023	CORESHELL - REVISION 06
09	06/24/2024	CORESHELL - REVISION 09

PROJECT ISSUANCES

Date	Description
11/12/2021	SCHEMATIC DESIGN
05/24/2022	ERP #1 - DEMOLITION & UTILITIES
07/22/2022	ERP #2 - EXCAVATIONS
08/05/2022	DESIGN DEVELOPMENT
11/16/2022	50% CONSTRUCTION DOCUMENTS
12/07/2022	ERP #3 - FOUNDATIONS
02/10/2023	100% CONSTRUCTION DOCUMENTS

LOCATION PLAN

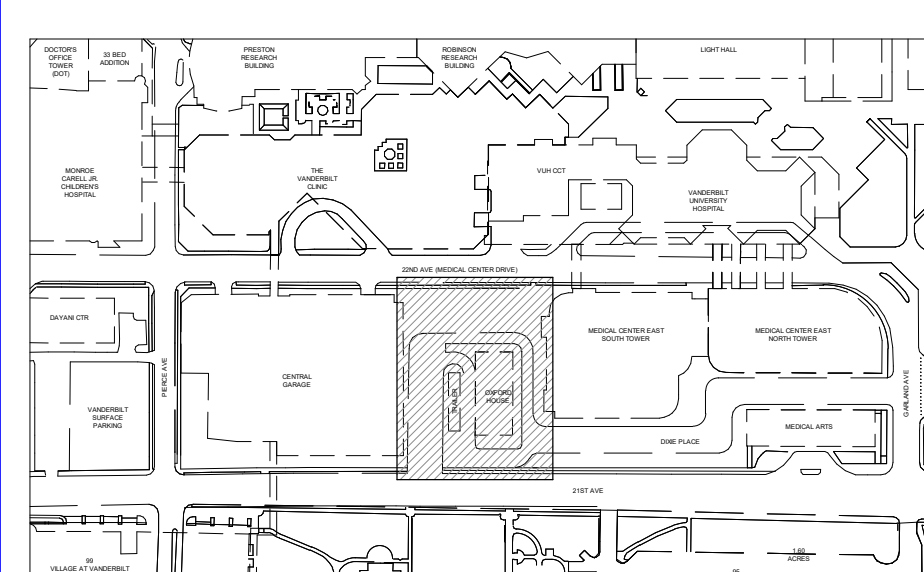

CONSTRUCTION DOCUMENTS



DRAWING TITLE

FOUNDATION SECTIONS AND DETAILS

DATE: 12/14/23

SHEET NO:

SCALE: 3/4" = 1'-0"

S3.48

BMD NO: 9091-1

21ST AVE SIDEWALK

NOTES:
1. SEE S3.00 FOR ADDITIONAL INFORMATION.
2. AT PIPE PENETRATIONS THRU WALL- ADD ADDITIONAL VERTICAL AND HORZ. REINFORCEMENT ON EITHER SIDE OF PENETRATION EQUAL TO THE INTERRUPTED REINFORCEMENT.

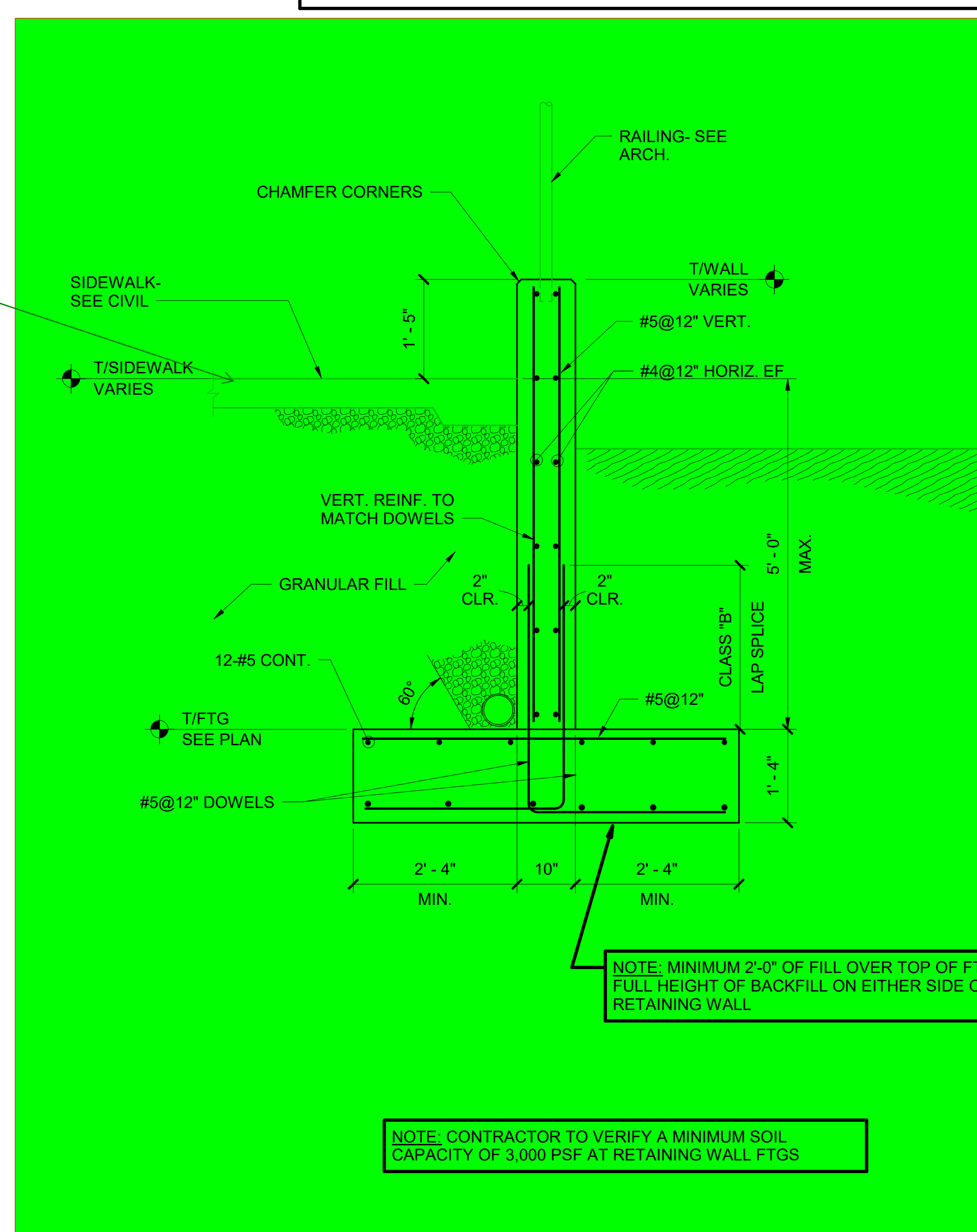

2 SECTION AT RETAINING WALL (21ST AVE.)

21ST AVE SIDEWALK

NOTES:
1. SEE S3.00 FOR ADDITIONAL INFORMATION.
2. AT PIPE PENETRATIONS THRU WALL- ADD ADDITIONAL VERTICAL AND HORZ. REINFORCEMENT ON EITHER SIDE OF PENETRATION EQUAL TO THE INTERRUPTED REINFORCEMENT.

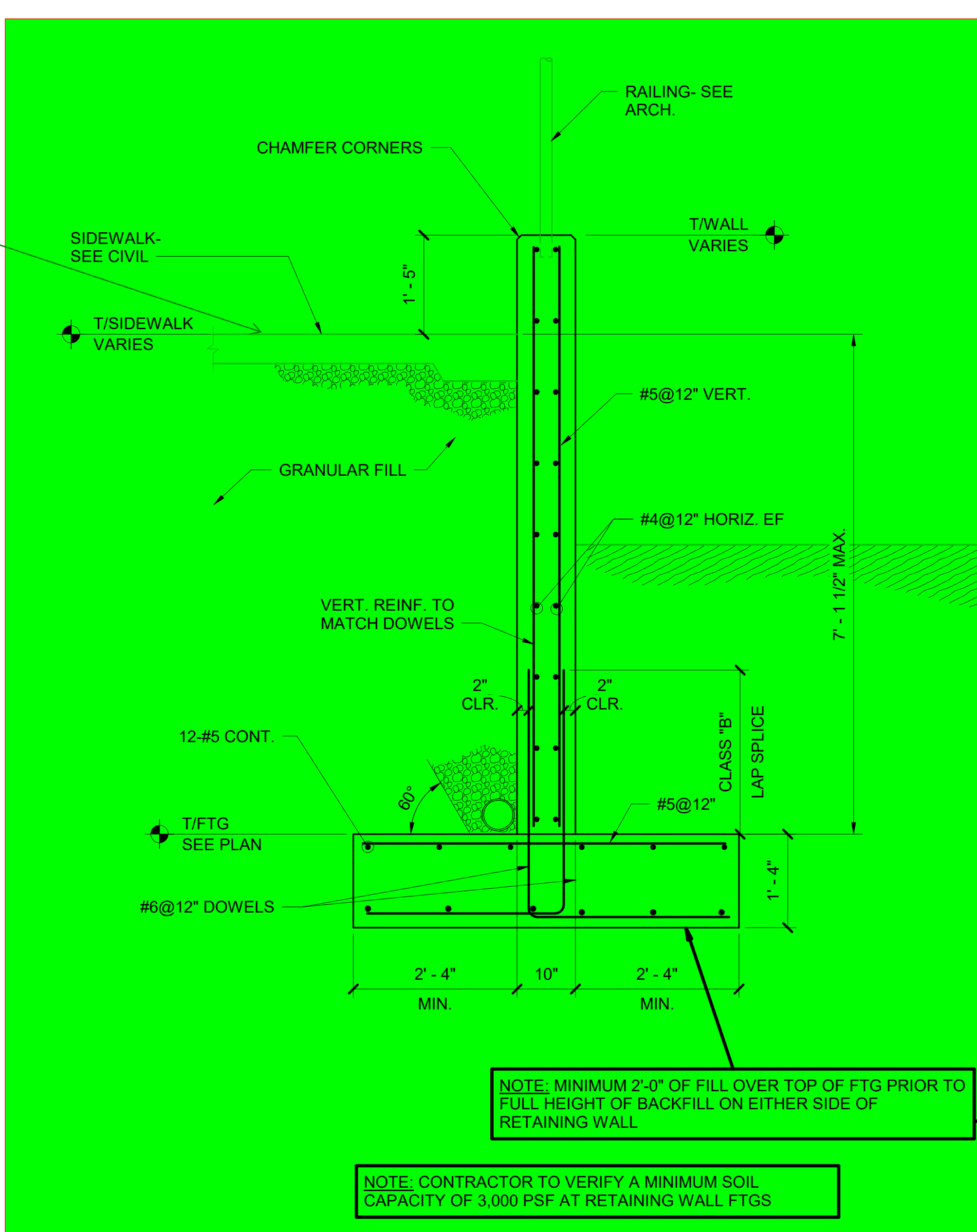

1 SECTION AT RETAINING WALL (21ST AVE.)

NOTE:
EXISTING REINF. TO BE FIELD LOCATED PRIOR TO DRILLING. EXISTING REINF. NOT TO BE CUT OR DAMAGED

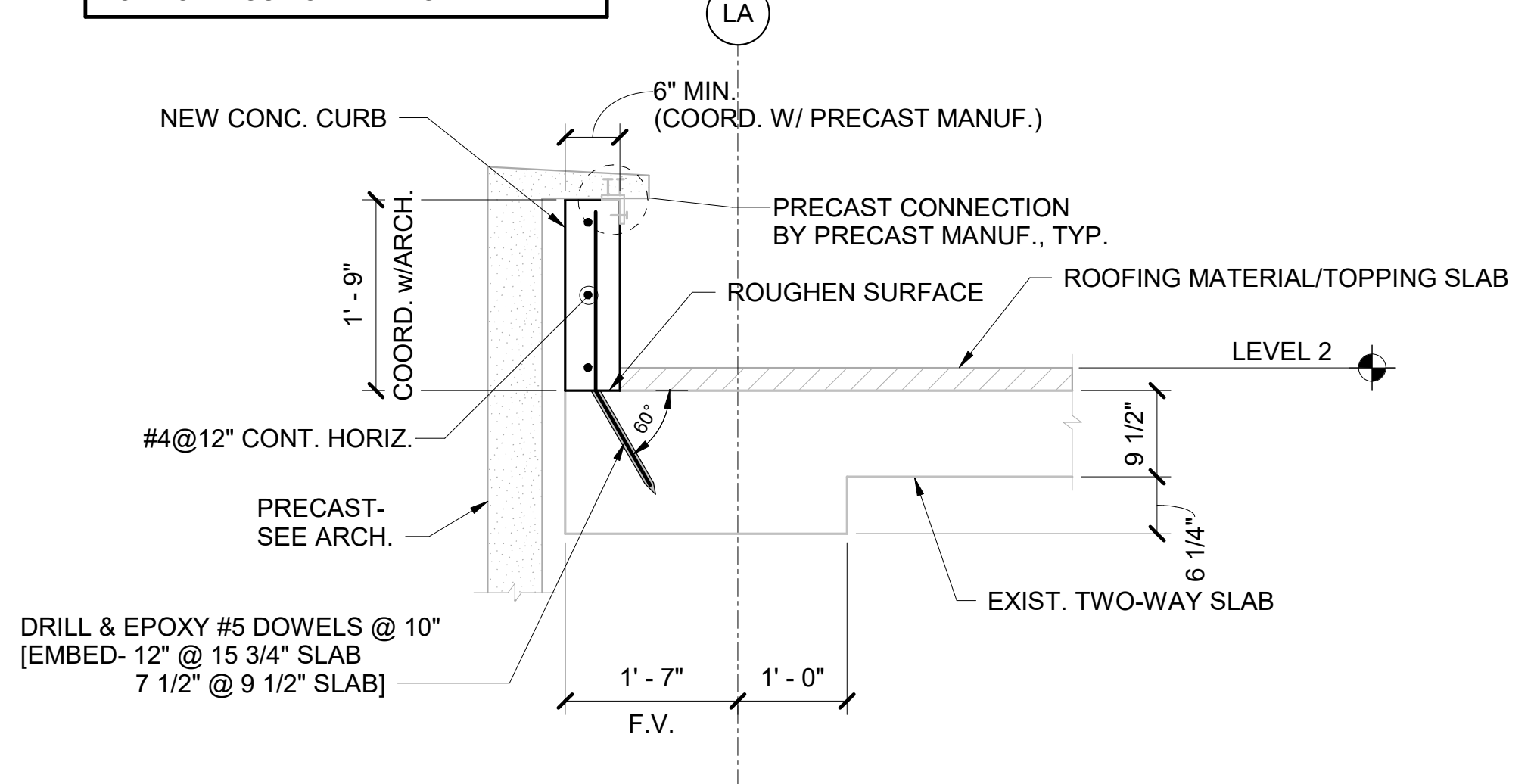

3 SECTION AT EXISTING GARAGE