

MULTIMODAL ACCESS CLOSURE EXCEPTION APPLICATION FORM AND CHECKLIST

Submittal Date: 11/07/2024 New Submittal Re-Submittal No: _____

Related Building Permit No: _____

Project Name: Printers Alley Parking Garage Emergency Repairs

Street Name Location: 300 Church St Nashville, TN 37201

Between: Church And: Union

Applicant Name: Holt Construction Group

Address: 7212 Methodist Church Rd, Lyles, TN 37098

Phone: 615-905-9140 Fax: _____ Contact: Billie Field

Email: billie@holtconstructiongroup.com

Project Description: Emergency overhead protection to contain falling debris.

Start Date: ASAP End Date: 1/31/2025 Project Length: _____

Describe Type of Closure: We are working on a plan to fix the issues and once that has been determined, we will have Comprehensive Security provide a plan of action. The area will remain open for businesses and the public.

Provide Reasons why Project cannot be completed without closures and what other options were considered (attach documents as needed): _____

PROJECT INFORMATION CHECKLIST:

Included Not Applicable

- | | | |
|-------------------------------------|-------------------------------------|--|
| <input checked="" type="checkbox"/> | <input type="checkbox"/> | Project Vicinity Map with Project Area shown, street names, property information, existing pavement and striping, gutter and building locations, north arrow, and scale. |
| <input type="checkbox"/> | <input checked="" type="checkbox"/> | Planned work hours included. |
| <input checked="" type="checkbox"/> | <input type="checkbox"/> | Exact location and dimensions of the construction work zone shown. |
| <input type="checkbox"/> | <input checked="" type="checkbox"/> | If multiple phases are necessary, include perimeter impact of each phase, phase number, anticipated work hours and phase duration. |
| <input type="checkbox"/> | <input checked="" type="checkbox"/> | Details on construction activity and equipment being used as part of construction included for each phase. |
| <input type="checkbox"/> | <input checked="" type="checkbox"/> | Specify if any on-street parking, and/or metered parking, is to be restricted and if bus zone will need to be relocated. |
| <input type="checkbox"/> | <input checked="" type="checkbox"/> | Specify if trash pickup will be impacted. |
| <input type="checkbox"/> | <input checked="" type="checkbox"/> | Provide information on all utility work and utility connections. |
| <input type="checkbox"/> | <input checked="" type="checkbox"/> | List all affected residents, businesses, agencies, and schools and any conversations/ agreements taken place. |
| <input type="checkbox"/> | <input checked="" type="checkbox"/> | Show ongoing construction projects within vicinity of proposed project impact. |
| <input type="checkbox"/> | <input checked="" type="checkbox"/> | Provide plan to address conflicts with other nearby projects. |
| <input type="checkbox"/> | <input checked="" type="checkbox"/> | Provide traffic control plan for each phase of construction (see traffic control checklist for more information). |
| <input type="checkbox"/> | <input checked="" type="checkbox"/> | Provide information on work vehicle parking locations. |
| <input type="checkbox"/> | <input checked="" type="checkbox"/> | Show construction trucks ingress/ egress to project location. |
| <input type="checkbox"/> | <input checked="" type="checkbox"/> | Provide information on any traffic signals, traffic signal loops, and traffic signal cabinets in close proximity to project. |

TRAFFIC CONTROL PLAN CHECKLIST:

Included Not Applicable

- All temporary traffic control plans shall be designed in accordance with the most recent ADA regulations and requirements of the Manual of Uniform Traffic Control Devices.
- Clearly show the locations of all existing signs (including speed limit) as well as the proposed signs for each construction phase.
- Show the location of all existing pedestrian paths and pedestrian detour route of each stage of construction.
- Show dimensions of travel lane width, shoulder width, sidewalk of each phase, and overall roadway width along the length of affected area.
- Show all existing striping and markings to remain, to be removed, and all proposed striping and markings for each construction stage.
- Provide detour plan clearly showing detour route for any roadway or pedestrian/bike path closures.
- Specify placement of all temporary traffic control devices.
- Specify spacing of all temporary traffic control devices.
- Show all existing traffic signals and streetlights in the work zone location.
- Lighting provided for all pedestrian detour routes.
- Provide minimum eleven (11) foot travel lanes at all times.
- Show size, height, and location of all channelizing devices, warning lights, flag trees, barriers, etc.
- Label all taper lengths and widths.
- Provide locations of police officers for each phase as needed.
- Temporary Traffic Control Plan has been stamped and signed by a TN licensed Civil Engineer.





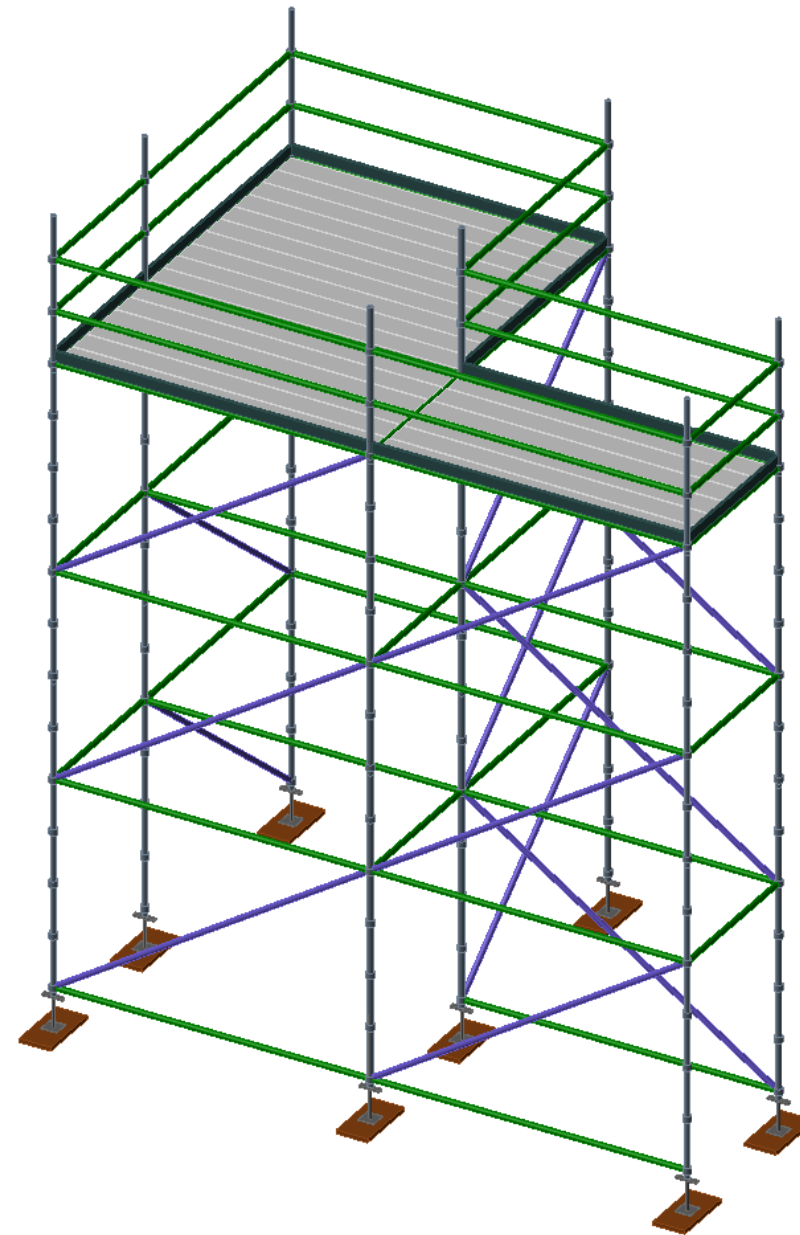
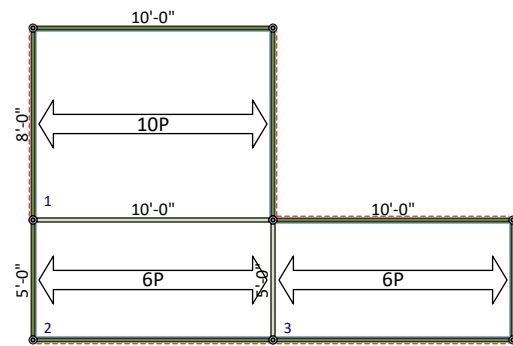

	PCI	
	PRINTERS ALLEY OHP	
By: PCI	PRINTERS ALLEY	
Nov 6, 2024	HOLT CONSTRUCTION	
Scale: 1/8" = 1'	Drawing No.: A1.1	Sheet: 1 of 1



WEST STREET
PUB

ker
235
9400

English Pub
Google

DADDY'S
WASH TERR
DOGS

NEW YORK
BREADS
PASTRIES
SANDWICHES
PIZZAS
CASSEROLES
DESSERTS
BEVERAGES
SALADS
SOUPS
DIPLOMAS
SPECIALS